

APPENDIX III

The following site data forms are designated as "prospective site; not sampled." The sites described herein are depicted on the county materials map as a "●".

LEGEND



This symbol on the site data form represents a prospective site.

MATERIAL SURVEY REPORT

Site No. SG+100  
Qkg1  
 Material Sand and Gravel  
 Location SW<sub>1</sub> NW<sub>1</sub> Sec. 17 Twp. 5S Range 8E  
 Owner Barbara Horalek c/o Evelyn Hannon 320 Garling House Bldg. Topeka  
 Name Barbara Horalek  
 Nature of Deposit Dry Accessibility Good  
 Status of Site Prospective site; not sampled

EXPLORATION DATA

Test Hole	Material at bottom of Hole	Depth of over-burden	Depth of Material	Percent Retained							Wash 200	G.F.	L.L.	P.L.		
				1/2	3/4	3/8	1/2	3/16	3/32	1/16						

CORRELATION DATA

Geological Age Quaternary  
 Geological Source Grand Island Formation  
 Material Similar to \_\_\_\_\_  
 Specific Gravity (Sat.) \_\_\_\_\_ (Dry)  
 Los Angeles Wear \_\_\_\_\_  
 Absorption \_\_\_\_\_ Soundness \_\_\_\_\_  
 Wt. Cu.Ft. \_\_\_\_\_ Str. Ratio \_\_\_\_\_  
 Remarks \_\_\_\_\_

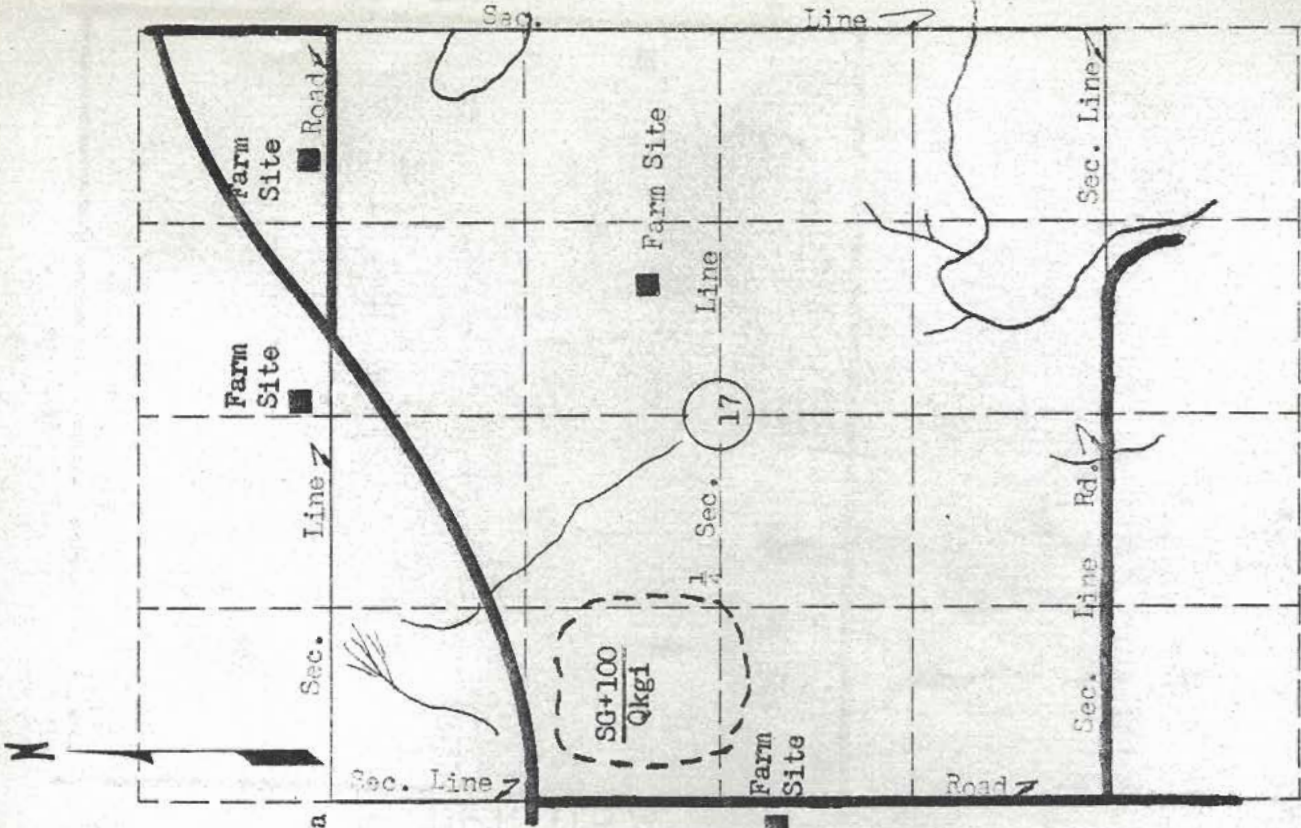

MATERIAL SURVEY REPORT

Site No. LS+101  
Pn  
 Material Limestone  
 Location NE 1/4 NE 1/4 Sec. 27 Twp. 4S Range 9E  
 Owner John H. Jones address Frankfort, Kansas  
 Nature of Deposit Dry Accessibility Good  
 Status of Site Prospective site; not sampled

EXPLORATION DATA

Test Hole	Material at bottom of hole	Depth of overburden	Depth of Material	Percent Retained					Mash 200	d.f.	L.L.	P.I.
				1 1/2	3/4	3/8	5	16				

CORRELATION DATA

Geological Age Permian  
 Geological Source Cottonwood and Neva Limestone Members  
 Material Similar To \_\_\_\_\_  
 Specific Gravity (Sat.) \_\_\_\_\_ (Dry)  
 Los Angeles Wear \_\_\_\_\_  
 Absorption \_\_\_\_\_ Soundness \_\_\_\_\_  
 Wt. Cu.Ft. \_\_\_\_\_ Str. Ratio \_\_\_\_\_  
 Remarks \_\_\_\_\_

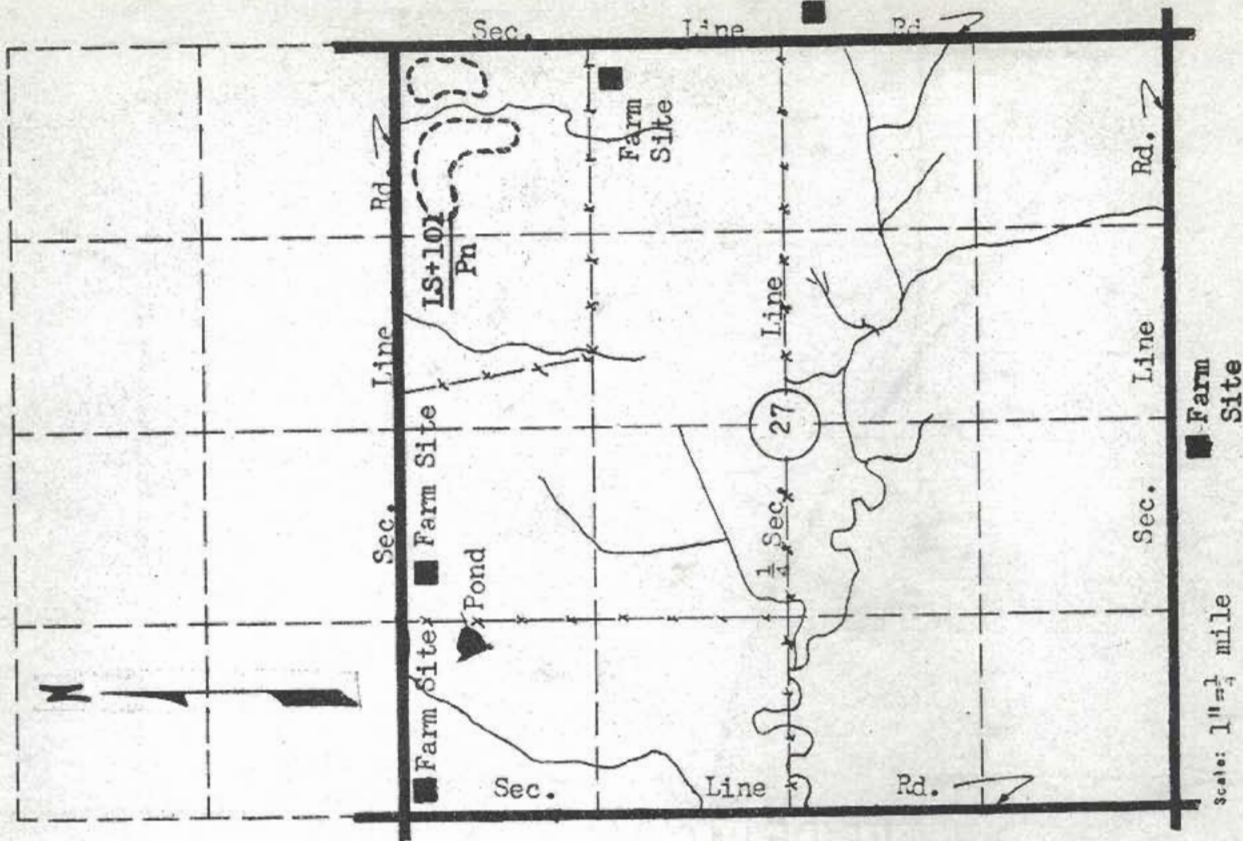

MATERIAL SURVEY REPORT

Site No. LS+102  
PMC  
 Date June, 1965  
 Material Limestone County Marshall  
 Location NE 1/4 NW 1/4 Sec. 6 Twp. 14S Range 9E  
 Owner Marion N. Tilley Frankfort, Kansas  
 name address  
 Nature of Deposit Dry Accessibility Good  
 Status of Site Prospective site; not sampled

EXPLORATION DATA

Test Hole	Material at Bottom of Hole	Depth of Material	Percent Retained					Wash 200	G.F.	L.L.	P.I.
			1 1/2	3/4	3/8	4	8				

CORRELATION DATA

Geological Age Permian  
 Geological Source Cottonwood Limestone Member  
 Material Similar To \_\_\_\_\_  
 Specific Gravity (Sat.) \_\_\_\_\_ (Dry) \_\_\_\_\_  
 Los Angeles Near \_\_\_\_\_  
 Absorption \_\_\_\_\_ Soundness \_\_\_\_\_  
 Wt. Cu.Ft. \_\_\_\_\_ Str. Ratio \_\_\_\_\_  
 Remarks \_\_\_\_\_

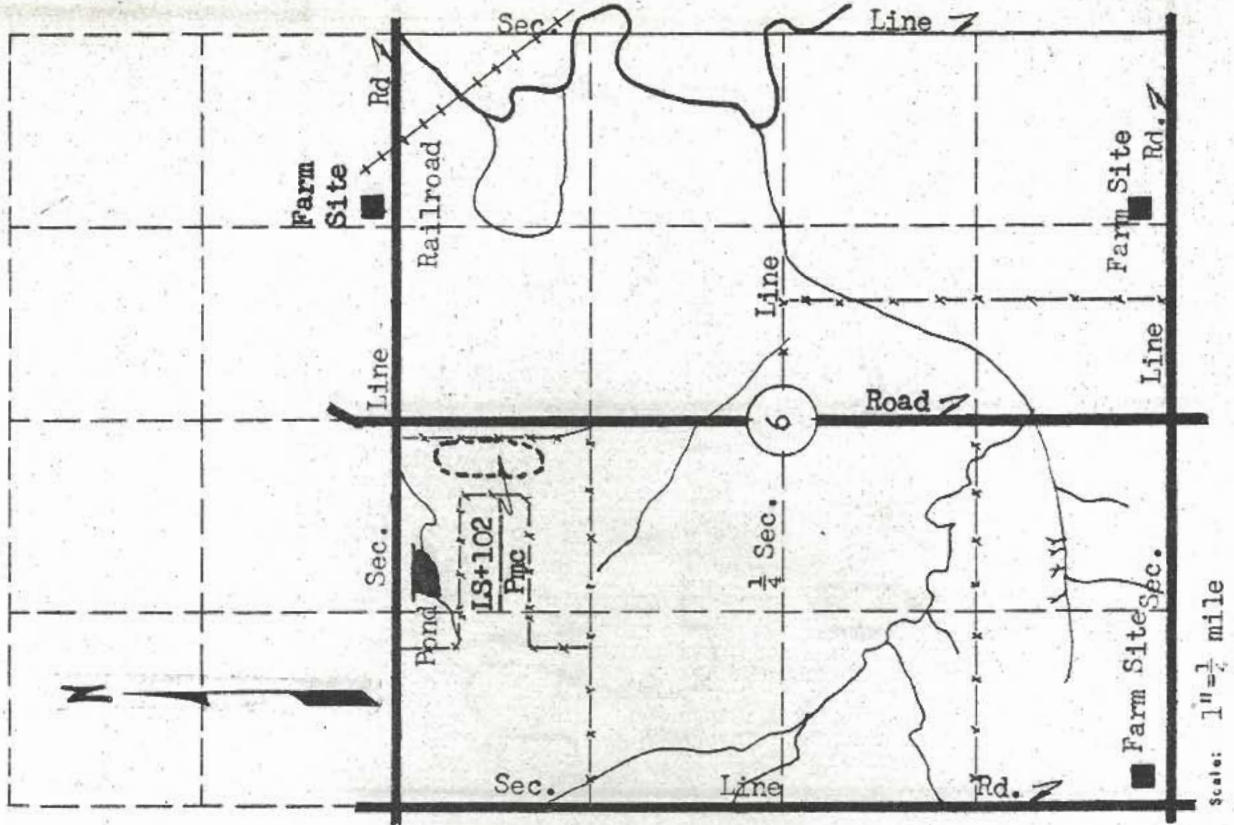

MATERIAL SURVEY REPORT

Site No. LS+103  
Pmc  
 Date June, 1965  
 Material Limestone County Marshall  
 Location SE 1/4 SW 1/4 Sec. 1 Twp. 5S Range 8E  
 Owner Lulu L. Reb Blue Rapids, Kansas  
 Name of Deposit Dry Accessibility Good  
 Status of Site Prospective site; not sampled

EXPLORATION DATA

Test Hole	Material at Bottom of Hole	Depth of over-Burden	Depth of Material	Percent Retained							Wash 200	G.F.	L.L.	P.I.			
				1 1/2	3/4	3/8	4	5	15	30					50	100	

CORRELATION DATA

Geological Age Permian  
 Geological Source Cottonwood Limestone Member  
 Material Similar to \_\_\_\_\_  
 Specific Gravity (Sat.) \_\_\_\_\_ (dry) \_\_\_\_\_  
 Los Angeles Near \_\_\_\_\_  
 Absorption \_\_\_\_\_ Soundness \_\_\_\_\_  
 Mt. Cu. Ft. \_\_\_\_\_ Str. Ratio \_\_\_\_\_  
 Remarks \_\_\_\_\_

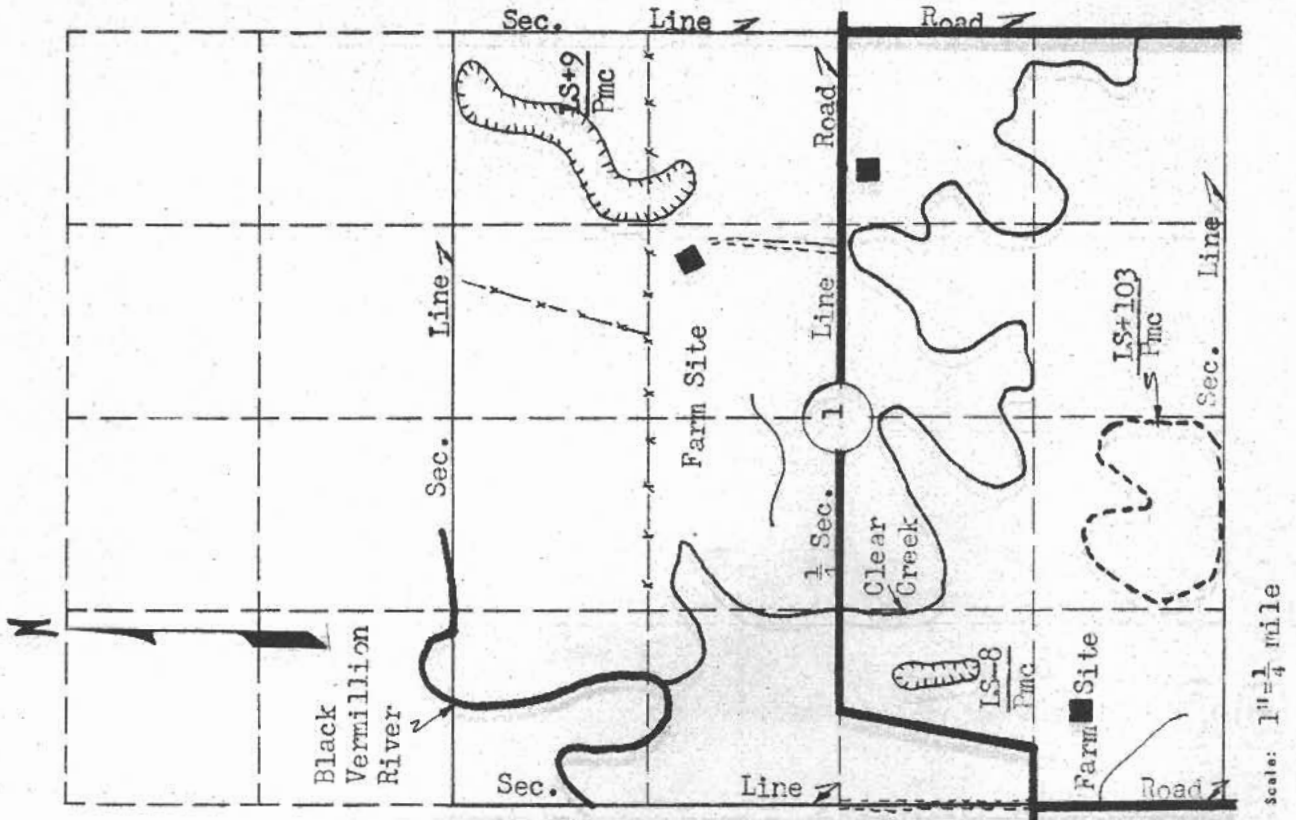

MATERIAL SURVEY REPORT

Site No. IS+104  
Pn  
 Material Limestone Date June, 1965  
 Location SE 1/4 NE 1/4 Sec. 20 Twp. 4S Range 9E  
Frankfort, Kansas  
 Owner William Martin address  
 Nature of Deposit Dry Accessibility Good  
 Status of Site Prospective site; not sampled

EXPLORATION DATA

Test Hole	Material at Bottom of Hole	Depth of overburden	Depth of Material	Percent Retained					Wash 200	G.F.	L.A. P.I.
				1 1/2	3/4	3/8	1/4	1/20			

CORRELATION DATA

Geological Age Permian  
 Geological Source Neva Limestone Member  
 Material Similar To \_\_\_\_\_  
 Specific Gravity (Sst.) \_\_\_\_\_ (Dry)  
 Los Angeles Wear \_\_\_\_\_  
 Absorption \_\_\_\_\_ Soundness \_\_\_\_\_  
 Mt. Cu.ft. \_\_\_\_\_ Str. Ratio \_\_\_\_\_  
 Remarks \_\_\_\_\_

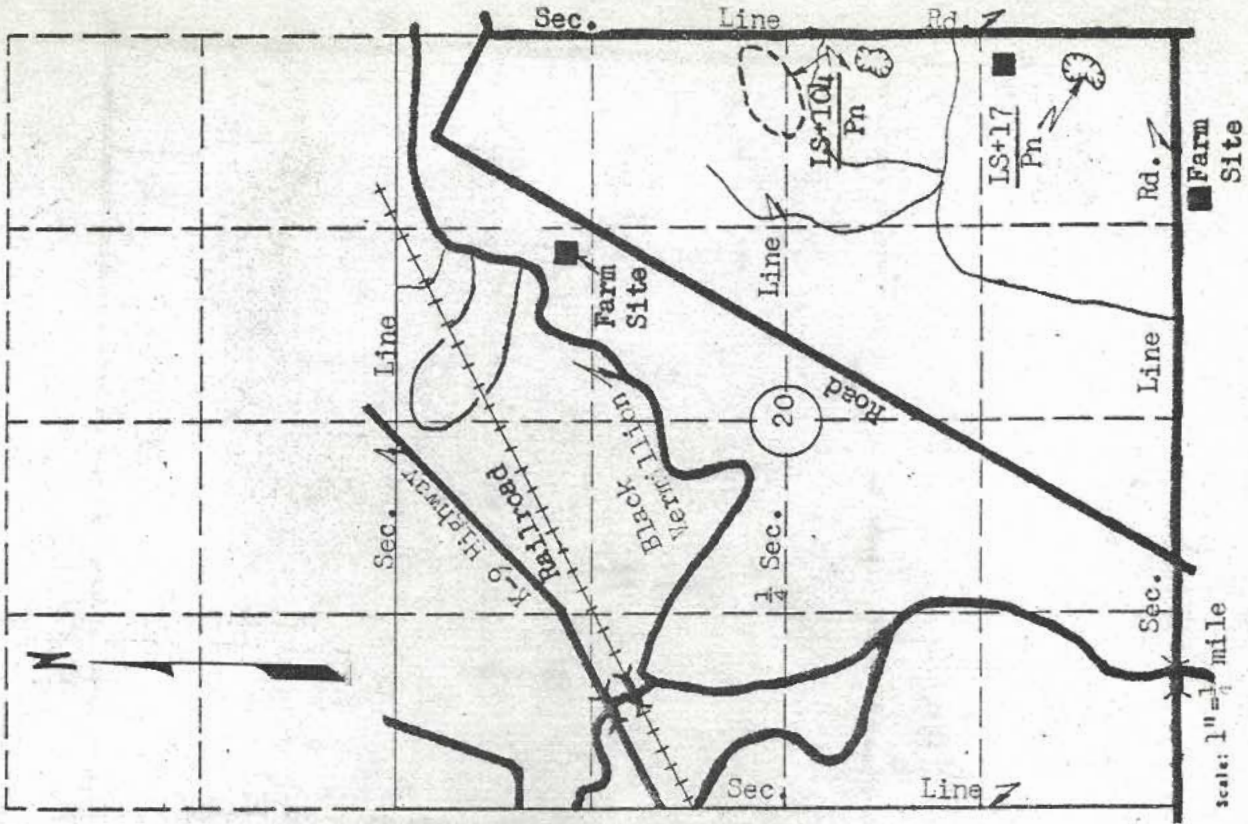

MATERIAL SURVEY REPORT

Site No. SG+105 Date June, 1965  
Qkt  
 Material Sand and Gravel County Marshall  
 Location SE $\frac{1}{4}$  SE $\frac{1}{4}$  Sec. 14 Twp. 1S Range 10E  
 Owner L. T. Lewis c/o Farmer National Company 170 $\frac{1}{2}$  Douglas St.  
 address Omaha Nebraska  
 Nature of Deposit Dry Accessibility Fair  
 Status of Site Prospective site; not sampled

EXPLORATION DATA

Test Hole	Material at Bottom of Hole	Depth of overburden	Depth of Material	Percent Retained							Wash	Q.F.	L.L.	P.I.						
				1 1/2	3/4	3/8	4	8	16	30					50	100	200			

CORRELATION DATA

Geological Age Quaternary  
 Geological Source Kansan Till  
 Material Similar to \_\_\_\_\_  
 Specific Gravity (Sat.) \_\_\_\_\_ (dry)  
 Los Angeles Year \_\_\_\_\_  
 Absorption \_\_\_\_\_ Soundness \_\_\_\_\_  
 Wt. Cu.ft. \_\_\_\_\_ Str. Ratio \_\_\_\_\_  
 Remarks \_\_\_\_\_

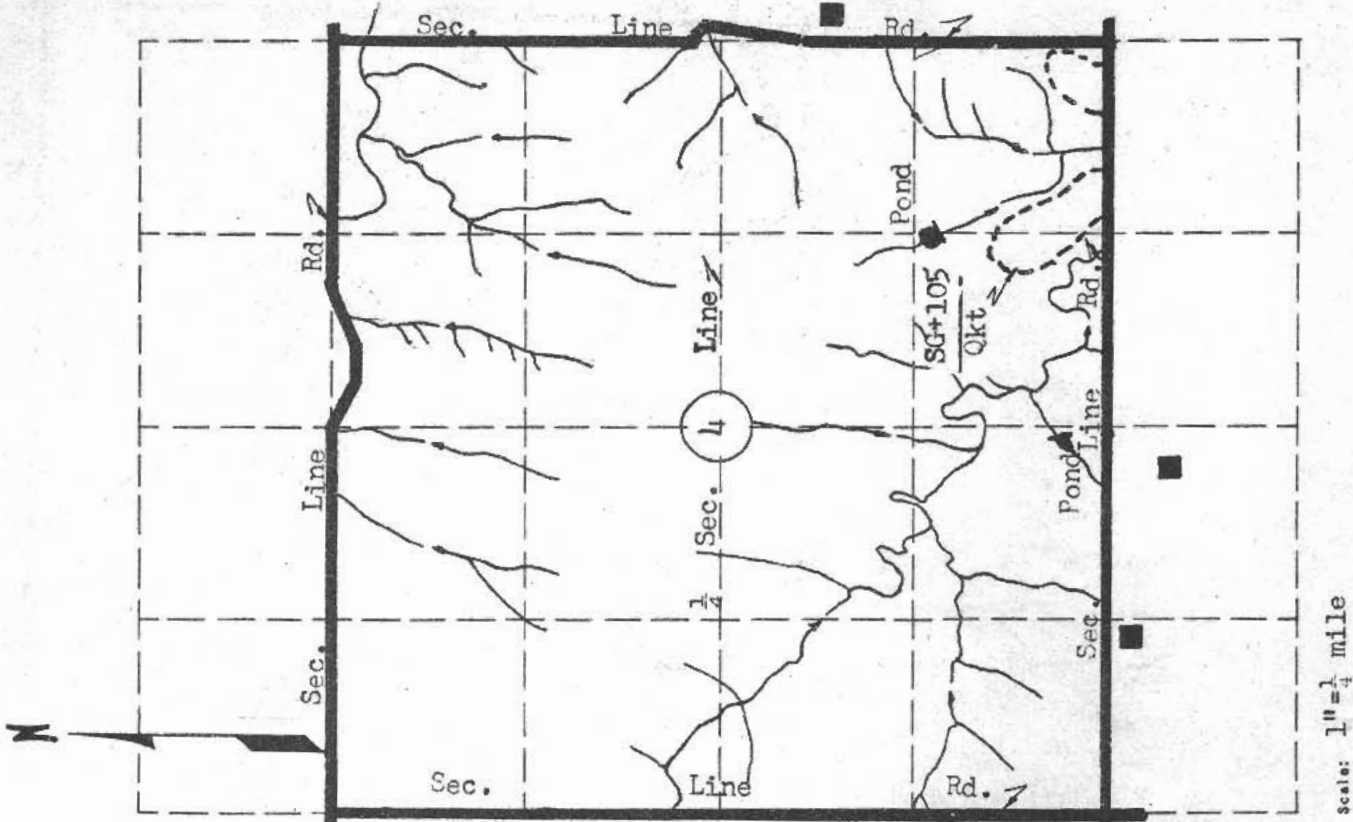

MATERIAL SURVEY REPORT

Site No. SG+106  
Qkt  
 Material Sand and Gravel  
 Location SW 1/4 Sec. 3 Twp. 1S Range 10E  
Le T. Lewis c/o Farmers National Company 1701 Douglas St.  
name address Omaha, Nebraska  
 Nature of Deposit Dry Accessibility Fair  
 Status of Site Prospective site; not sampled

EXPLORATION DATA

Test Hole	Material at Bottom of Hole	Depth of over-burden	Depth of Material	Percent Retained					Mean 200	G.F.	L.L.	P.I.
				1/2	3/4	2/3	4	8				

CORRELATION DATA

Geological Age Quaternary  
 Geological Source Kansan Till  
 Material Similar To \_\_\_\_\_  
 Specific Gravity (Set.) \_\_\_\_\_ (Dry)  
 Los Angeles Near \_\_\_\_\_  
 Absorption \_\_\_\_\_ Soundness \_\_\_\_\_  
 Wt. Cu.Ft. \_\_\_\_\_ Str. Ratio \_\_\_\_\_  
 Remarks \_\_\_\_\_

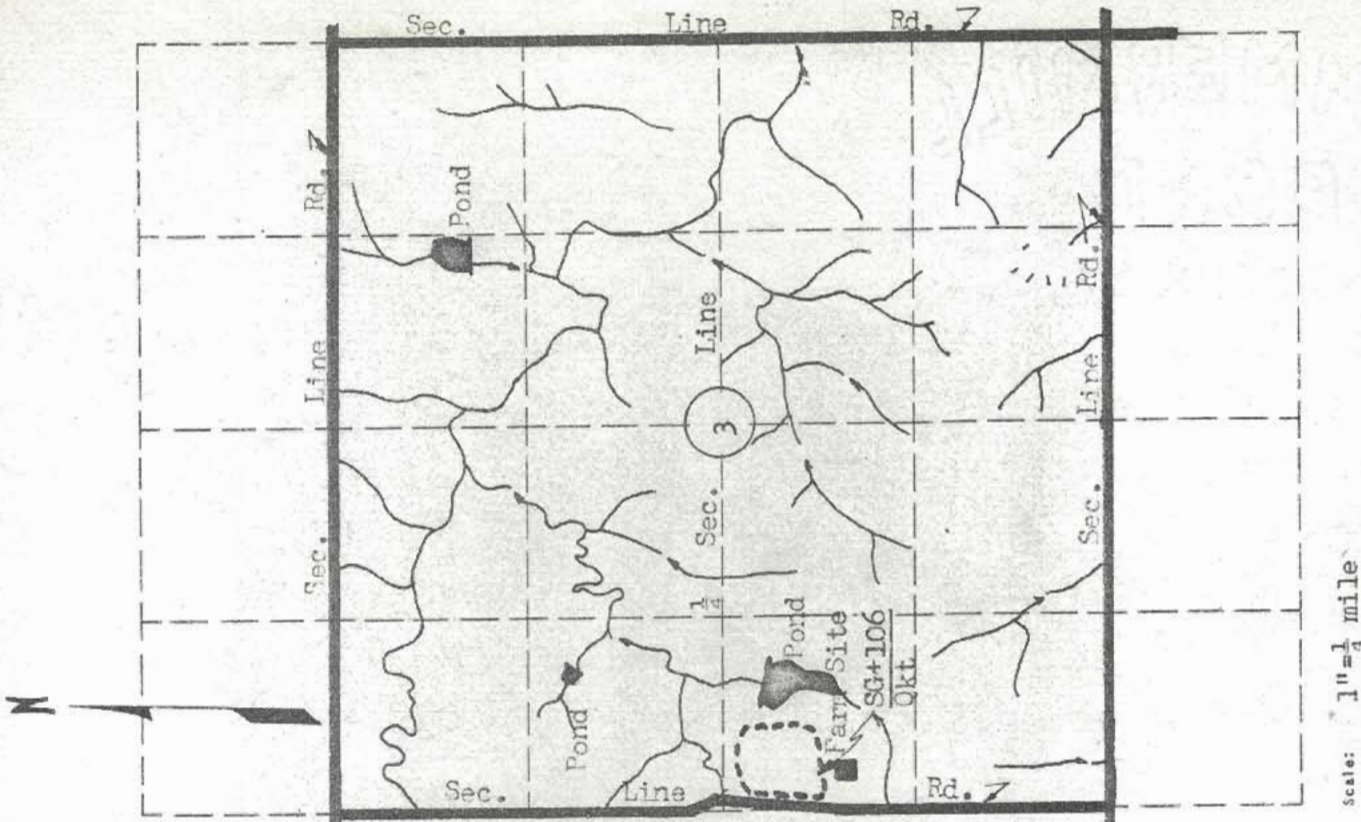



MATERIAL SURVEY REPORT

**SG+107**  
 Site No. Qkt Date June, 1965  
 Material Sand and Gravel County Marshall  
 Location NE  $\frac{1}{4}$  Sec. 15 Twp. 1S Range 10E  
 Owner Joseph W. and Nora Coughlin Sumner, Kansas  
 name address  
 Nature of Deposit Dry Accessibility Fair  
 Status of Site Prospective site; not sampled

EXPLORATION DATA

Test Hole	Material at Bottom of Hole	Depth of over-Burden	Depth of Material	Percent Retained					Wash 200	G.F.	L.L.	P.L.
				1 1/2	3/4	3/8	8	16				

CORRELATION DATA

Geological Age Quaternary  
 Geological Source Kansan Till  
 Material Similar To \_\_\_\_\_  
 Specific Gravity (Sat.) \_\_\_\_\_ (Dry)  
 Los Angeles Near \_\_\_\_\_  
 Absorption \_\_\_\_\_ Soundness \_\_\_\_\_  
 Wt. Cu.Ft. \_\_\_\_\_ Str. Ratio \_\_\_\_\_  
 Remarks \_\_\_\_\_

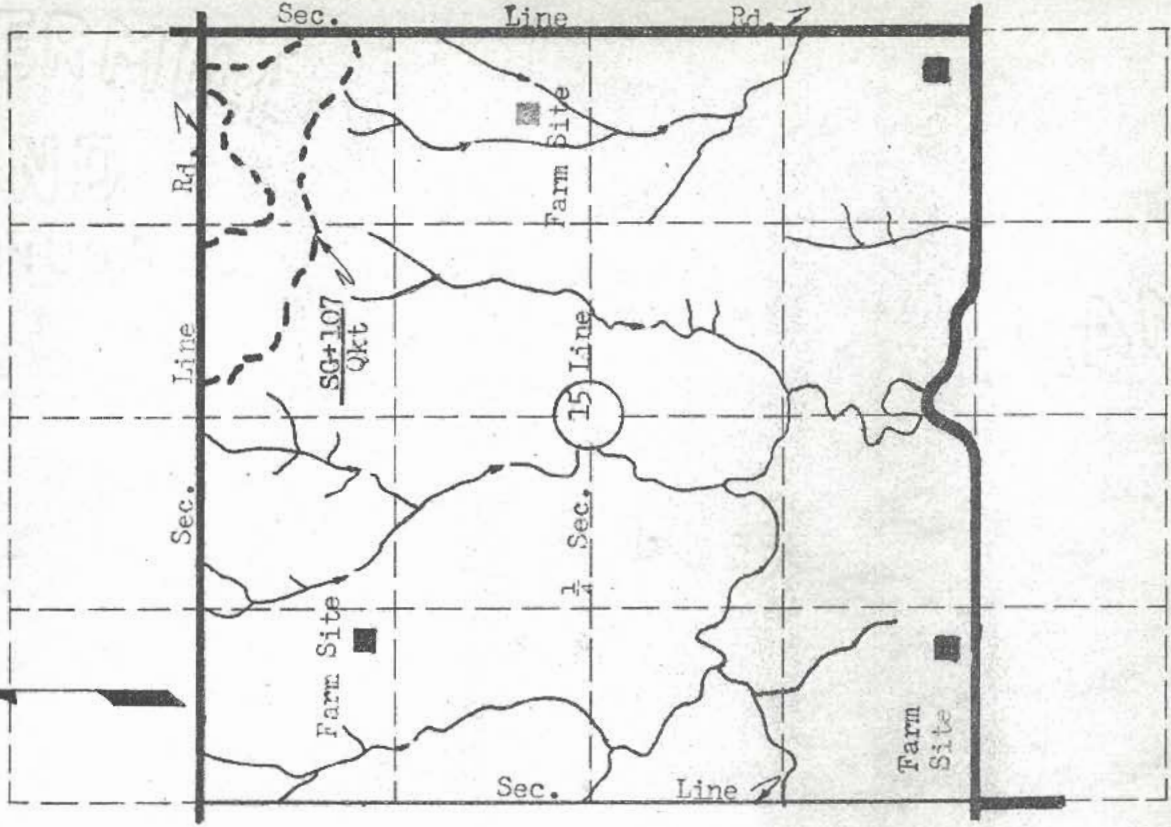

Scale: 1" = 1/4 mile

MATERIAL SURVEY REPORT

Site No. LS+108  
Psh  
 Date June, 1965  
 Material Limestone County Marshall  
 Location SE 1/4 Sec. 7 Twp. 5S Range 8E  
 Owner John Ingerly Blue Rapids, Kansas  
 address  
 Nature of Deposit Dry Accessibility Fair  
 Status of Site Prospective site; not sampled

EXPLORATION DATA

Test Hole	Material at Bottom of Hole	Depth of over-burden	Depth of Material	Percent Retained						Wash 200	G.F.	L.L.	P.I.					
				1 1/2	3/4	3/8	4	8	16					30	50	100		

CORRELATION DATA

Geological Age Permian  
 Geological Source "Havensville Reef" and Schroyer Limestone Member  
 Material Similar To \_\_\_\_\_  
 Specific Gravity (Sat.) \_\_\_\_\_ (Dry) \_\_\_\_\_  
 Los Angeles Wear \_\_\_\_\_  
 Absorption \_\_\_\_\_ Soundness \_\_\_\_\_  
 Wt. Cu.ft. \_\_\_\_\_ Str. Ratio \_\_\_\_\_  
 Remarks \_\_\_\_\_

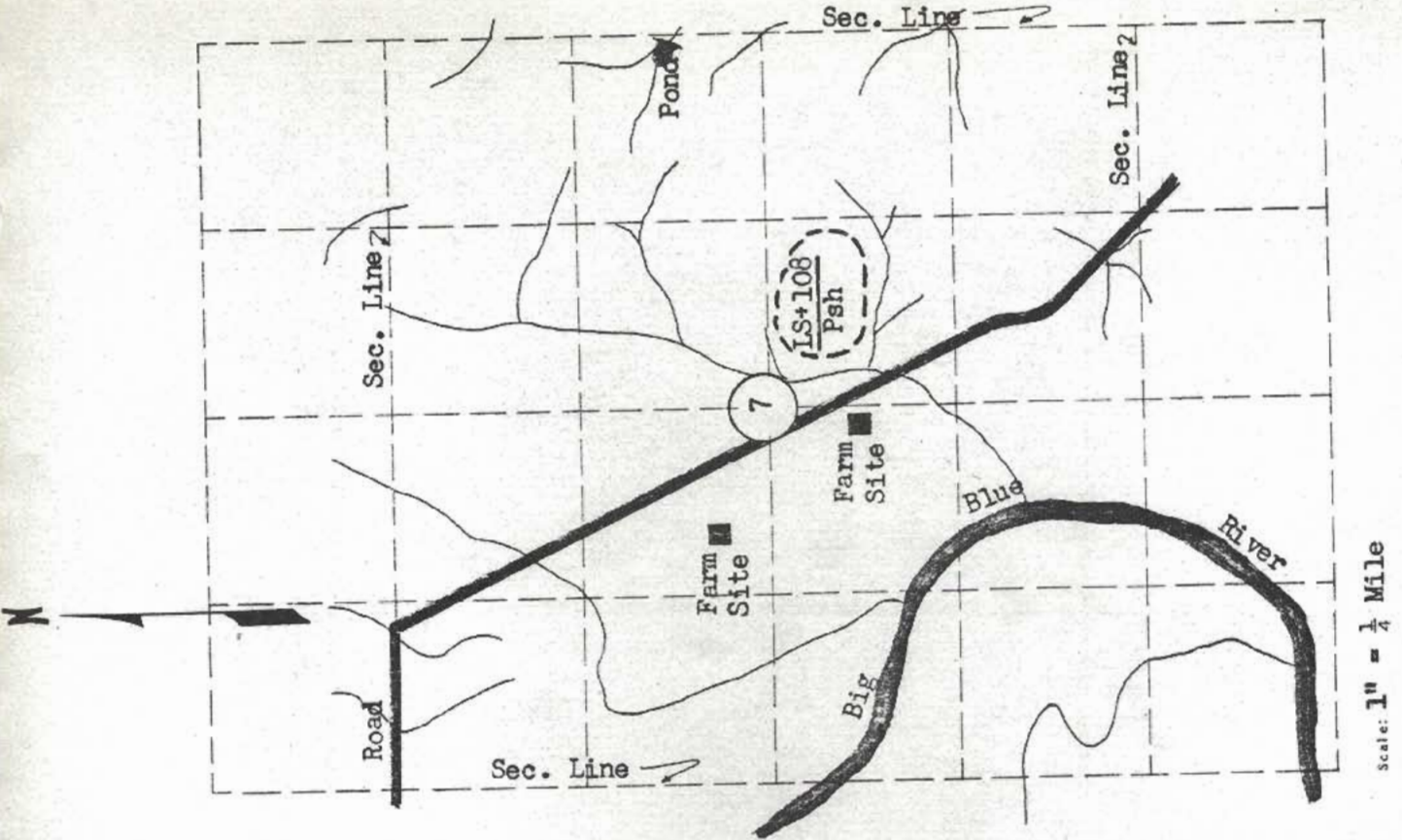

MATERIAL SURVEY REPORT

SG+109  
Qkt

Site No. \_\_\_\_\_ Date June, 1965  
 Material Sand and Gravel County Marshall  
 Location SE 1/4 Sec. 14 Twp. 1S Range 10E  
 Owner S. D. & Margaret Glynn Axtell, Kansas  
 address  
 Nature of Deposit Dry Accessibility Fair  
 Status of Site Prospective site; not sampled

EXPLORATION DATA

Test Hole	Material at Bottom of Hole	Depth of overburden	Depth of Material	Percent Retained							Wash 200	G.F.	L.L.	P.I.				
				1/2	3/4	3/8	4	8	16	30					50	100		

CORRELATION DATA

Geological Age Quaternary  
 Geological Source Kansan Till  
 Material Similar to \_\_\_\_\_  
 Specific Gravity (Sat.) \_\_\_\_\_ (Dry)  
 Los Angeles Wear \_\_\_\_\_  
 Absorption \_\_\_\_\_ Soundness \_\_\_\_\_  
 Mt. Cu. Ft. \_\_\_\_\_ Str. Ratio \_\_\_\_\_  
 Remarks \_\_\_\_\_

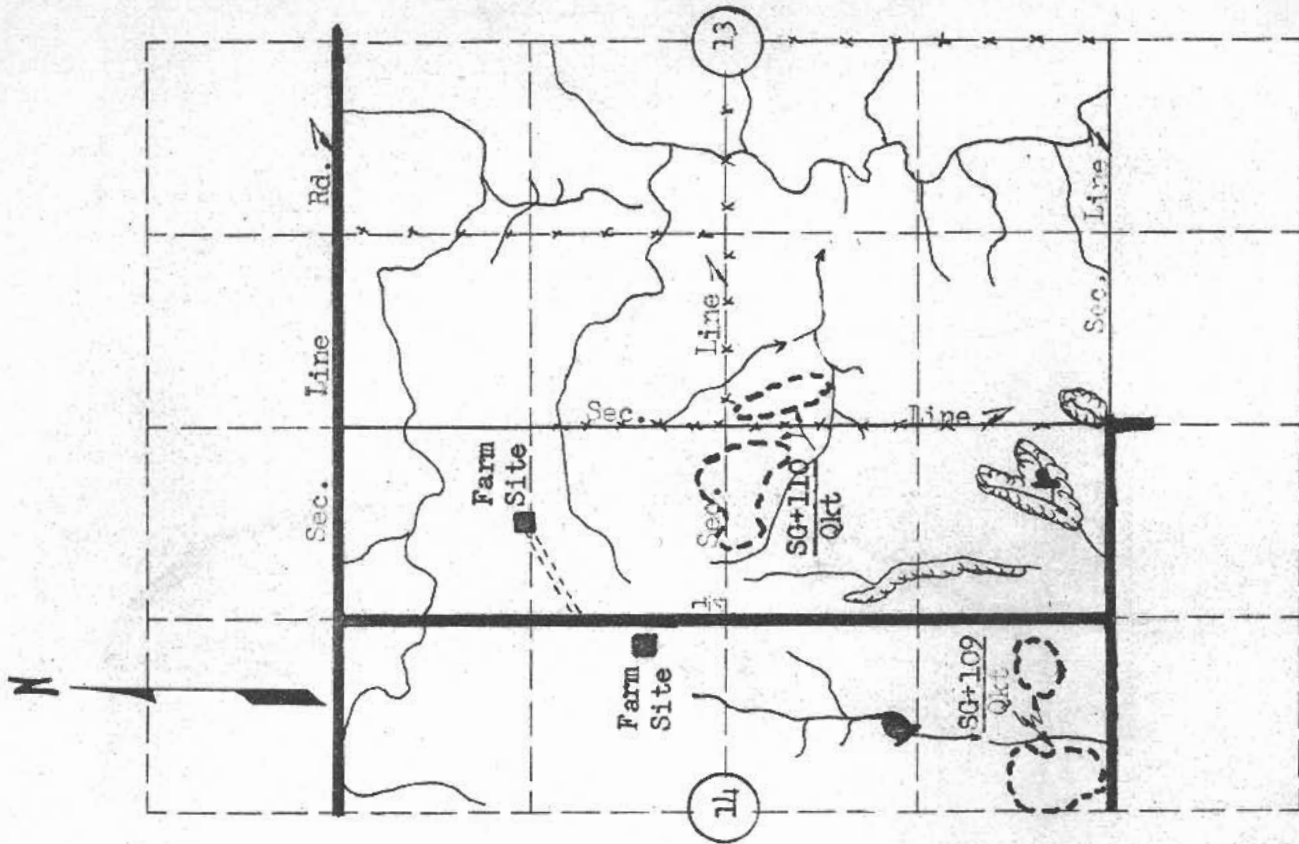

MATERIAL SURVEY REPORT

Site No. SG+110  
Qkt  
 Date June, 1965  
 Material Sand and Gravel County Marshall  
 Location NW 1/4 SW 1/4 Sec. 13 Twp. 1S Range 10E  
 Owner Clarence K. Brown Axtell, Kansas  
 address  
 Nature of Deposit Dry Accessibility Good  
 Status of Site Prospective site; not sampled

EXPLORATION DATA

Test Hole	Material at Bottom of Hole	Depth of over-burden	Depth of Material	Percent Retained						Mash 200	G.F.	L.L.	P.I.		
				1 1/2	3/4	3/8	4	8	16					30	50

CORRELATION DATA

Geological Age Quaternary  
 Geological Source Kansan T411  
 Material Similar To \_\_\_\_\_  
 Specific Gravity (sat.) \_\_\_\_\_ (Dry) \_\_\_\_\_  
 Los Angeles Wear \_\_\_\_\_  
 Absorption \_\_\_\_\_ Soundness \_\_\_\_\_  
 Wt. Cu.Ft. \_\_\_\_\_ Str. Ratio \_\_\_\_\_  
 Remarks \_\_\_\_\_

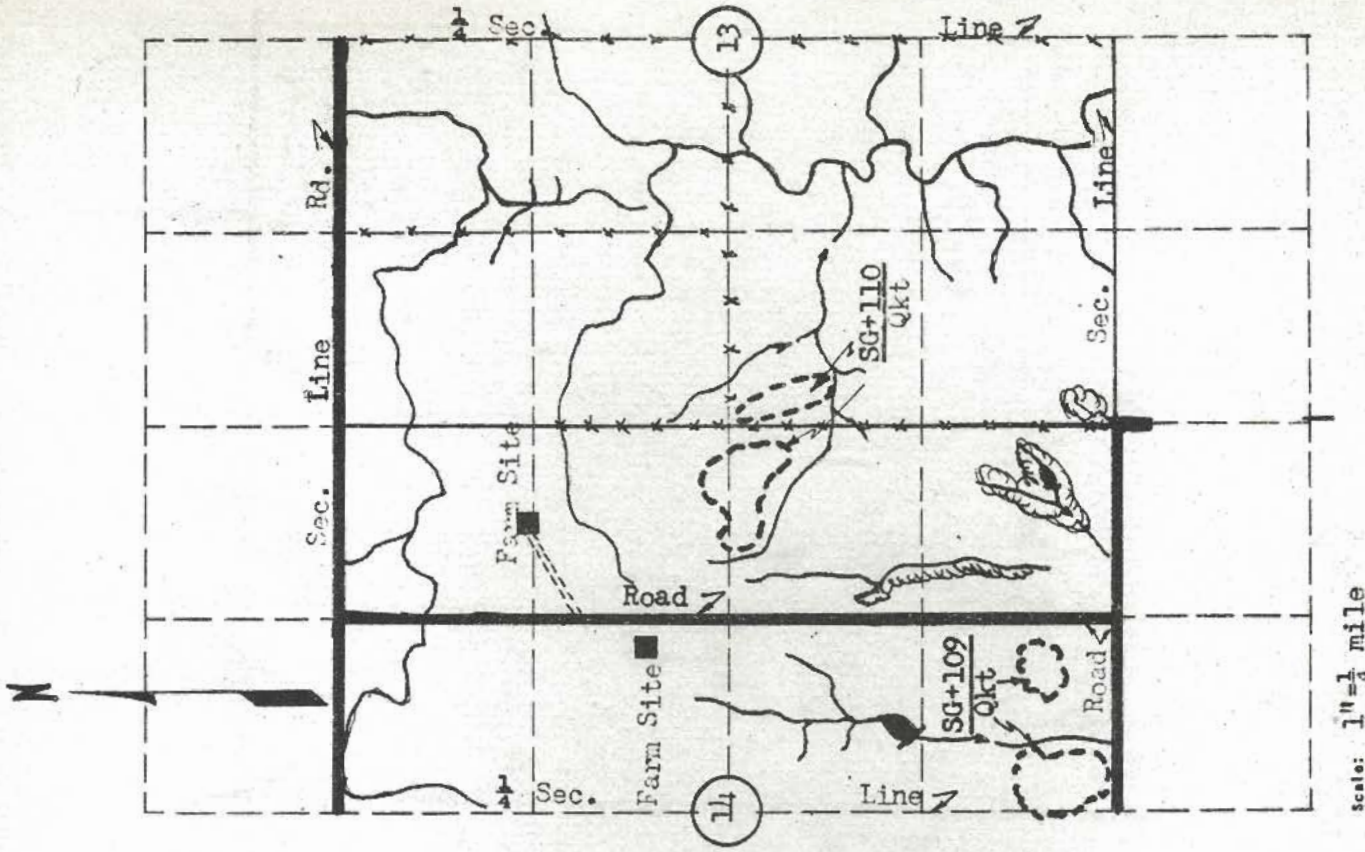

MATERIAL SURVEY REPORT

Site No. SG+111  
Qkt  
 Date June, 1965  
 Material Sand and Gravel County Marshall  
 Location SE 1/4 Sec. 11 Twp. 1S Range 10E  
 Owner Galen B. Runnbaum Axtell, Kansas  
 Nature of Deposit Dry Accessibility Good  
 Status of Site Prospective site; not sampled

EXPLORATION DATA

Test Hole	Material at bottom of hole	Depth of overburden	Depth of Material	Percent Retained						Wash	G.f.	L.L.	P.I.						
				1 1/2	3/4	3/8	5/8	15	30					50	100	200			

CORRELATION DATA

Geological Age Quaternary  
 Geological Source Kansan Till  
 Material Similar To \_\_\_\_\_  
 Specific Gravity (Sat.) \_\_\_\_\_ (Dry) \_\_\_\_\_  
 Los Angeles Wear \_\_\_\_\_  
 Absorption \_\_\_\_\_ Soundness \_\_\_\_\_  
 Wt. Cu.Ft. \_\_\_\_\_ Str. Ratio \_\_\_\_\_  
 Remarks \_\_\_\_\_

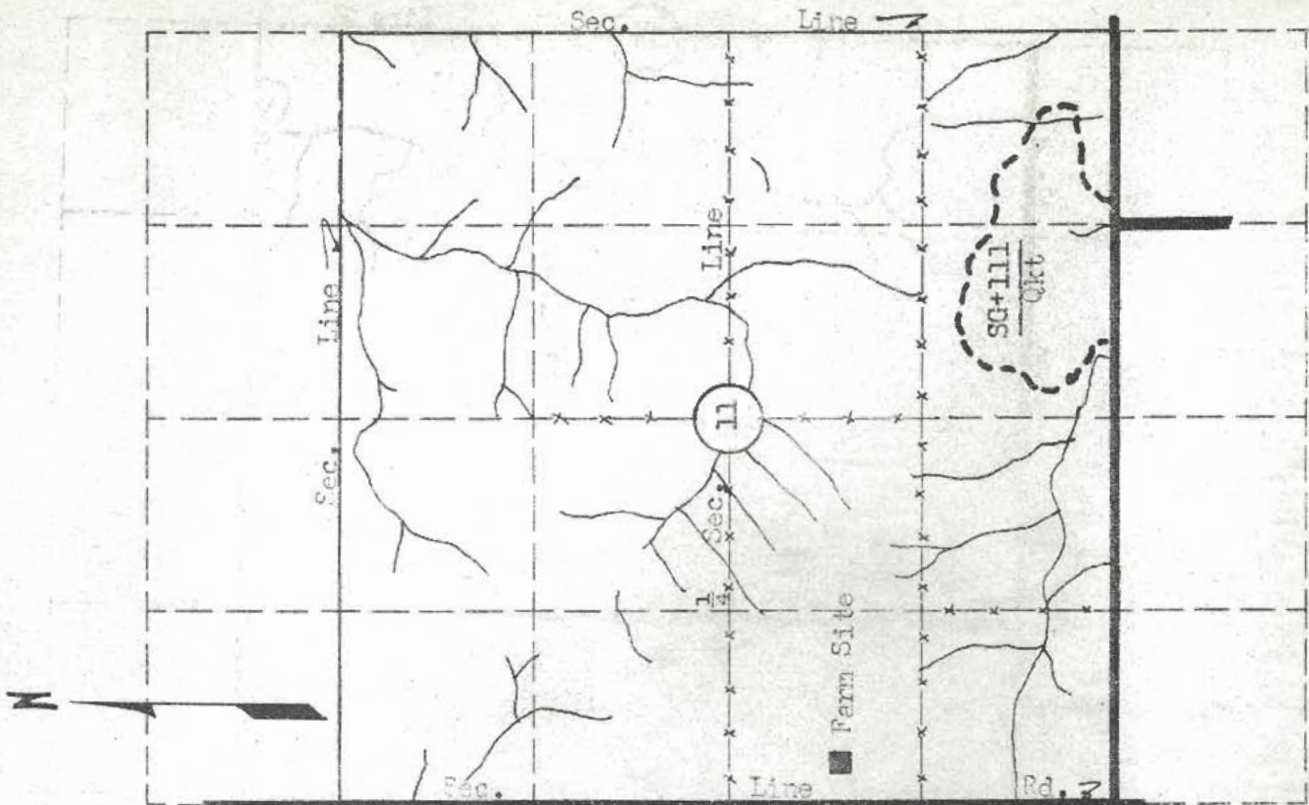

Scale: 1 inch = 1 mile

MATERIAL SURVEY REPORT

Site No. SG+112 Date June, 1965  
Qkt  
 Material Sand and Gravel County Marshall  
 Location S<sub>1</sub> Sec. 12 Twp. 1S Range 10E  
 Owner See Below name address  
 Nature of Deposit Dry Accessibility Fair  
 Status of Site Prospective site; not sampled

EXPLORATION DATA

Test Hole	Material at Bottom of Hole	Depth of Material	Percent Retained							Wash 200	G.F.	L.L.	P.I.
			1/2	3/4	1	1 1/4	1 1/2	2	3				

CORRELATION DATA

Geological Age Quaternary  
 Geological Source Kansan Till  
 Material Similar To \_\_\_\_\_  
 Specific Gravity (Sat.) \_\_\_\_\_ (Dry) \_\_\_\_\_  
 Los Angeles Wear \_\_\_\_\_  
 Absorption \_\_\_\_\_ Soundness \_\_\_\_\_  
 Mt. Cu.Ft. \_\_\_\_\_ Str. Ratio \_\_\_\_\_  
 Remarks W<sub>1</sub>, SW<sub>1</sub>, SW<sub>4</sub> James O'Toole Artell, Kansas  
N<sub>1</sub>, SE<sub>1</sub> & E<sub>1</sub>, SW<sub>4</sub> Mary Jane McGrath Marysville, Kansas

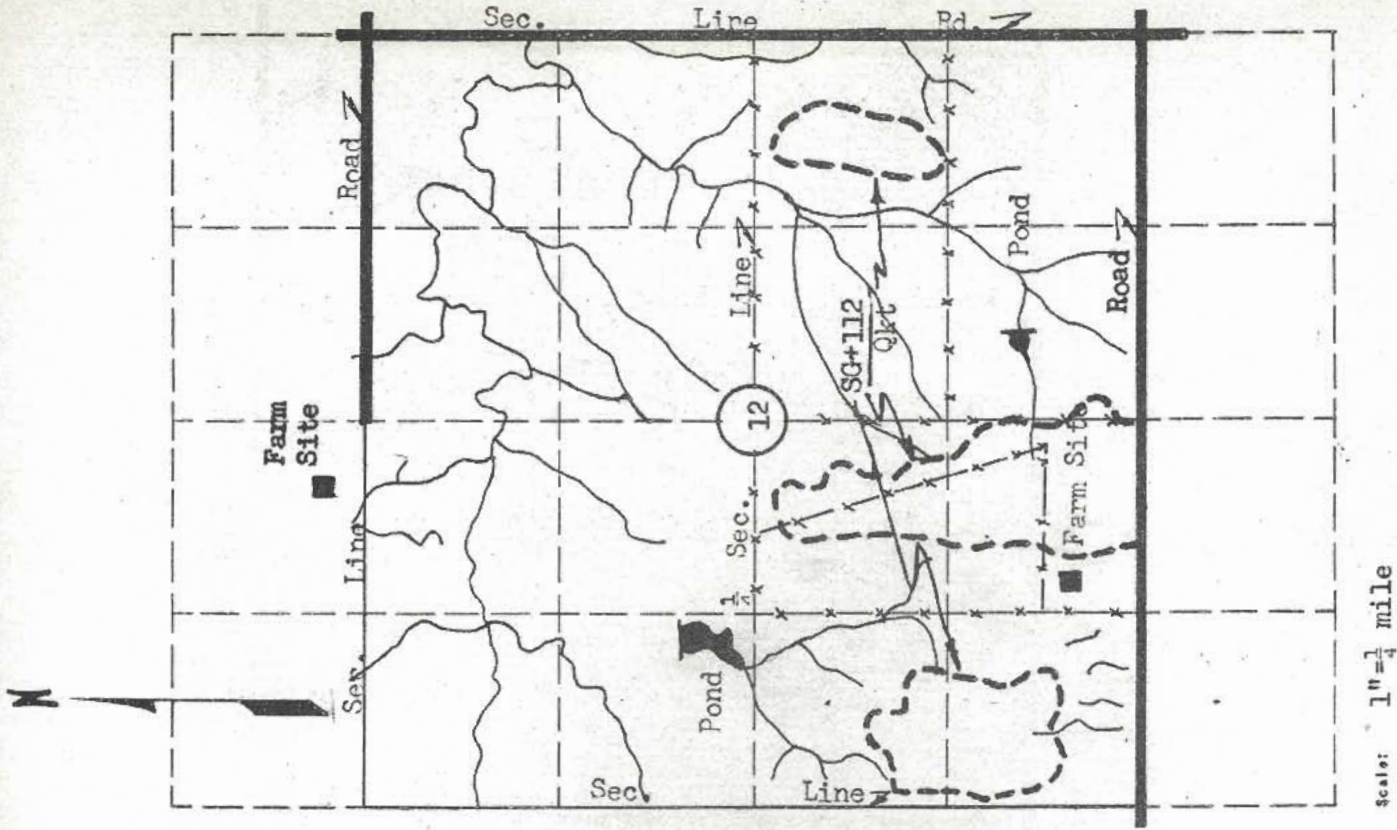

Scale: 1" = 1/4 mile

MATERIAL SURVEY REPORT

Site No. SG+113  
Qkt  
 Date June, 1965  
 Material Sand and Gravel County Marshall  
 Location NW 1/4 Sec. 1 Twp. 1S Range 10E  
 Owner Terrance J. Madden c/o John Madden 500 Board of Trade Bldg.  
 address Kansas City, Mo.  
 Nature of Deposit Dry Accessibility Fair  
 Status of Site Prospective site; not sampled

EXPLORATION DATA

Test Hole	Material at Bottom of Hole	Depth of over-burden	Depth of Material	Percent Retained							Wash 200	L.L.	P.I.		
				1 1/2	3/4	3/8	4	8	16	30				50	100

CORRELATION DATA

Geological Age Quaternary  
 Geological Source Kansas Till  
 Material Similar To \_\_\_\_\_  
 Specific Gravity (Sat.) \_\_\_\_\_ (Dry) \_\_\_\_\_  
 Los Angeles Wear \_\_\_\_\_  
 Absorption \_\_\_\_\_ Soundness \_\_\_\_\_  
 Wt. Cu.Ft. \_\_\_\_\_ Str. Ratio \_\_\_\_\_  
 Remarks \_\_\_\_\_

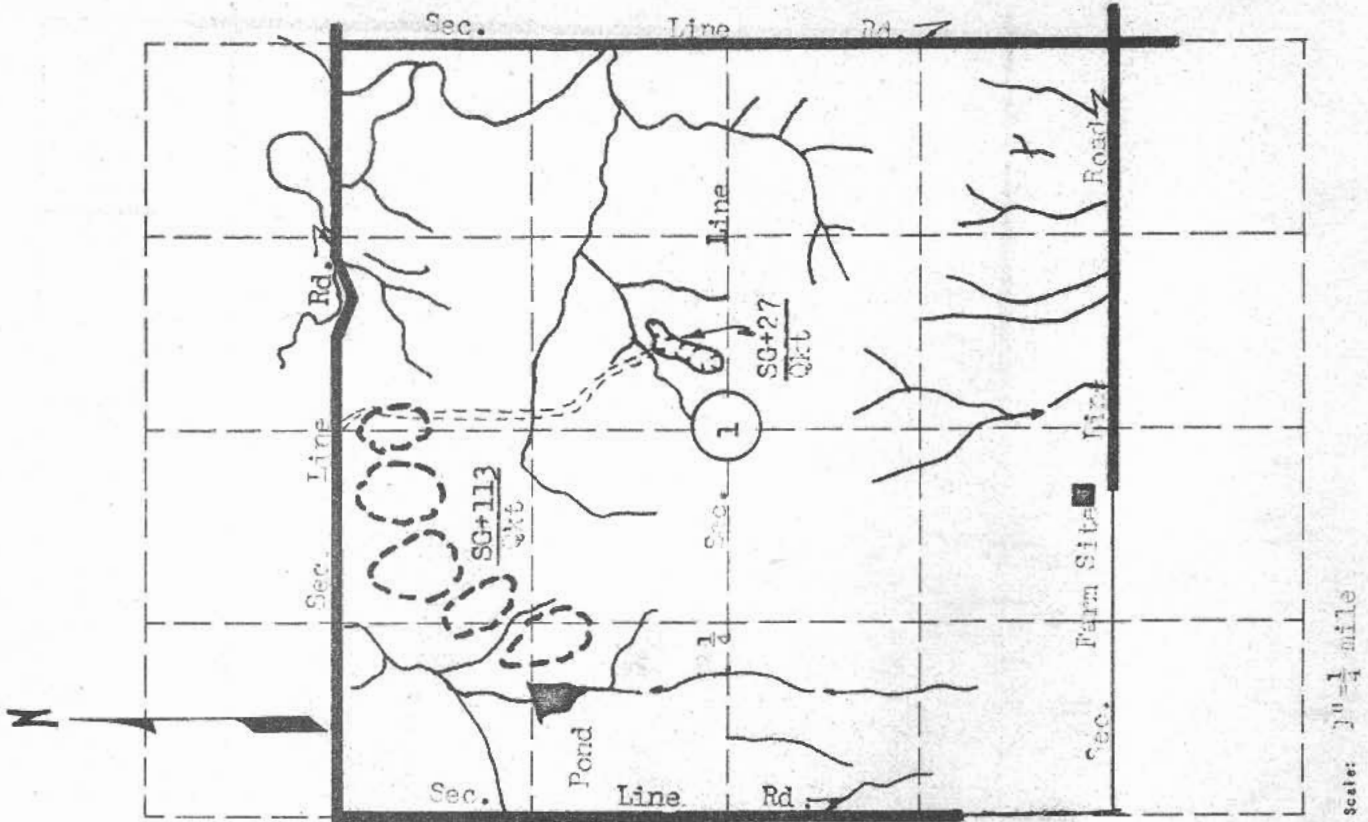

MATERIAL SURVEY REPORT

Site No. SG+114 Date June, 1965  
Okt  
 Material Sand and Gravel County Marshall  
 Location SE 1 Sec. 9 Twp. 4S Range 7E  
 Owner Lawrence Bach Blue Rapids, Kansas  
Dry address  
 Nature of Deposit Dry Accessibility Good  
 Status of Site Prospective site; not sampled

EXPLORATION DATA

Test Hole	Material at Bottom of Hole	Depth of over-Burden	Depth of Material	Percent Retained							6. f.	L. L.	P. I.				
				1 1/2	3/4	3/8	4	8	16	30				50	100	200	

CORRELATION DATA

Geological Age Quaternary  
 Geological Source Kansan Till  
 Material Similar To \_\_\_\_\_  
 Specific Gravity (Sat.) \_\_\_\_\_ (Dry) \_\_\_\_\_  
 Los Angeles Wear \_\_\_\_\_  
 Absorption \_\_\_\_\_ Soundness \_\_\_\_\_  
 Mt. Cu. Ft. \_\_\_\_\_ Str. Ratio \_\_\_\_\_  
 Remarks \_\_\_\_\_

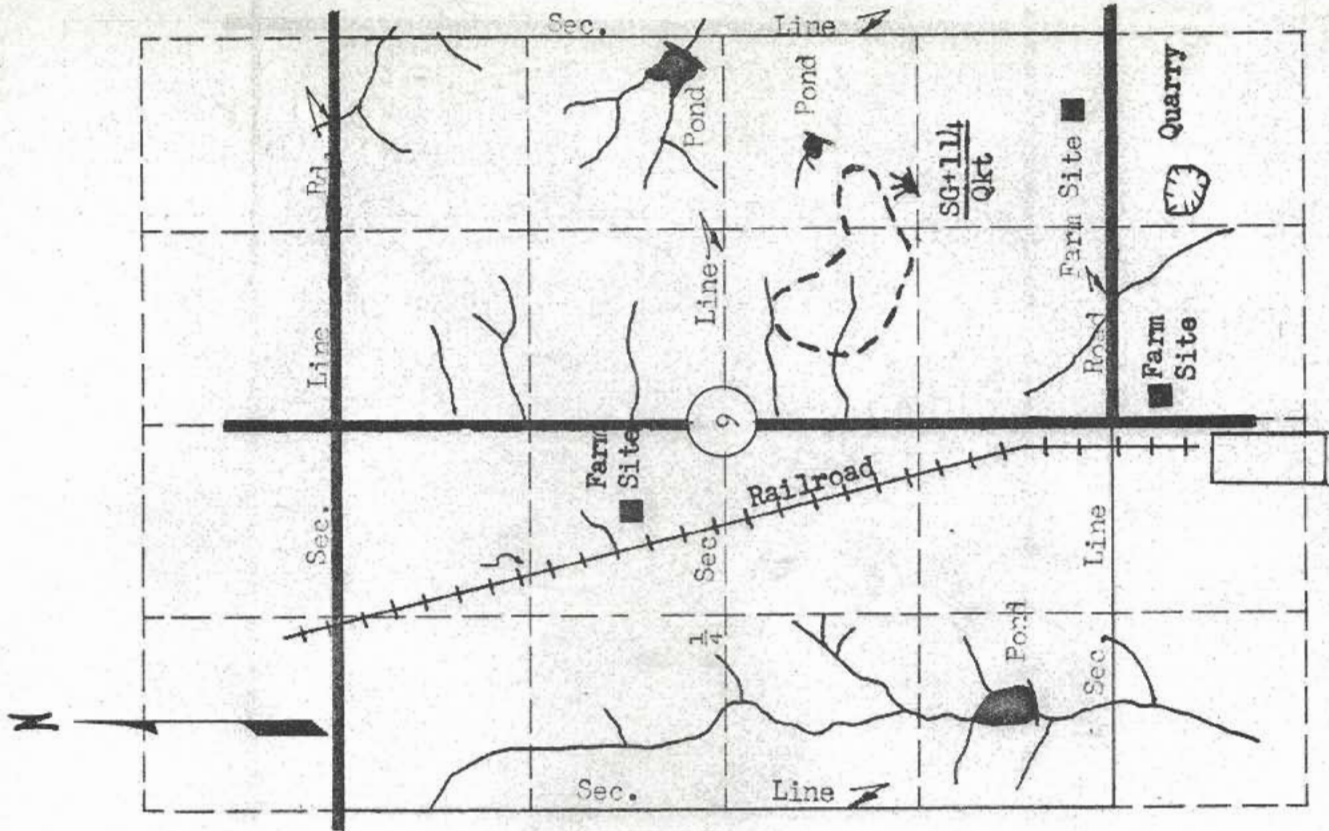

Scale: 1" = 1/4 mile



MATERIAL SURVEY REPORT

Site No. SG+115  
Qkt  
 Date June, 1965  
 Material Sand and Gravel County Marshall  
 Location SE<sup>1</sup> SE<sup>1</sup> Sec. 25 Twp. 1S Range 7E  
 Owner Belle Johnson 305 S. 5th Marysville, Kansas  
 name address  
 Nature of Deposit Dry Accessibility Good  
 Status of Site Prospective site; not sampled

EXPLORATION DATA

Test Hole	Material at Bottom of Hole	Depth of over-Burden	Depth of Material	Percent Retained								Wash 200	G.F.	L.L.	P.L.	
				1/2	3/4	3/8	4	6	16	30	50					100

CORRELATION DATA

Geological Age Quaternary  
 Geological Source Kansan Till  
 Material Similar To \_\_\_\_\_  
 Specific Gravity (Sat.) \_\_\_\_\_ (dry)  
 Los Angeles Wear \_\_\_\_\_  
 Absorption \_\_\_\_\_ Soundness \_\_\_\_\_  
 Wt. Cu.Ft. \_\_\_\_\_ Str. Ratio \_\_\_\_\_  
 Remarks \_\_\_\_\_

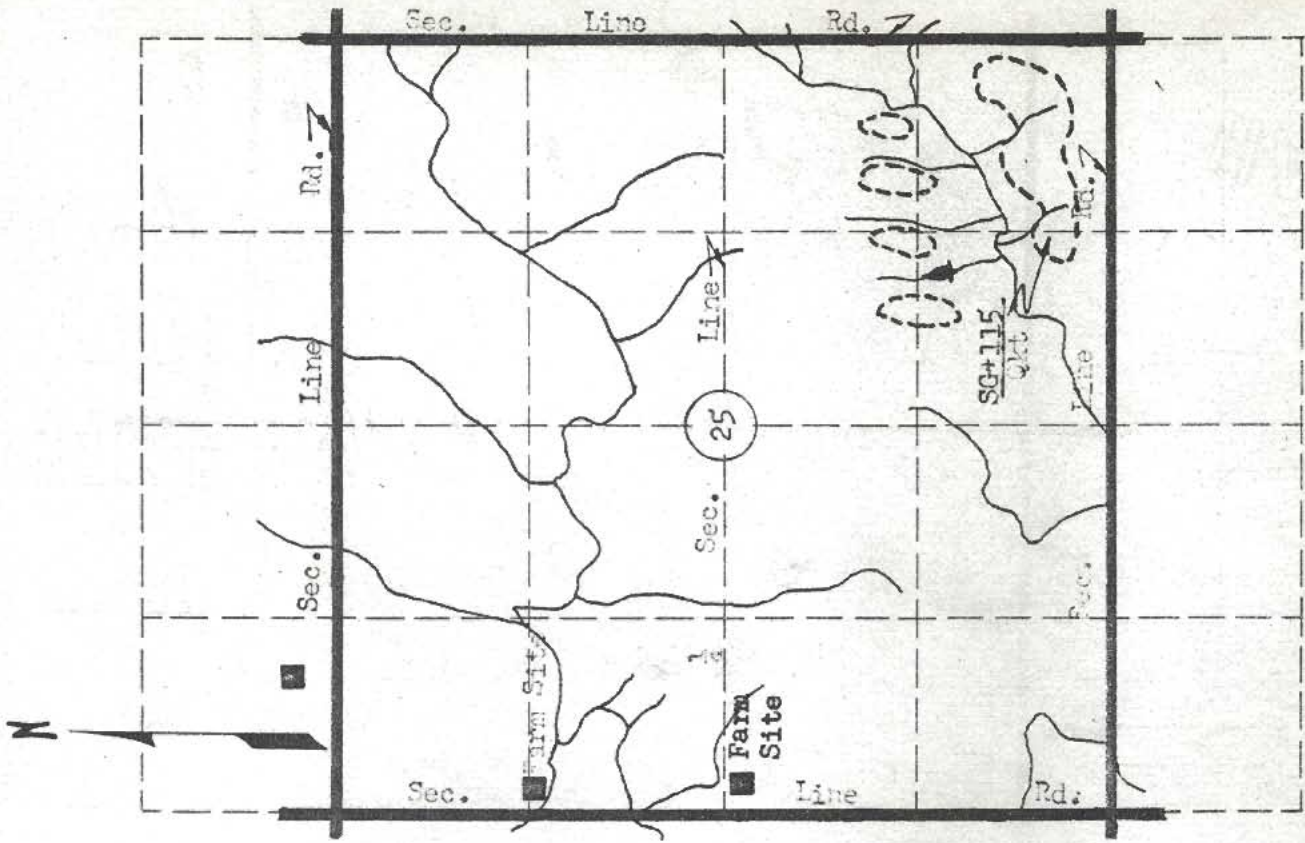

Scale: 1" = 1/4 mile

MATERIAL SURVEY REPORT

Site No. SG+116 Date June, 1965  
Qkt  
 Material Sand and Gravel County Marshall  
 Location SW 1/4 Sec. 35 Twp. 1S Range 7E  
 Owner Frances R. Williams Marysville, Kansas  
name address  
 Nature of Deposit Dry Accessibility Fair  
 Status of Site Prospective site; not sampled

EXPLORATION DATA

Test Hole	Material at Bottom of Hole	Depth of overburden	Depth of Material	Percent Retained					Wash 200	G.F.	L.L.	P.I.
				1/2	3/4	3/8	4	8				

CORRELATION DATA

Geological Age Quaternary  
 Geological Source Kansan Till  
 Material Similar To \_\_\_\_\_  
 Specific Gravity (Set.) \_\_\_\_\_ (Dry)  
 Los Angeles Wear \_\_\_\_\_  
 Absorption \_\_\_\_\_ Soundness \_\_\_\_\_  
 Mt. Cu. Ft. \_\_\_\_\_ Str. Ratio \_\_\_\_\_  
 Remarks \_\_\_\_\_

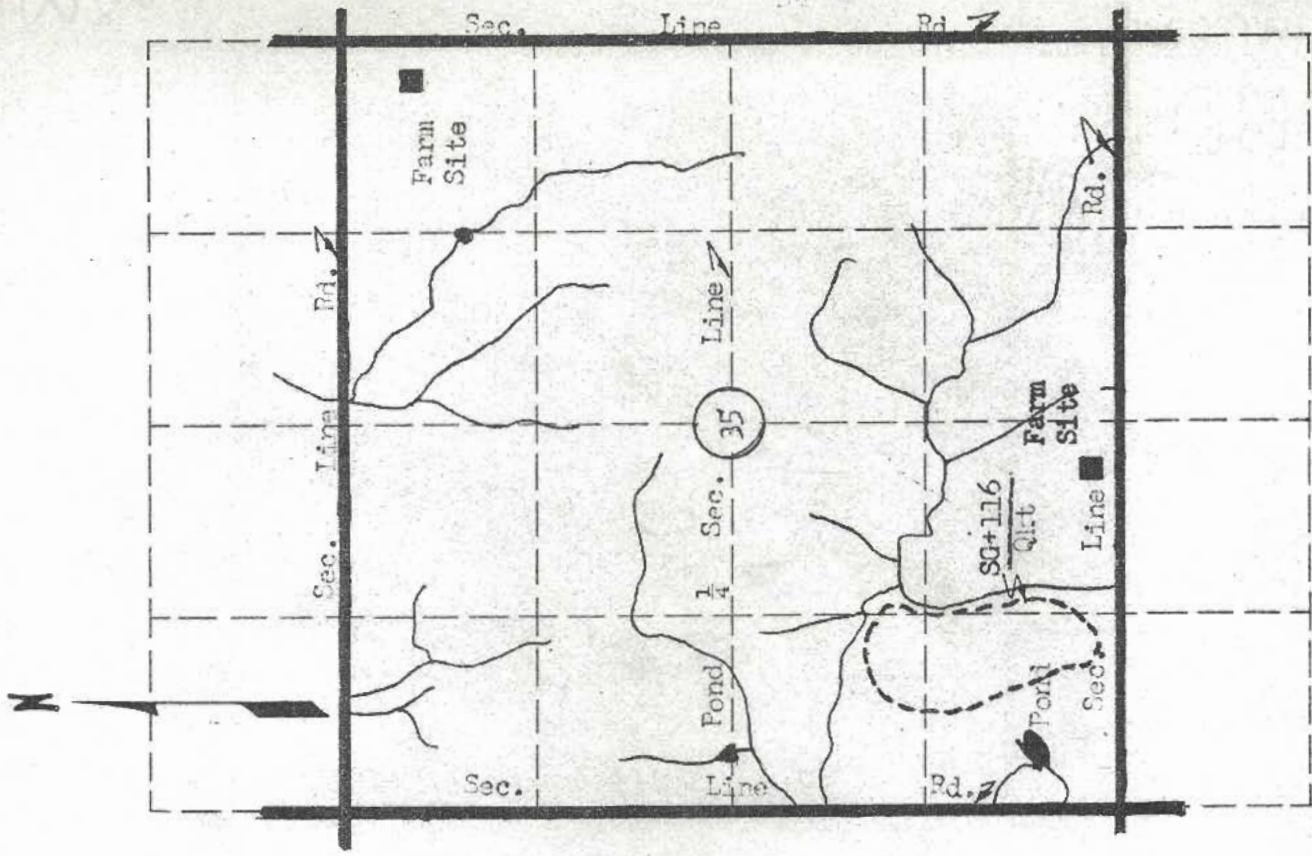

Scale: 1" = 1/4 mile

MATERIAL SURVEY REPORT

Site No. SG+117 Date June, 1965  
 Material Sand and Gravel County Marshall  
 Location S7 NE1 Sec. 11 Twp. 2S Range 7E  
 Owner Bernice and Robert Moser Marysville, Kansas  
 Nature of Deposit Dry Accessibility Fair  
 Status of Site Prospective site; not sampled

EXPLORATION DATA

Test Hole	Material at Bottom of Hole	Depth of over-Burden	Depth of Material	Percent Retained					Wash 200	G.F.	L.L.	P.I.
				1/2	3/4	1	2	4				

CORRELATION DATA

Geological Age Quaternary  
 Geological Source Kansan Till  
 Material Similar To \_\_\_\_\_  
 Specific Gravity (Sat.) \_\_\_\_\_ (Dry)  
 Los Angeles Wear \_\_\_\_\_  
 Absorption \_\_\_\_\_ Soundness \_\_\_\_\_  
 Mt. Cu.Ft. \_\_\_\_\_ Str. Ratio \_\_\_\_\_  
 Remarks \_\_\_\_\_

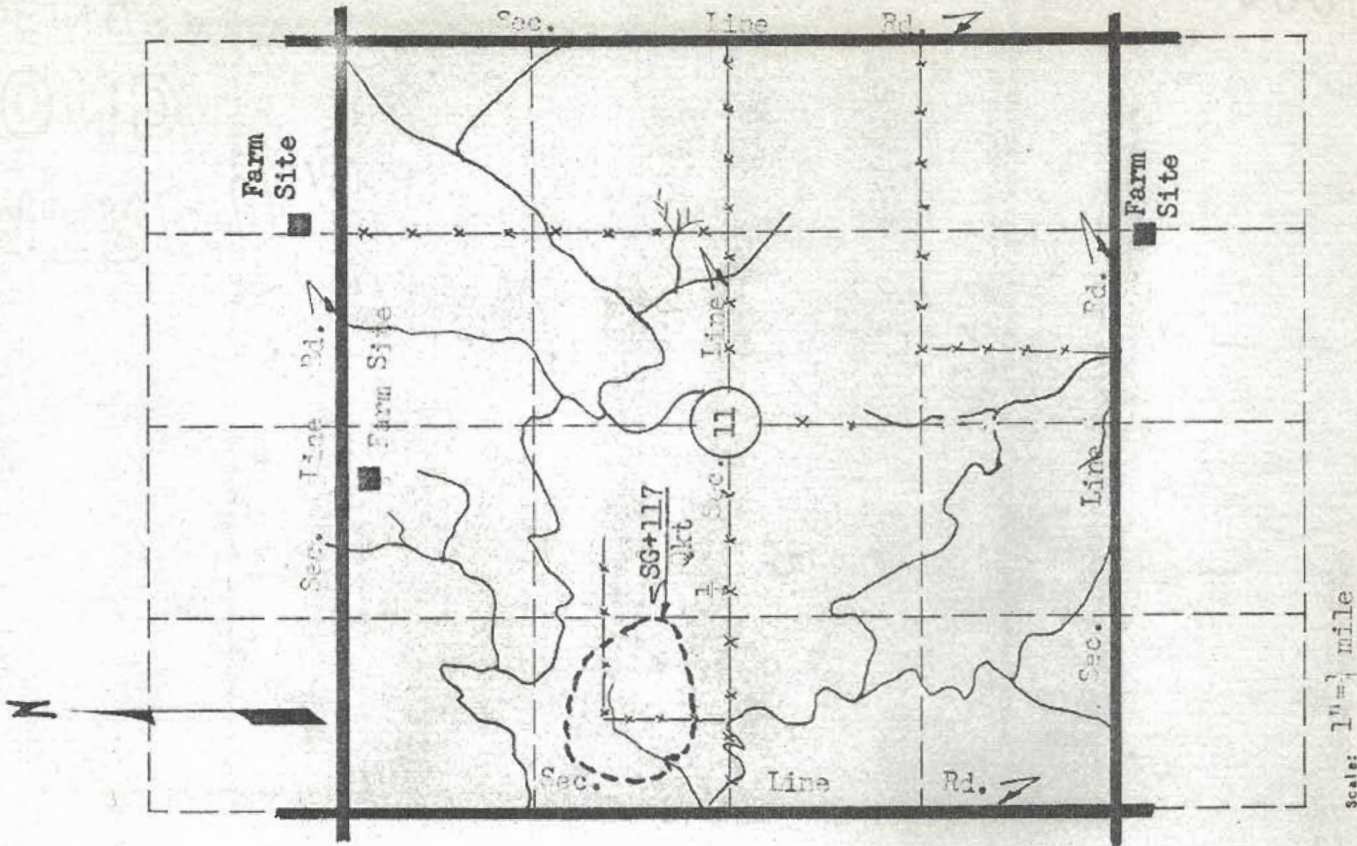

MATERIAL SURVEY REPORT

Site No. SG+118  
Qkt  
 Material Sand and Gravel County Marshall  
 Location NE 1/4 Sec. 30 Twp. 1S Range 6E  
 Owner Eldo F. and Elaine B. Minge Hanover, Kansas  
 address  
 Nature of Deposit Dry Accessibility Good  
 Status of site Prospective site; not sampled

EXPLORATION DATA

Test Hole	Material at Bottom of Hole	Depth of over-burden	Depth of Material	Percent Retained						Wash 200	G.F.	L.L.	P.I.						
				1 1/2	3/4	3/8	4	8	16					30	50	100			

CORRELATION DATA

Geological Age Quaternary  
 Geological Source Kansan Till  
 Material Similar To \_\_\_\_\_  
 Specific Gravity (Sat.) \_\_\_\_\_ (Dry) \_\_\_\_\_  
 Los Angeles Wear \_\_\_\_\_  
 Absorption \_\_\_\_\_ Soundness \_\_\_\_\_  
 Wt. Cu.Ft. \_\_\_\_\_ Str. Ratio \_\_\_\_\_  
 Remarks \_\_\_\_\_

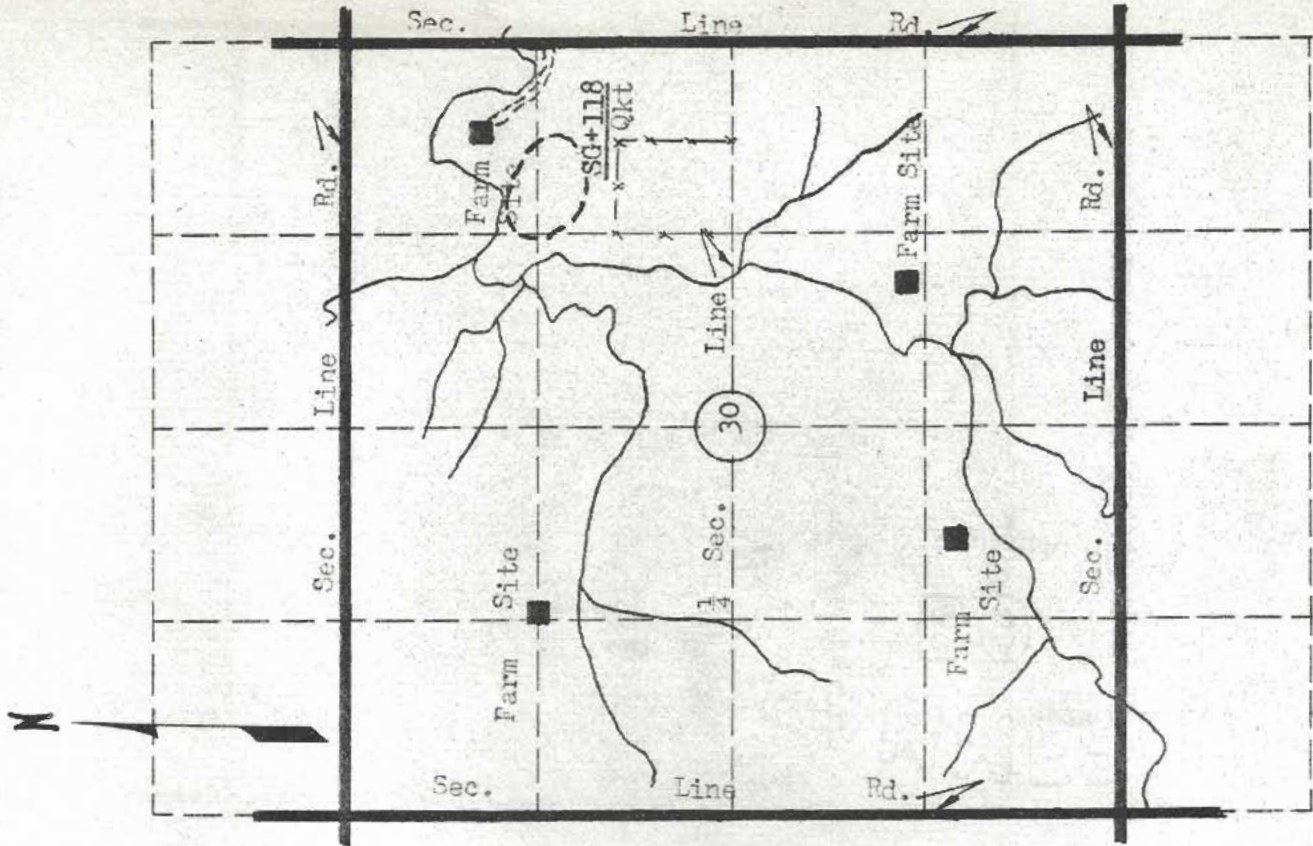

Scale: 1" = 1/4 mile

MATERIAL SURVEY REPORT

Site No. SG+119 Date June, 1965  
Okt  
 Material Sand and Gravel County Marshall  
 Location NE $\frac{1}{4}$  NE $\frac{1}{4}$  Sec. 22 Twp. 3S Range 7E  
Marysville, Kansas  
 Owner J. W. Randell name address  
 Nature of Deposit Dry Accessibility Poor  
 Status of Site Prospective site, not sampled

EXPLORATION DATA

Test Hole	Material at Bottom of Hole	Depth of overburden	Depth of Material	Percent Retained							Mash 200	L.L.	P.I.		
				1 1/2	3/4	3/8	4	8	16	30				50	100

CORRELATION DATA

Geological Age Quaternary  
 Geological Source Kansan Till  
 Material Similar To \_\_\_\_\_  
 Specific Gravity (Sat.) \_\_\_\_\_ (Or) \_\_\_\_\_  
 Los Angeles Wear \_\_\_\_\_  
 Absorption \_\_\_\_\_ Soundness \_\_\_\_\_  
 Wt. Cu.Ft. \_\_\_\_\_ Str. Ratio \_\_\_\_\_  
 Remarks \_\_\_\_\_

