

APPENDIX I

The following site data forms are designated as "open sites; not sampled." The sites described herein are depicted on the county materials map as a "●".

LEGEND

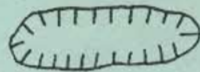

This symbol on the site data form represents an open site.

STATE HIGHWAY COMMISSION OF KANSAS  
MATERIAL SURVEY REPORT

SITE NO. IG-1  
Qtz

MATERIAL Limestone Gravel

LOCATION S $\frac{1}{2}$ , SW $\frac{1}{4}$

OWNER James Winn

TENANT \_\_\_\_\_

NATURE OF DEPOSIT Dry

STATUS OF SITE Open site; not sampled

DATE January, 1964

COUNTY Mitchell

TWP. 6S RANGE 9W

SEC. 3

Glen Elder, Kansas  
address

address

ACCESSIBILITY Good

Test Hole	Material at Bottom of Hole	Depth of Overburden	Depth of Materials	Depth of Hole	EXPLORATION DATA													
					Percent Retained													
					1 1/2	3/4	3/8	4	8	10	16	30	40	50	100	200	Wash	P.L.

CORRELATION DATA

GEOLOGICAL AGE Pleistocene GEOLOGICAL SOURCE High stream terrace

MATERIAL SIMILAR TO \_\_\_\_\_

REMARKS: \_\_\_\_\_

\_\_\_\_\_

\_\_\_\_\_

\_\_\_\_\_

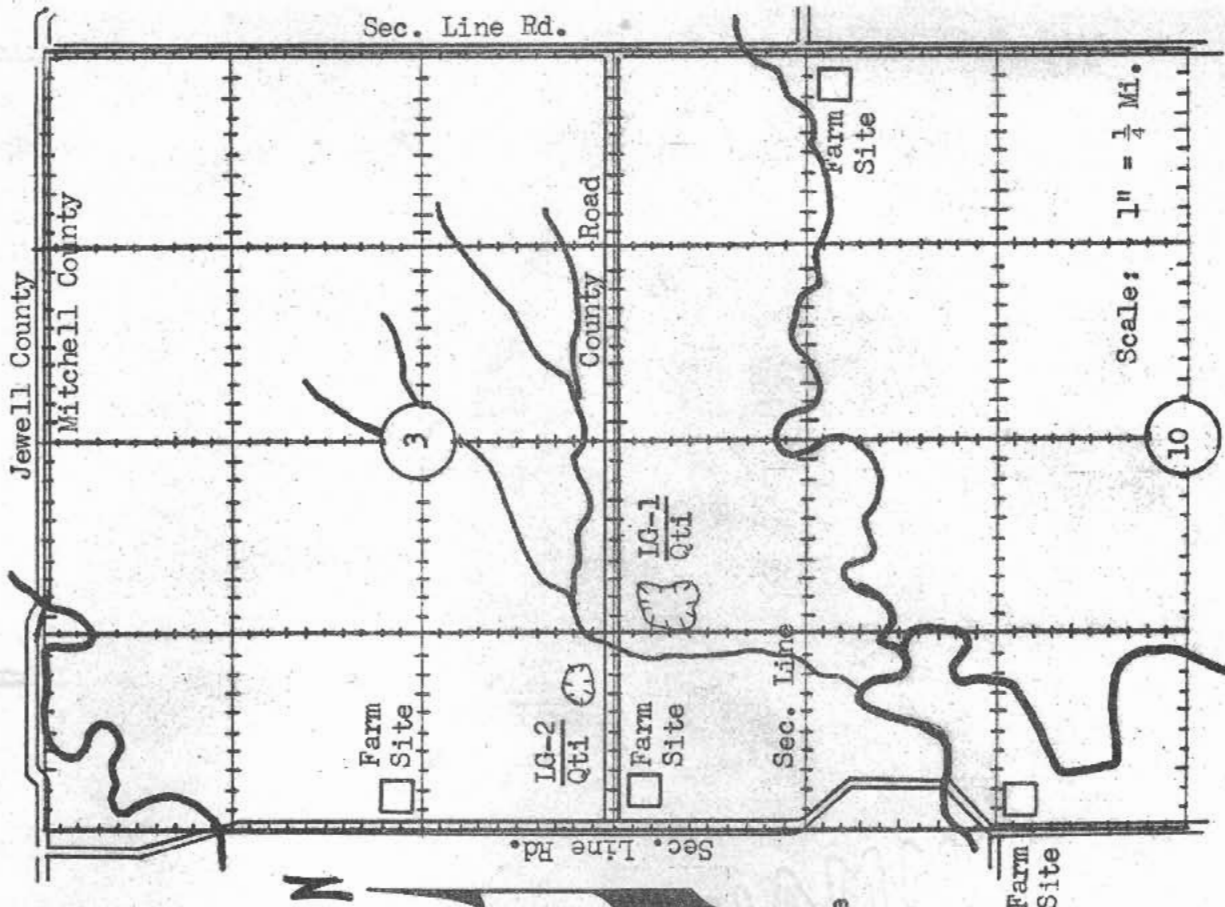



STATE HIGHWAY COMMISSION OF KANSAS  
MATERIAL SURVEY REPORT

IG-2  
Qtl

SITE NO. \_\_\_\_\_ DATE January, 1964  
 MATERIAL Limestone Gravel COUNTY Mitchell  
 LOCATION NW 1/4, SW 1/4 SEC. 3 TWP. 6S RANGE 9W  
 OWNER Wayne P. Winkel Glen Elder, Kansas  
 TENANT \_\_\_\_\_ address \_\_\_\_\_  
 NATURE OF DEPOSIT Dry ACCESSIBILITY Good  
 STATUS OF SITE Open site; not sampled

Test Hole	Material at bottom of hole	Depth of Overburden	Depth of Materials Hole	EXPLORATION DATA													
				Percent Retained													
				1 1/2	3/4	3/8	4	8	10	16	30	40	50	100	200	Wash	

CORRELATION DATA

GEOLOGICAL AGE Pleistocene GEOLOGICAL SOURCE High stream terrace  
 MATERIAL SIMILAR TO \_\_\_\_\_  
 REMARKS: \_\_\_\_\_  
 \_\_\_\_\_  
 \_\_\_\_\_  
 \_\_\_\_\_

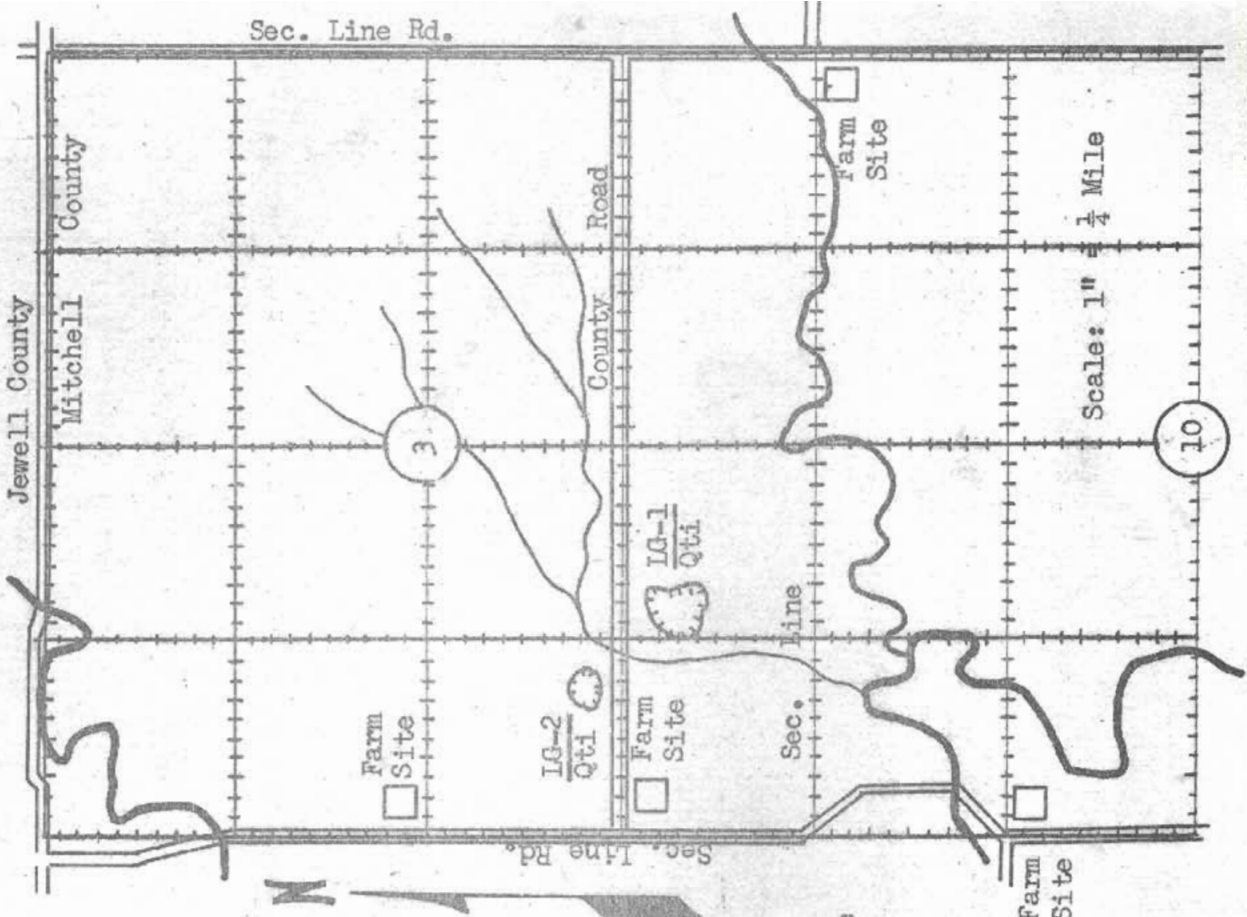

STATE HIGHWAY COMMISSION OF KANSAS  
MATERIAL SURVEY REPORT

LG-3  
Qti

SITE NO. \_\_\_\_\_ DATE January, 1964  
 MATERIAL Limestone Gravel COUNTY Mitchell  
 LOCATION SE 1/4, SW 1/4 SEC. 4 TWP. 6S RANGE 9W  
 OWNER Eva Waugh Mankato, Kansas  
 TENANT \_\_\_\_\_ name \_\_\_\_\_ address \_\_\_\_\_  
 NATURE OF DEPOSIT Dry ACCESSIBILITY Good  
 STATUS OF SITE Open site; not sampled

Test Hole	Material at Bottom of Hole	Depth of Over-burden	Depth of Materials	Depth of Hole	EXPLORATION DATA														
					Percent Retained														
					1 1/2	3/4	3/8	4	8	10	16	30	40	50	100	200	Wash	P.L.	

CORRELATION DATA

GEOLOGICAL AGE Pleistocene GEOLOGICAL SOURCE High stream terrace  
 MATERIAL SIMILAR TO \_\_\_\_\_

REMARKS: \_\_\_\_\_  
 \_\_\_\_\_  
 \_\_\_\_\_

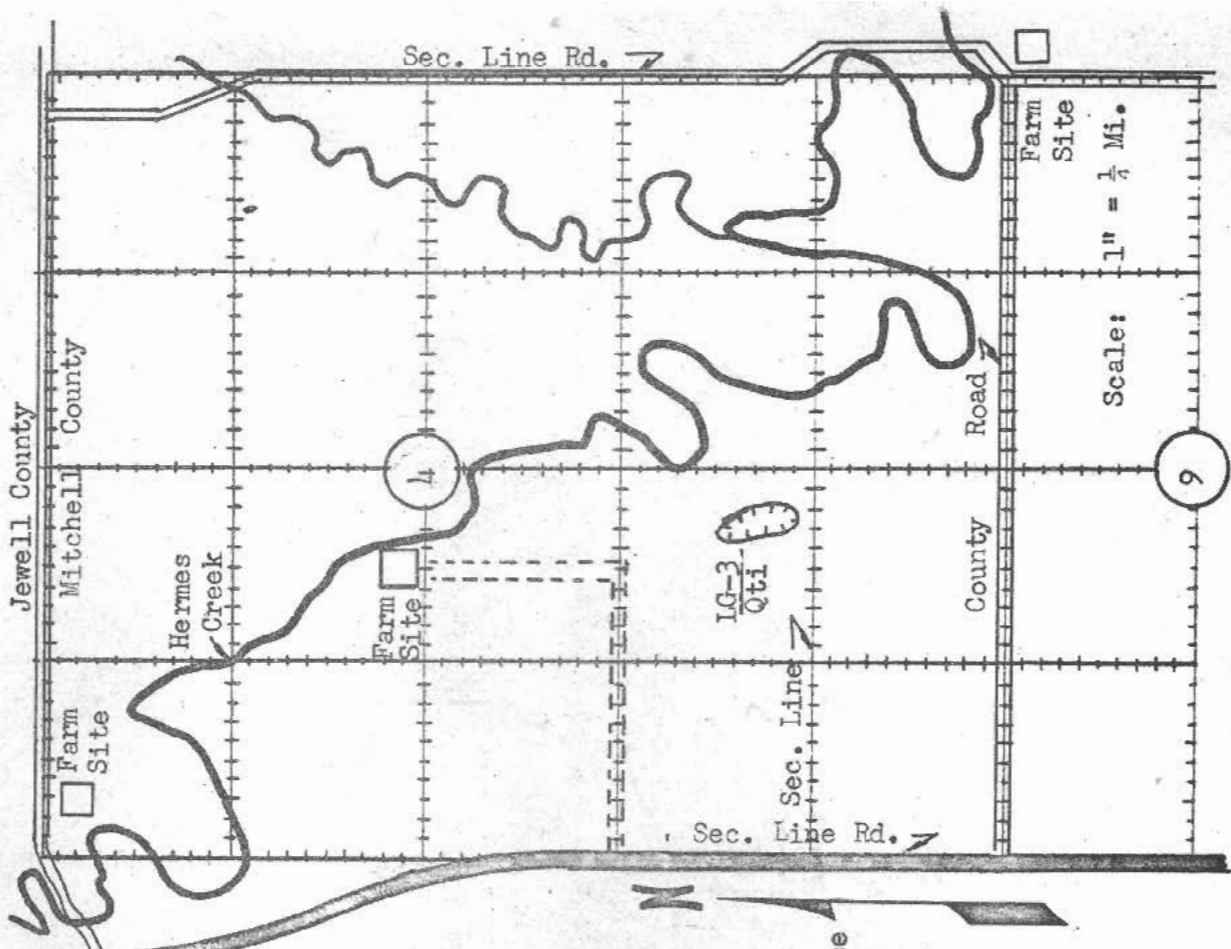

K-128 Highway



STATE HIGHWAY COMMISSION OF KANSAS  
MATERIAL SURVEY REPORT

IG-4  
Qtl

SITE NO. \_\_\_\_\_ DATE January, 1964  
 MATERIAL Limestone Gravel COUNTY Mitchell  
 LOCATION NW $\frac{1}{4}$ , SE $\frac{1}{4}$  SEC. 4 TWP. 6S RANGE LOW  
 OWNER Elizabeth Flavin Cawker City, Kansas  
 TENANT \_\_\_\_\_ address \_\_\_\_\_  
 NATURE OF DEPOSIT Dry ACCESSIBILITY Good  
 STATUS OF SITE Open site; not sampled

EXPLORATION DATA

Test Holes	Material at Bottom of Hole	Depth of Overburden	Depth of Materials Hole	Percent Retained																		
				1 1/2	3/4	3/8	4	8	10	16	30	40	50	100	200	Wash	P.L.					

CORRELATION DATA

GEOLOGICAL AGE Pleistocene GEOLOGICAL SOURCE High stream terrace  
 MATERIAL SIMILAR TO \_\_\_\_\_

REMARKS: \_\_\_\_\_  
 \_\_\_\_\_  
 \_\_\_\_\_

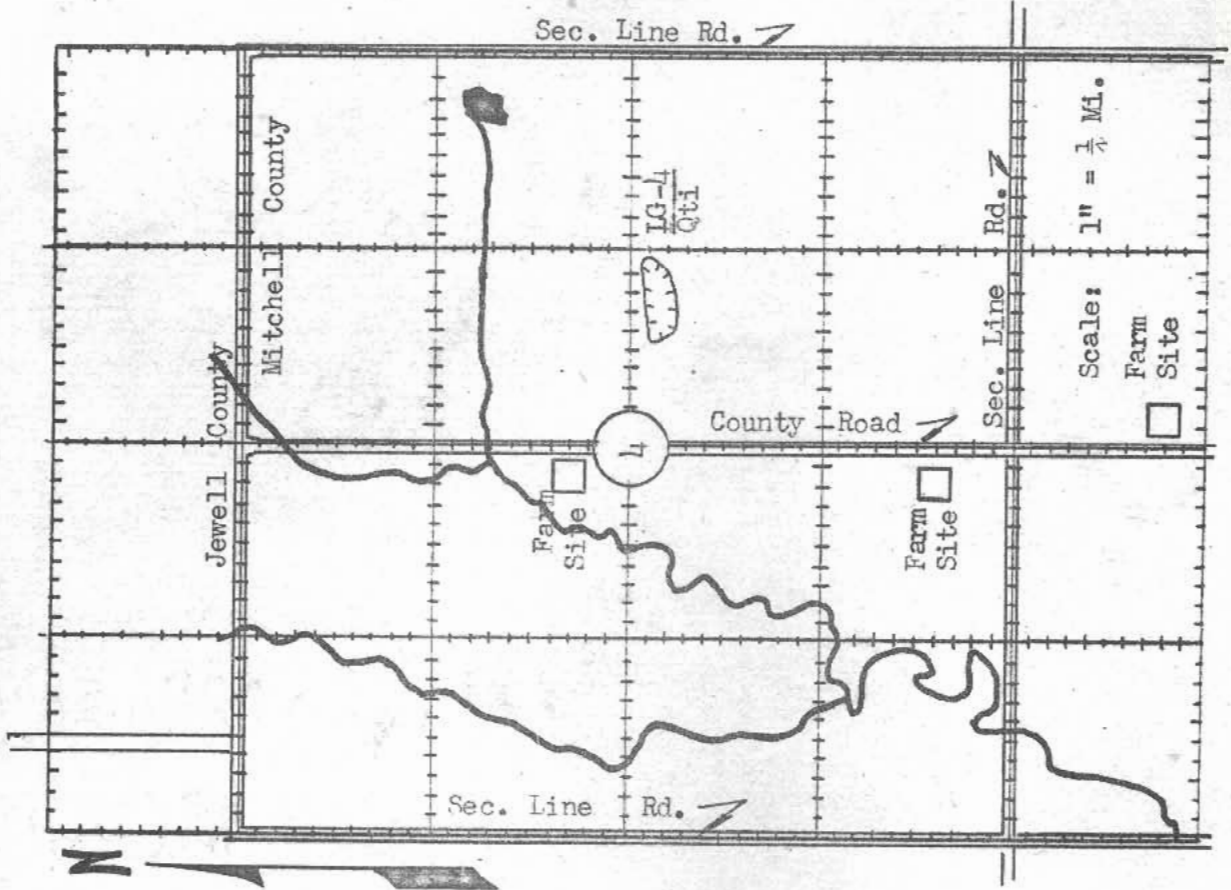



STATE HIGHWAY COMMISSION OF KANSAS  
MATERIAL SURVEY REPORT

SITE NO. IG-5  
QTL

MATERIAL Limestone Gravel

LOCATION NE $\frac{1}{4}$ , SW $\frac{1}{4}$  SEC. 10 TWP. 6S RANGE 9W

OWNER Maxine Weir name Beloit, Kansas address

TENANT \_\_\_\_\_ name \_\_\_\_\_ address \_\_\_\_\_

NATURE OF DEPOSIT Dry ACCESSIBILITY Good

STATUS OF SITE Open site; not sampled

EXPLORATION DATA

Test Hole	Material at Bottom of Hole	Depth of Overburden	Depth of Materials Hole	Percent Retained											Wash	PI					
				1 1/2	3/4	3/8	4	8	10	16	30	40	50	100			200				

CORRELATION DATA

GEOLOGICAL AGE Pleistocene GEOLOGICAL SOURCE High stream terrace

MATERIAL SIMILAR TO \_\_\_\_\_

REMARKS: \_\_\_\_\_

\_\_\_\_\_

\_\_\_\_\_

\_\_\_\_\_

\_\_\_\_\_

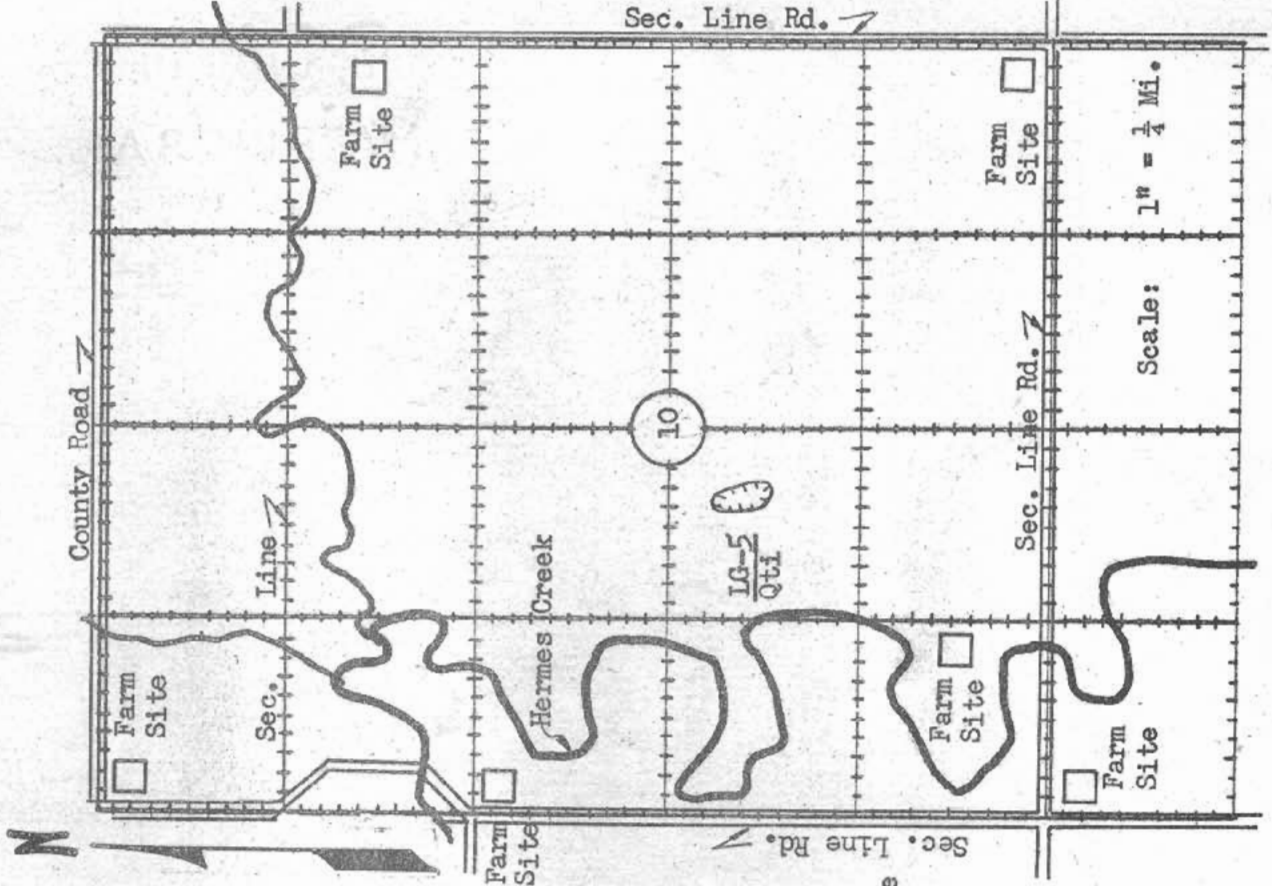

STATE HIGHWAY COMMISSION OF KANSAS  
MATERIAL SURVEY REPORT

SITE NO. LG-6 / Qtz DATE January, 1964  
 MATERIAL Limestone Gravel COUNTY Mitchell  
 LOCATION NW 1/4, SE 1/4 SEC. 15 TWP. 6S RANGE 10W  
 OWNER Warren E. & Keith Inskoop Cawker City, Kansas  
 name address  
 TENANT \_\_\_\_\_ name address  
 NATURE OF DEPOSIT Dry ACCESSIBILITY Good  
 STATUS OF SITE Open site; not sampled

Test Hole	Material at Bottom of Hole	Depth of Overburden	Depth of Materials	Depth of Hole	EXPLORATION DATA															
					Percent Retained															
					1 1/2	3/4	3/8	4	8	10	16	30	40	50	100	200	Wash	L.L.	P.L.	

CORRELATION DATA  
 GEOLOGICAL AGE Pleistocene GEOLOGICAL SOURCE High stream terrace  
 MATERIAL SIMILAR TO \_\_\_\_\_  
 REMARKS: \_\_\_\_\_  
 \_\_\_\_\_  
 \_\_\_\_\_  
 \_\_\_\_\_

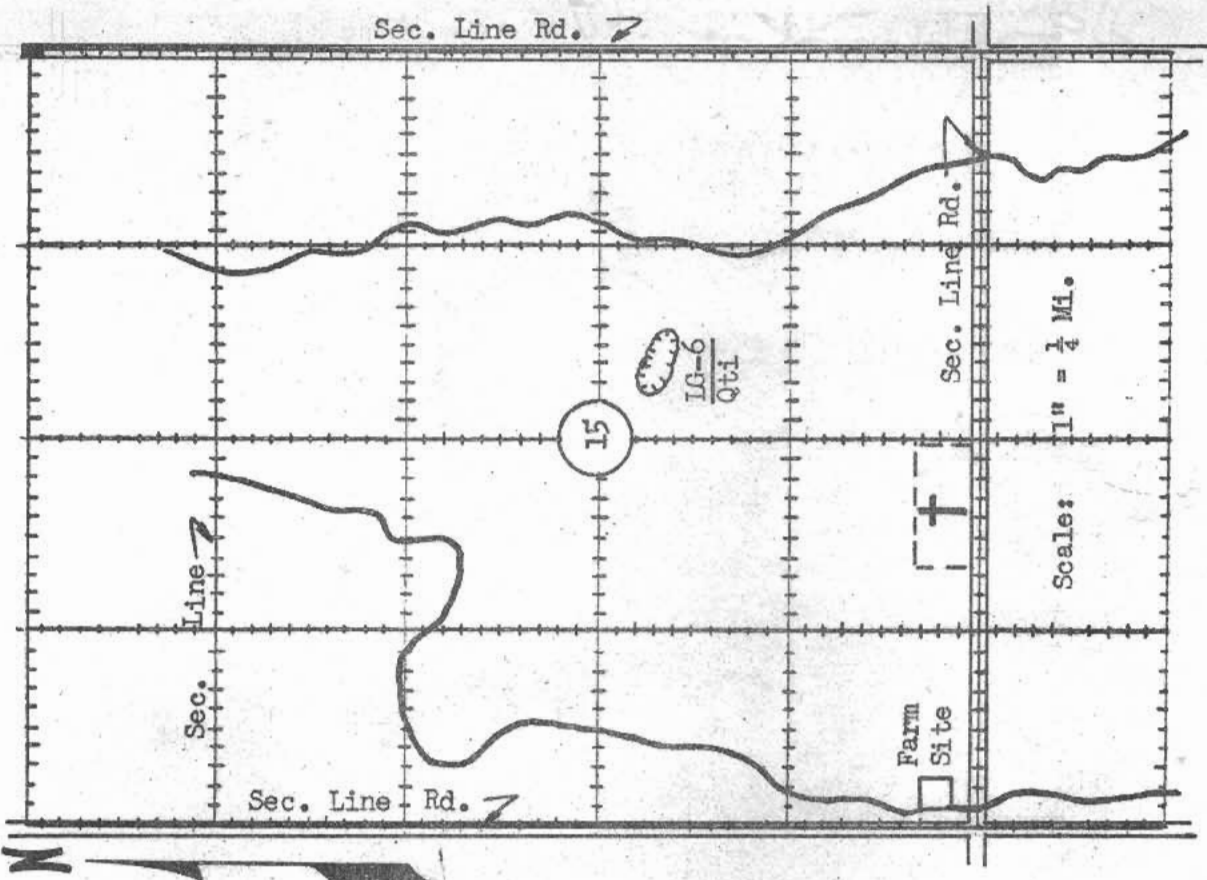























STATE HIGHWAY COMMISSION OF KANSAS  
MATERIAL SURVEY REPORT

LG-13  
Qti

SITE NO. \_\_\_\_\_ DATE January, 1964  
 MATERIAL Limestone Gravel COUNTY Mitchell  
 LOCATION NE 1/4 SEC. 26 TWP. 6S RANGE 7W  
 OWNER Henry & Mary Budke Beloit, Kansas  
 TENANT \_\_\_\_\_ address \_\_\_\_\_  
 NATURE OF DEPOSIT DRY ACCESSIBILITY Good  
 STATUS OF SITE Open site; not sampled

Test Hole	Material at Bottom of Hole	Depth of Overburden	Depth of Materials Hole	Depth of Hole	EXPLORATION DATA															
					Percent Retained															
					1 1/2	3/4	3/8	4	8	10	16	30	40	50	100	200	Wash	LL	PL	

CORRELATION DATA

GEOLOGICAL AGE Pleistocene GEOLOGICAL SOURCE High stream terrace  
 MATERIAL SIMILAR TO \_\_\_\_\_

REMARKS: \_\_\_\_\_  
 \_\_\_\_\_  
 \_\_\_\_\_  
 \_\_\_\_\_

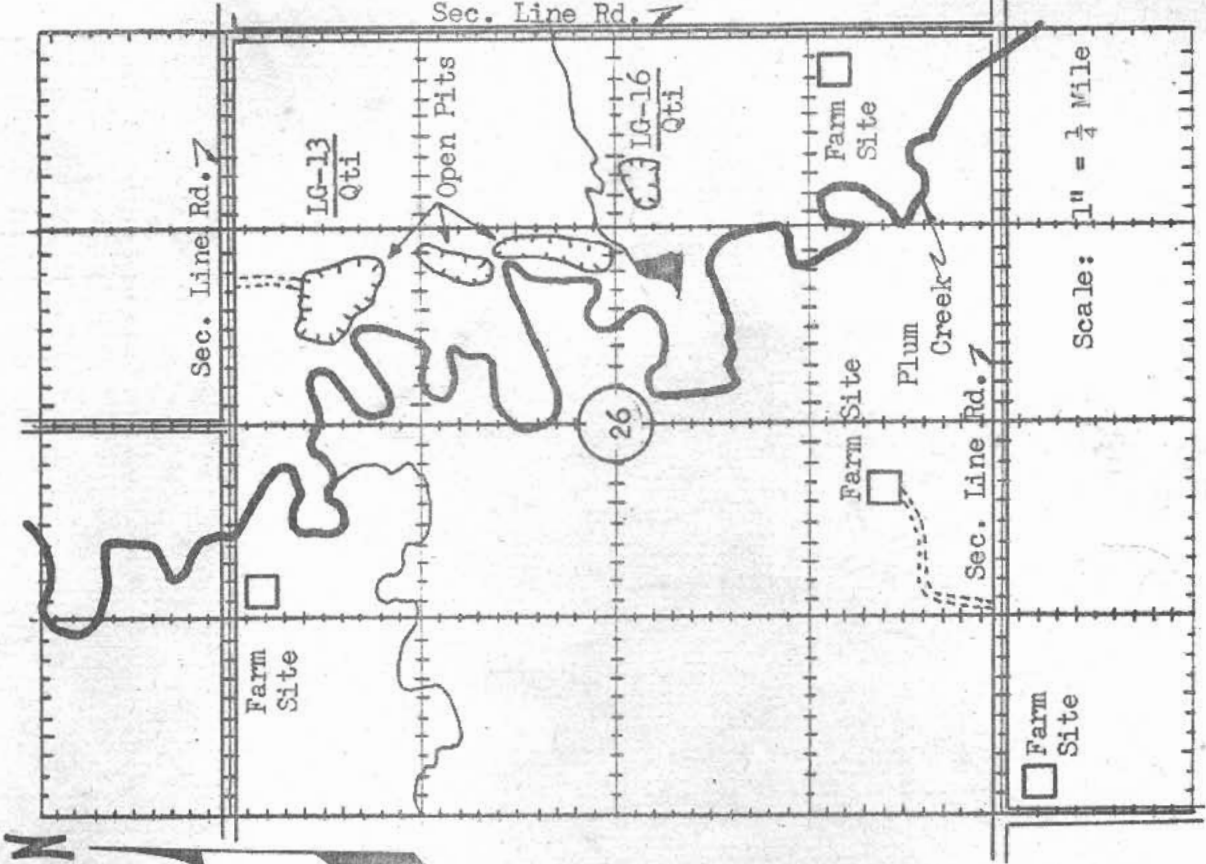













STATE HIGHWAY COMMISSION OF KANSAS  
MATERIAL SURVEY REPORT

SITE NO. SG+18  
Qa1

MATERIAL Sand and Gravel COUNTY Mitchell

LOCATION SE 1/4 SEC. 2 TWP. 7S RANGE 8W

OWNER Paul Mears Beloit, Kansas

TENANT \_\_\_\_\_ address

NATURE OF DEPOSIT Wet ACCESSIBILITY Fair

STATUS OF SITE Open site; not sampled

Test Hole	Material at Bottom of Hole	Depth of Overburden	Depth of Materials	Depth of Hole	EXPLORATION DATA													
					Percent Retained													
					1 1/2	3/4	3/8	4	8	10	16	30	40	50	100	200	Wash	

CORRELATION DATA

GEOLOGICAL AGE Recent GEOLOGICAL SOURCE River flood plain

MATERIAL SIMILAR TO \_\_\_\_\_

REMARKS: \_\_\_\_\_

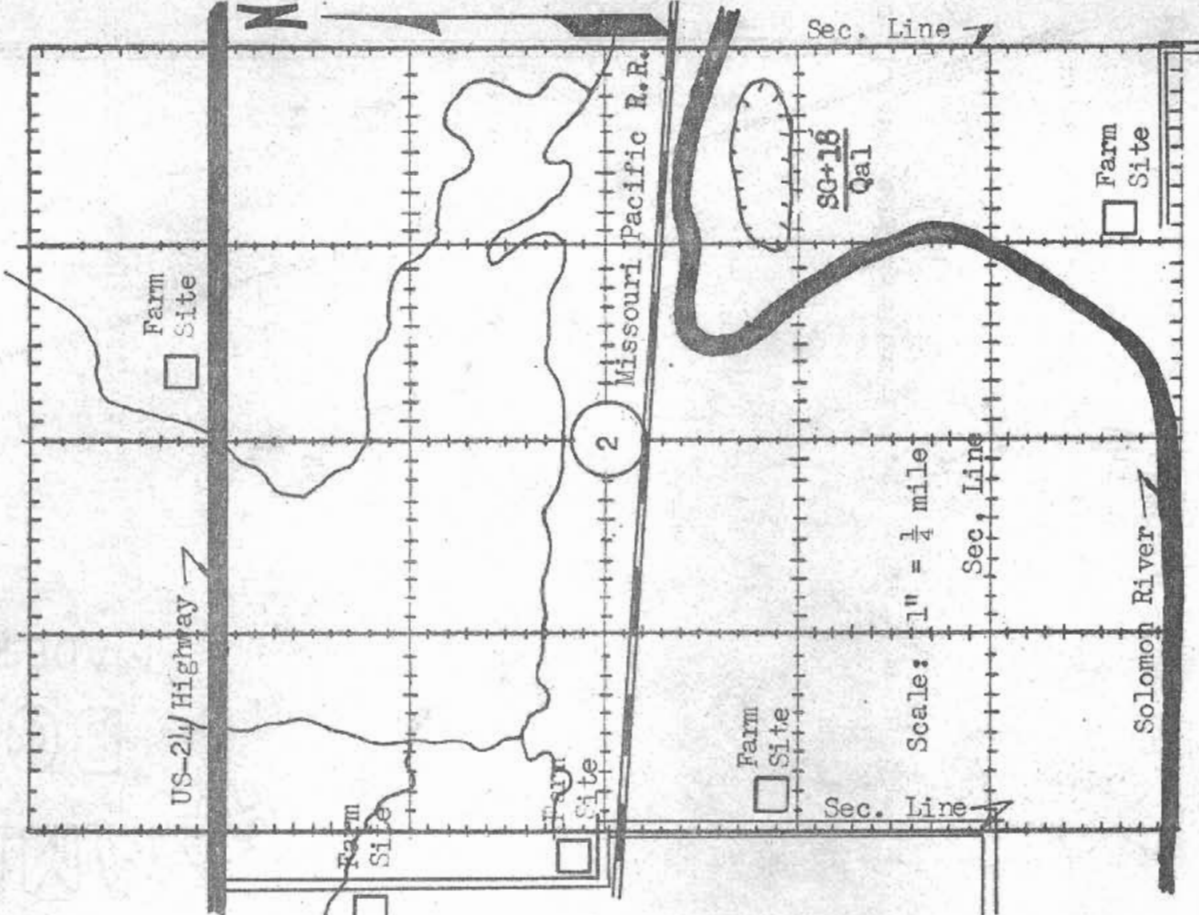









STATE HIGHWAY COMMISSION OF KANSAS  
MATERIAL SURVEY REPORT

IS+21  
Kgh

SITE NO. \_\_\_\_\_ DATE January, 1964

MATERIAL Limestone COUNTY Mitchell

LOCATION SE 1/4, NW 1/4 SEC. 31 TWP. 6S RANGE 9W

OWNER Harold Geyman name Glen Elder, Kansas address \_\_\_\_\_

TENANT \_\_\_\_\_ name \_\_\_\_\_ address \_\_\_\_\_

NATURE OF DEPOSIT Dry ACCESSIBILITY Good

STATUS OF SITE Open site; not sampled

Test Hole	Material at Bottom of Hole	Depth of Overburden	Depth of Materials	Depth of Hole	EXPLORATION DATA													
					Percent Retained													
					1 1/2	3/4	3/8	4	8	10	16	30	40	50	100	Wash 200	L.L.	P.L.

CORRELATION DATA Greenhorn Limestone

GEOLOGICAL AGE Cretaceous GEOLOGICAL SOURCE Formation

MATERIAL SIMILAR TO \_\_\_\_\_

REMARKS: \_\_\_\_\_

\_\_\_\_\_

\_\_\_\_\_

\_\_\_\_\_

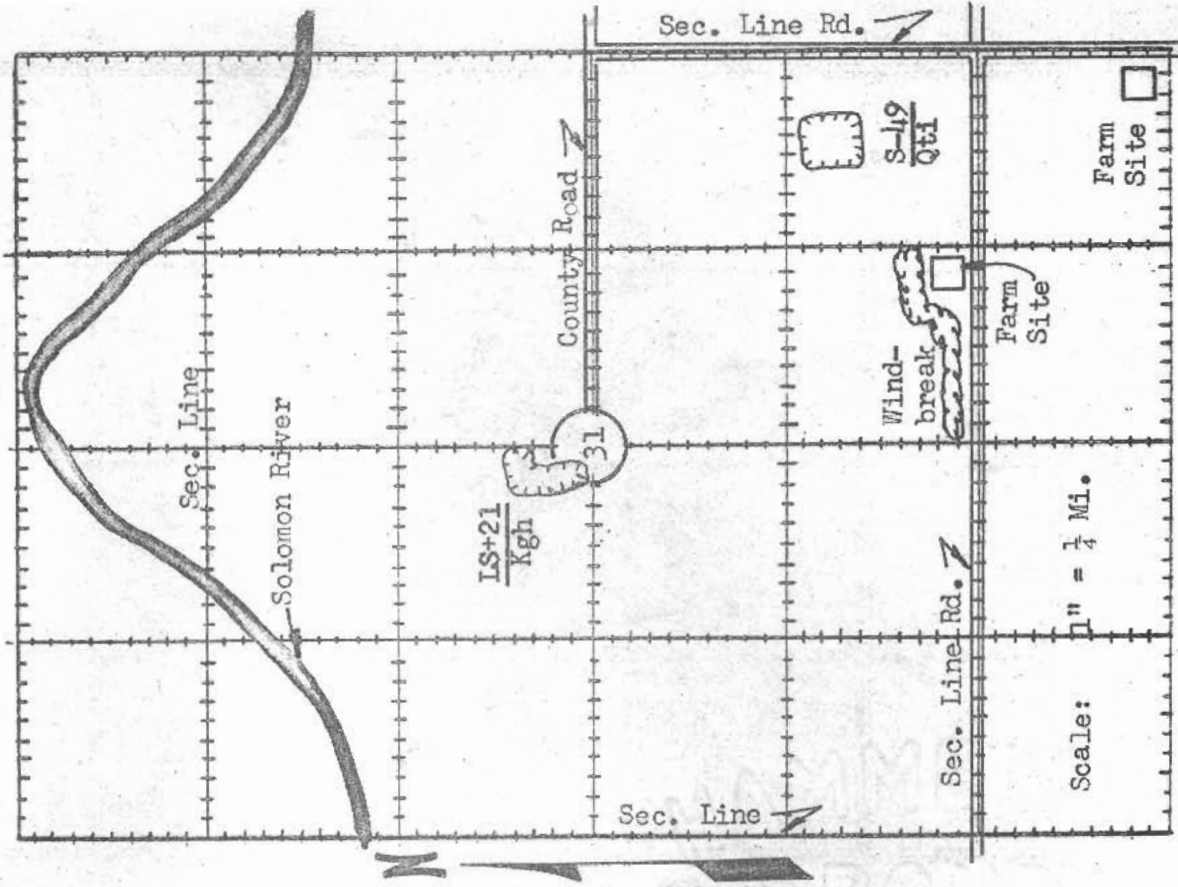

























STATE HIGHWAY COMMISSION OF KANSAS  
MATERIAL SURVEY REPORT

SITE NO. SG-30  
Qal  
MATERIAL Sand and Gravel  
LOCATION SW $\frac{1}{4}$ , SE $\frac{1}{4}$  SFC. 8 TWP. 7S RANGE 7W  
OWNER W. Earl Porter Beloit, Kansas  
TENANT \_\_\_\_\_ address \_\_\_\_\_  
NATURE OF DEPOSIT Wet ACCESSIBILITY Good  
STATUS OF SITE Open site; not sampled

Test Hole	Material at Bottom of Hole	Depth of Overburden	Depth of Material	Depth of Hole	EXPLORATION DATA														
					Percent Retained														
					1/2	3/4	7/8	4	8	10	16	30	40	50	100	200	Wash	P.I.	

CORRELATION DATA  
GEOLOGICAL AGE Recent GEOLOGICAL SOURCE River flood plain  
MATERIAL SIMILAR TO \_\_\_\_\_

REMARKS: \_\_\_\_\_  
\_\_\_\_\_  
\_\_\_\_\_

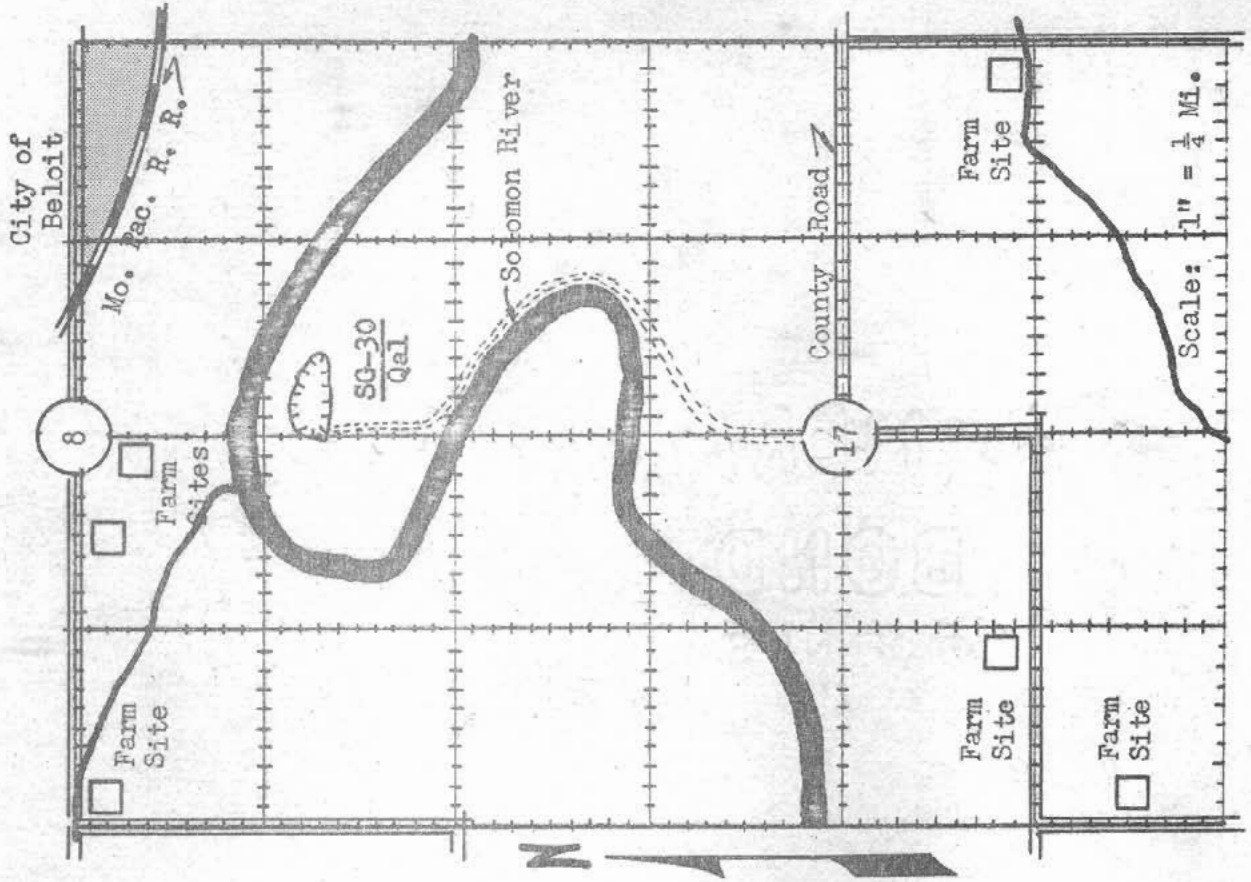









STATE HIGHWAY COMMISSION OF KANSAS  
MATERIAL SURVEY REPORT

SG-33  
Qal

SITE NO. \_\_\_\_\_ DATE January, 1964  
 MATERIAL Sand and Gravel COUNTY Mitchell  
 LOCATION NW $\frac{1}{4}$ , NW $\frac{1}{4}$  SEC. 16 TWP. 7S RANGE 7W  
 OWNER Lucy A Brackett Beloit, Kansas  
 TENANT \_\_\_\_\_ address \_\_\_\_\_  
 NATURE OF DEPOSIT Wet ACCESSIBILITY Good  
 STATUS OF SITE Open site; not sampled

Test Holes	Material at Bottom of Hole	Depth of Overburden	Depth of Hole	EXPLORATION DATA														
				Percent Retained														
				1 1/2	3/4	7/8	4	8	10	16	30	40	50	100	200	Wash	L-L	Pt.

GEOLOGICAL AGE Recent CORRELATION DATA \_\_\_\_\_  
 GEOLOGICAL SOURCE River flood plain

MATERIAL SIMILAR TO \_\_\_\_\_

REMARKS: \_\_\_\_\_  
 \_\_\_\_\_  
 \_\_\_\_\_  
 \_\_\_\_\_

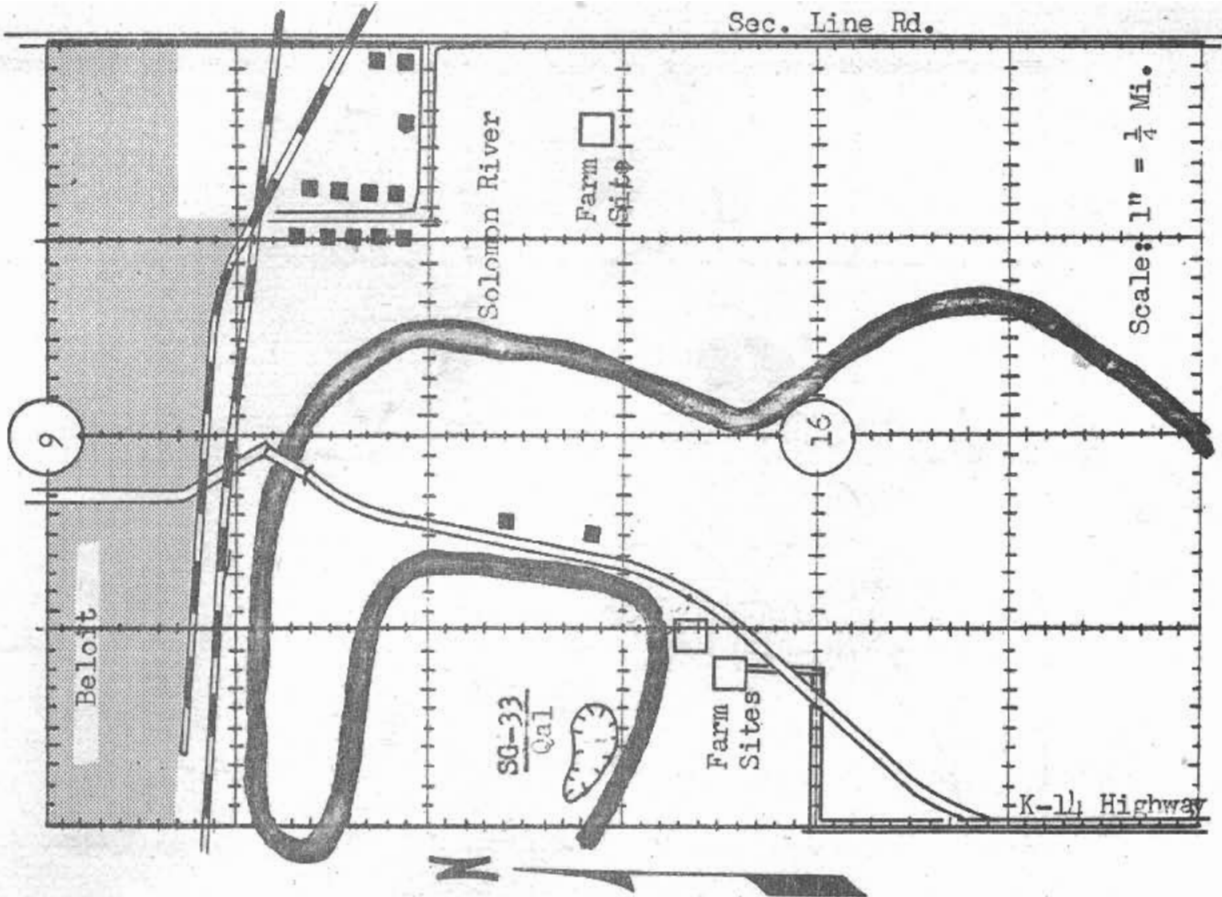

STATE HIGHWAY COMMISSION OF KANSAS  
MATERIAL SURVEY REPORT

SITE NO. LS+34 / Kgh DATE January, 1964  
 MATERIAL Limestone COUNTY Mitchell  
 LOCATION SE 1/4 SEC. 24 TWP. 8S RANGE 6W  
 OWNER Mose Louthan c/o Leslie Louthan Simpson, Kansas  
 TENANT \_\_\_\_\_ name \_\_\_\_\_ address \_\_\_\_\_  
 NATURE OF DEPOSIT Dry ACCESSIBILITY Good  
 STATUS OF SITE Open site; not sampled

Test Hole	Material at Bottom of Hole	Depth of Overburden	Depth of Materials Hole	EXPLORATION DATA														
				Percent Retained														
				1 1/2	3/4	3/8	4	8	10	16	30	40	50	100	200	Wash	P.L.	

GEOLOGICAL AGE Cretaceous CORRELATION DATA Greenhorn Limestone  
 GEOLOGICAL SOURCE Formation

MATERIAL SIMILAR TO \_\_\_\_\_  
 REMARKS: \_\_\_\_\_  
 \_\_\_\_\_  
 \_\_\_\_\_  
 \_\_\_\_\_

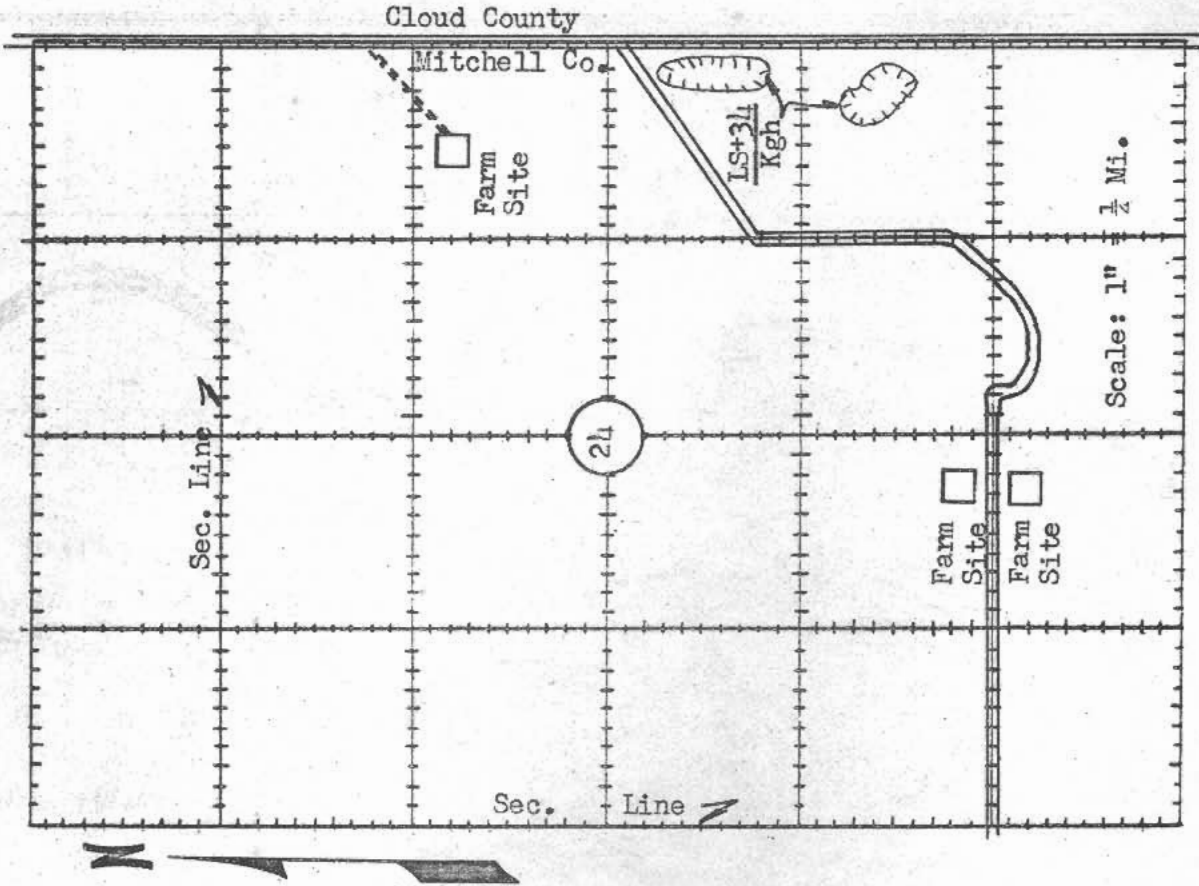











STATE HIGHWAY COMMISSION OF KANSAS  
MATERIAL SURVEY REPORT

LG-38  
Qtl

SITE NO. \_\_\_\_\_ DATE January, 1964  
 MATERIAL Limestone Gravel COUNTY Mitchell  
 LOCATION SE 1/4, SE 1/4 SEC. 33 TWP. 9S RANGE 7W  
 OWNER Emery H. Watson address Barnard, Kansas  
 TENANT \_\_\_\_\_ name \_\_\_\_\_ address \_\_\_\_\_  
 NATURE OF DEPOSIT Dry ACCESSIBILITY Good  
 STATUS OF SITE Open site; not sampled

Test Hole	Material at Bottom of Hole	Depth of Overburden	Depth of Material	Depth of Hole	EXPLORATION DATA														
					Percent Retained														
					1 1/2	3/4	3/8	4	8	10	16	30	40	50	100	200	Wash	Pt.	

CORRELATION DATA

GEOLOGICAL AGE Pleistocene GEOLOGICAL SOURCE High stream terrace

MATERIAL SIMILAR TO \_\_\_\_\_

REMARKS: \_\_\_\_\_

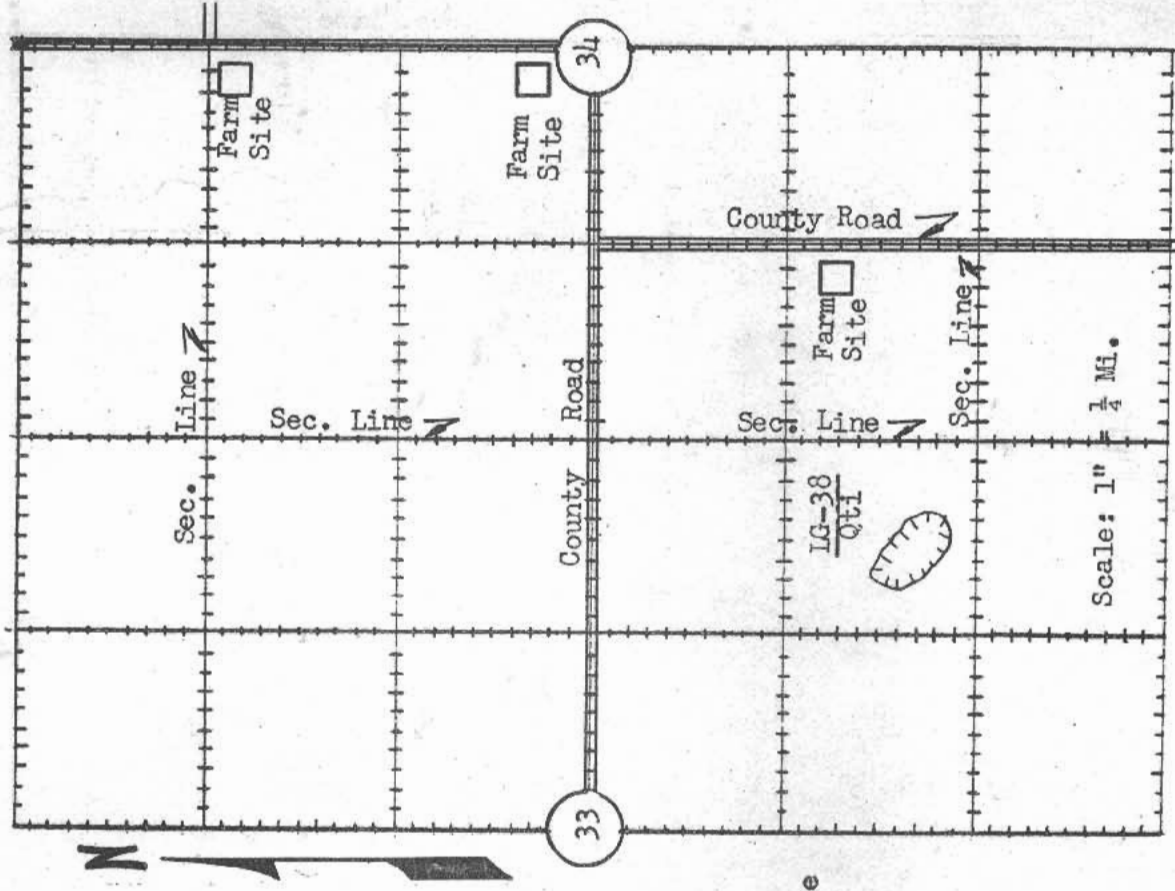





STATE HIGHWAY COMMISSION OF KANSAS  
MATERIAL SURVEY REPORT

SITE NO. LG-40  
Qti

MATERIAL Limestone Gravel

LOCATION NE $\frac{1}{4}$  SEC. 19 TWP. 9S RANGE 7W

OWNER Eva V. Gum 6807 Rock Hill Road Kansas City, 5 Mo.

TENANT \_\_\_\_\_

NATURE OF DEPOSIT Dry ACCESSIBILITY Good

STATUS OF SITE Open site; not sampled

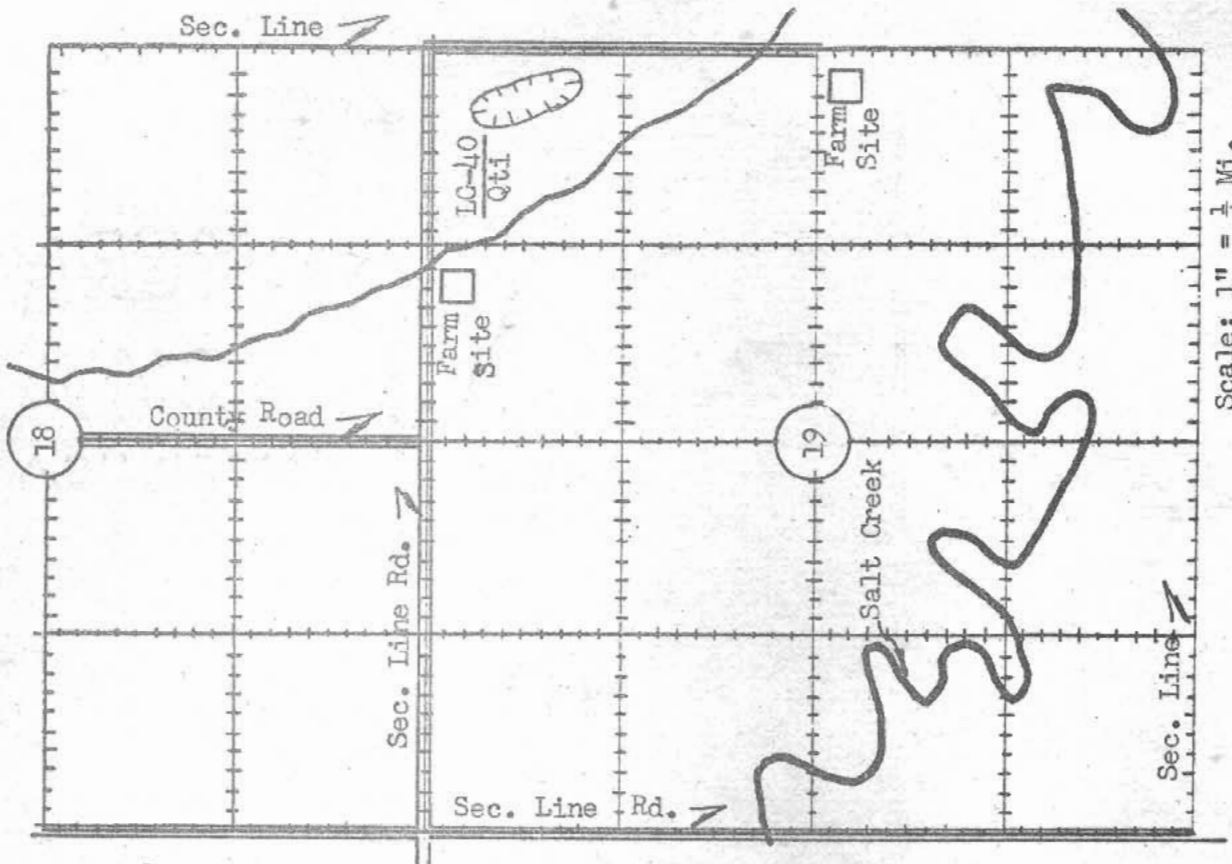

Scale: 1" =  $\frac{1}{2}$  Mi.

Test Hole	Material at Bottom of Hole	Depth of Overburden	Depth of Materials Hole	EXPLORATION DATA													
				Percent Retained													
				1/2	3/4	7/8	4	8	10	16	30	40	50	100	200	Wash	P.L.

CORRELATION DATA

GEOLOGICAL AGE Pleistocene GEOLOGICAL SOURCE High stream terrace

MATERIAL SIMILAR TO \_\_\_\_\_

REMARKS: \_\_\_\_\_

\_\_\_\_\_

\_\_\_\_\_

\_\_\_\_\_



STATE HIGHWAY COMMISSION OF KANSAS  
MATERIAL SURVEY REPORT

SITE NO. LG-41  
Qtl

MATERIAL Limestone Gravel

DATE January, 1964

COUNTY Mitchell

LOCATION SE $\frac{1}{4}$ , SE $\frac{1}{4}$  SEC. 18 TWP. 9S RANGE 7W

OWNER Alvena Rhode McKinnie Beloit, Kansas

TENANT \_\_\_\_\_ address \_\_\_\_\_

NATURE OF DEPOSIT Dry ACCESSIBILITY Good

STATUS OF SITE Open site; not sampled

EXPLORATION DATA

Test Hole at Bottom of Hole	Depth of Overburden	Depth of Materials Hole	Percent Retained											Wash No. 200	L.L. P.L.			
			1/2	3/4	7/8	4	8	10	16	30	40	50	100			200		

CORRELATION DATA

GEOLOGICAL AGE Pleistocene GEOLOGICAL SOURCE High stream terrace

MATERIAL SIMILAR TO \_\_\_\_\_

REMARKS: \_\_\_\_\_

\_\_\_\_\_

\_\_\_\_\_

\_\_\_\_\_

\_\_\_\_\_

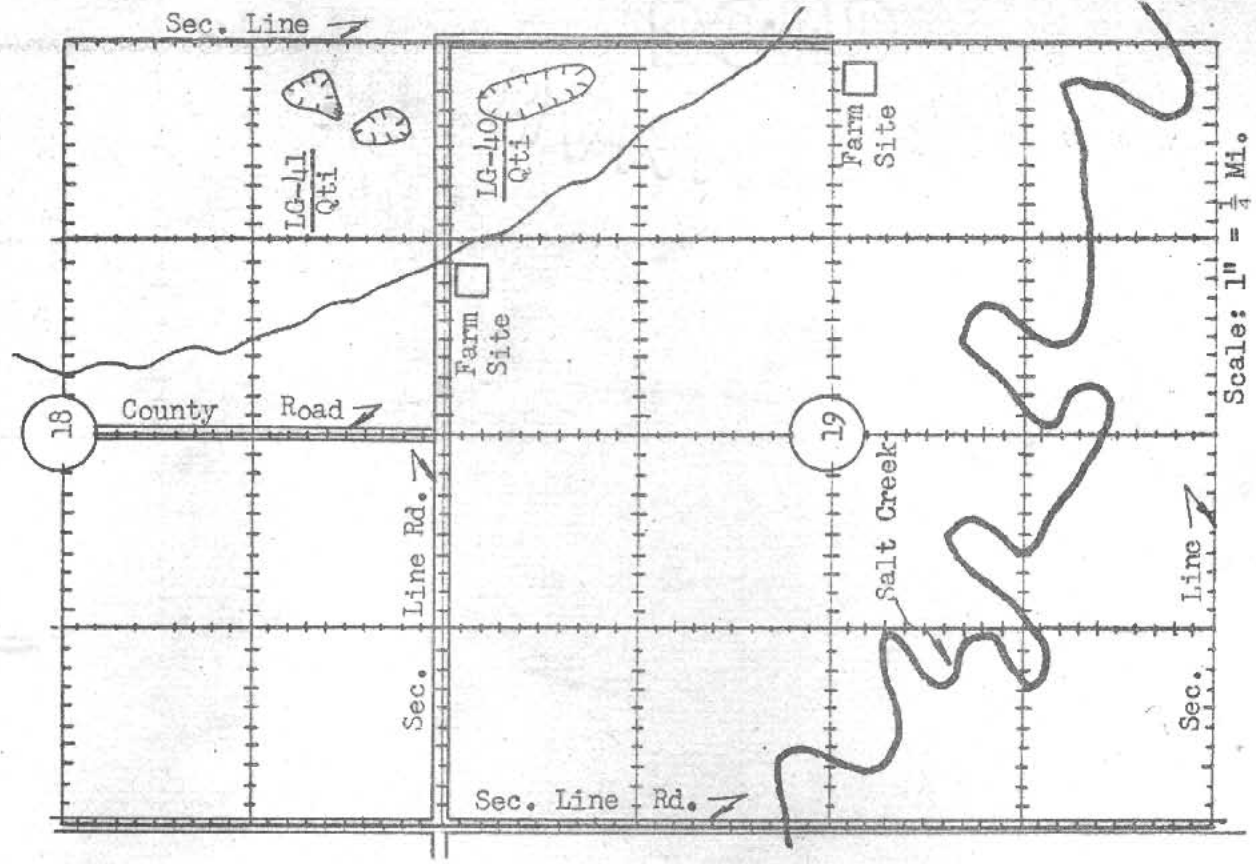

STATE HIGHWAY COMMISSION OF KANSAS  
MATERIAL SURVEY REPORT

IG-42  
Qti

SITE NO. \_\_\_\_\_ DATE January, 1964  
 MATERIAL Limestone Gravel COUNTY Mitchell  
 LOCATION SE 1/4 SEC. 14 TWP. 9S RANGE 8W  
 OWNER Joyce A. Vanier Brookville, Kansas  
 name address  
 TENANT \_\_\_\_\_ address \_\_\_\_\_  
 NATURE OF DEPOSIT Dry ACCESSIBILITY Fair  
 STATUS OF SITE Open site; not sampled

EXPLORATION DATA

Test Hole	Material at Bottom of Hole	Depth of Over-burden	Depth of Materials Hole	Depth of Hole	Percent Retained											Wash 200	L.L	P.L
					1/2	3/4	7/8	4	8	10	16	30	40	50	100			
					1/2	3/4	7/8	4	8	10	16	30	40	50	100	200	L.L	P.L

CORRELATION DATA

GEOLOGICAL AGE Pleistocene GEOLOGICAL SOURCE High stream terrace  
 MATERIAL SIMILAR TO \_\_\_\_\_

REMARKS: This site may be expanded to the west as indicated.

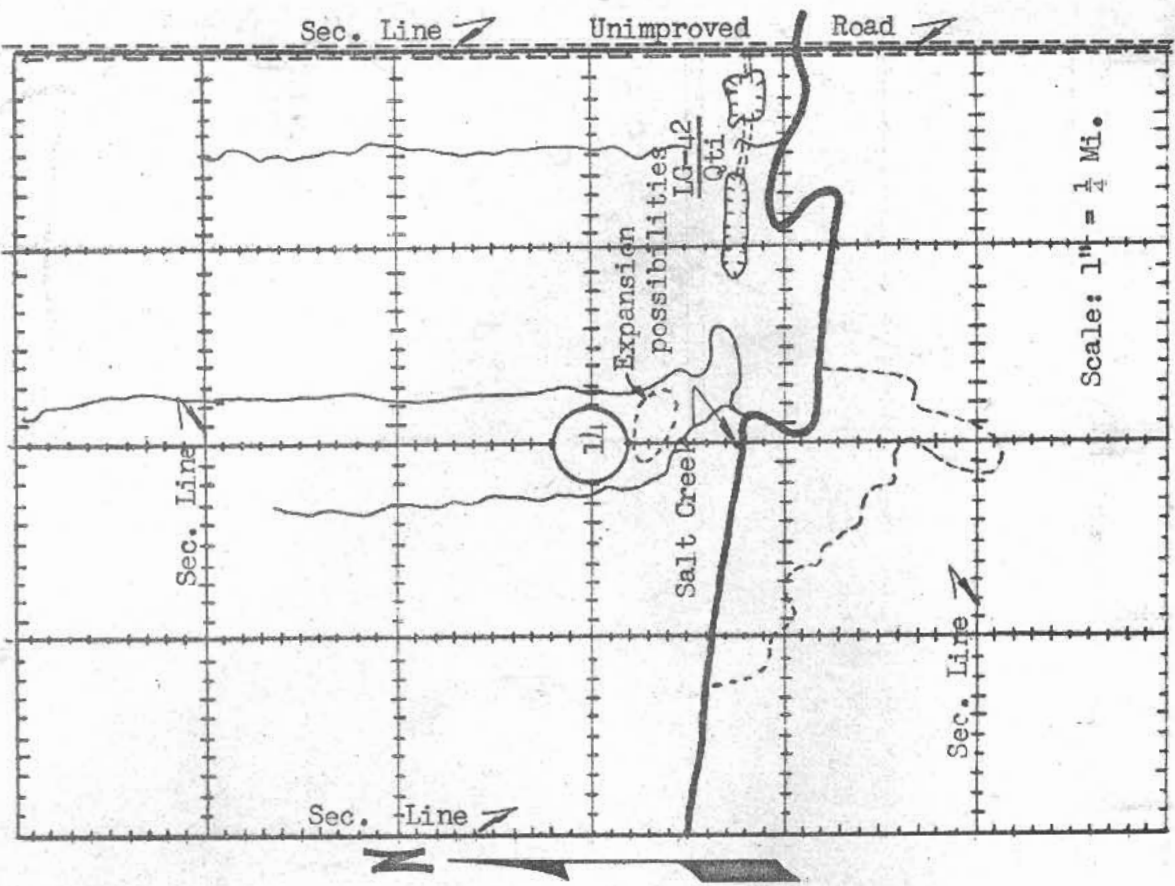



STATE HIGHWAY COMMISSION OF KANSAS

MATERIAL SURVEY REPORT

SITE NO. SG-43 DATE January, 1964  
Qa1  
 MATERIAL Sand and Gravel COUNTY Mitchell  
 LOCATION SW $\frac{1}{4}$  SEC. 36 TWP. 6S RANGE 9W  
 OWNER Paul & Helen Mears Beloit, Kansas  
 name address  
 TENANT \_\_\_\_\_ address \_\_\_\_\_  
 NATURE OF DEPOSIT Wet ACCESSIBILITY Good  
 STATUS OF SITE Open site; not sampled

Test Hole	Material at Bottom of Hole	Depth of Overburden	Depth of Materials Hole	EXPLORATION DATA																			
				Percent Retained																			
				1/2	3/4	1	1 1/8	1 1/4	1 1/2	2	3	4	6	10	16	30	40	50	100	200	L.L.	P.L.	

CORRELATION DATA

GEOLOGICAL AGE Recent GEOLOGICAL SOURCE River flood plain  
 MATERIAL SIMILAR TO \_\_\_\_\_

REMARKS: This site is currently inactive.

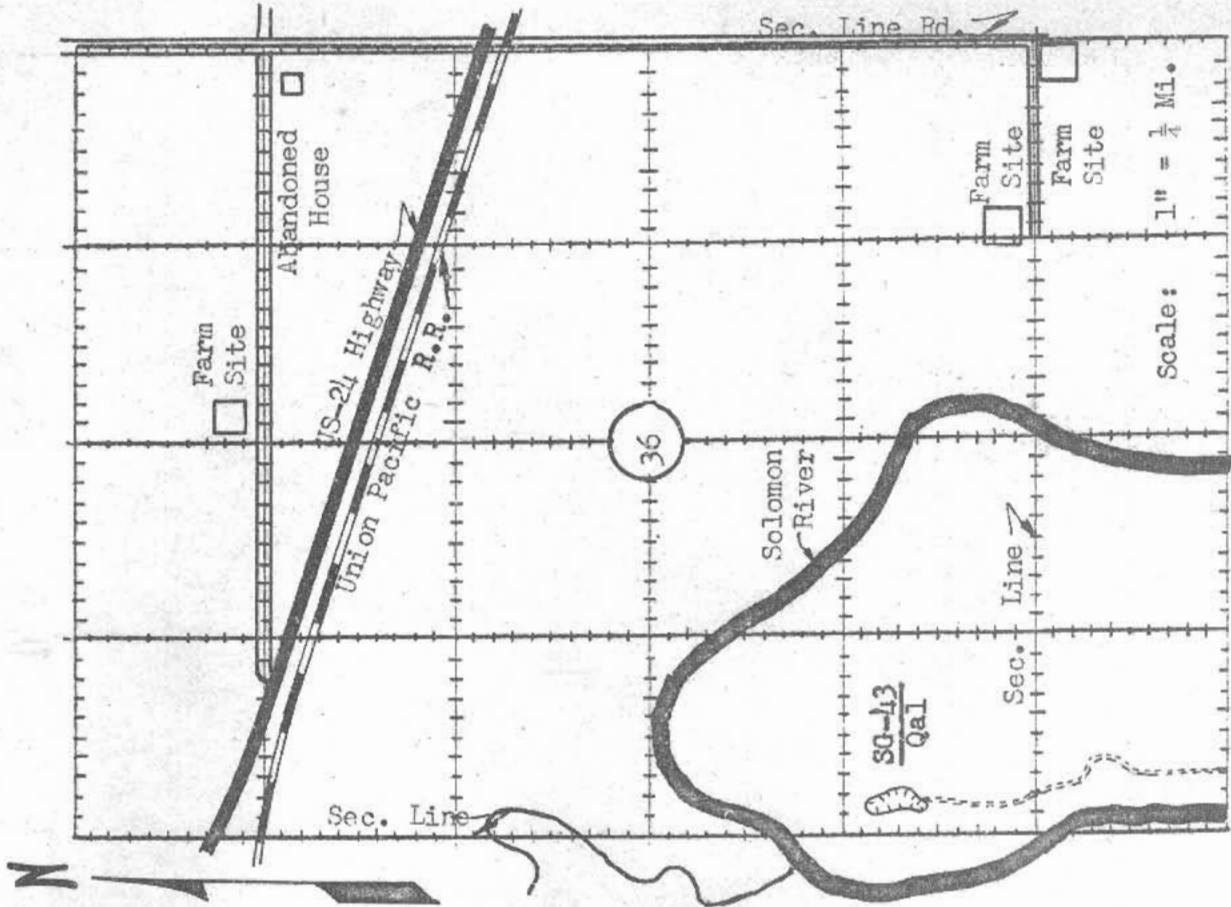







STATE HIGHWAY COMMISSION OF KANSAS  
MATERIAL SURVEY REPORT

IG-45  
Qti

SITE NO. \_\_\_\_\_ DATE January, 1964  
 MATERIAL Limestone Gravel COUNTY Mitchell  
 LOCATION SW $\frac{1}{4}$  SEC. 13 TWP. 9S RANGE 8W  
 OWNER Louise and Minnie Thiessen address Beloit, Kansas  
 TENANT \_\_\_\_\_ name \_\_\_\_\_ address \_\_\_\_\_  
 NATURE OF DEPOSIT Dry ACCESSIBILITY Good  
 STATUS OF SITE Open site; not sampled

Test Hole	Material at Bottom of Hole	Depth of Overburden	Depth of Material Hole	Depth of Hole	EXPLORATION DATA											
					Percent Retained											
					1/2	3/4	7/8	4	8	16	30	40	50	100	200	PI

CORRELATION DATA  
 GEOLOGICAL AGE Pleistocene GEOLOGICAL SOURCE High stream terrace  
 MATERIAL SIMILAR TO \_\_\_\_\_

REMARKS: \_\_\_\_\_  
 \_\_\_\_\_  
 \_\_\_\_\_  
 \_\_\_\_\_

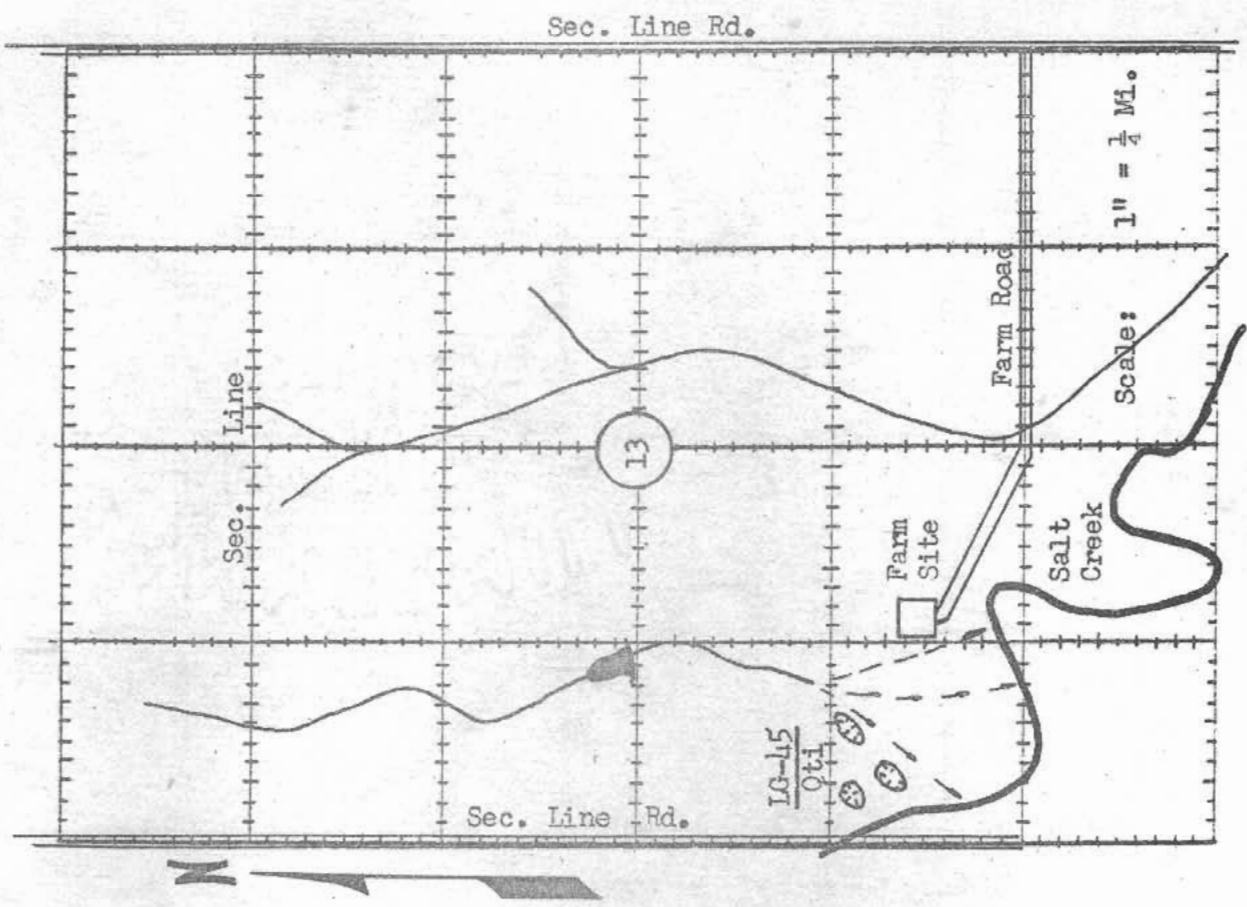





APPENDIX II

The following site data forms are designated as "open site; sampled." The sites described herein are depicted on the county materials maps as a "■".

LEGEND



This symbol on the site data form represents an open site.

STATE HIGHWAY COMMISSION OF KANSAS  
MATERIAL SURVEY REPORT

IG-47  
Qti

SITE NO. \_\_\_\_\_ DATE January, 1964  
 MATERIAL Limestone Gravel COUNTY Mitchell  
 LOCATION SE $\frac{1}{2}$  SEC. 3 TWP. 7S RANGE 7W  
 OWNER Marion File Beloit, Kansas  
 TENANT \_\_\_\_\_  
 NATURE OF DEPOSIT Dry ACCESSIBILITY Good  
 STATUS OF SITE Open site; sampled

EXPLORATION DATA

Test Hole	Material at Bottom of Hole	Depth of Overburden	Depth of Material	Depth of Hole	Percent Retained											
					1/2	3/4	1	4	8	16	30	40	50	100	200	Wash
Lab No. 10983						1	4	8	11	26	53	80	88	11		

CORRELATION DATA

GEOLOGICAL AGE Pleistocene GEOLOGICAL SOURCE High stream terrace  
 MATERIAL SIMILAR TO material reported on SHC Lab Sheet No. 10983

REMARKS: Specific Gravity 2.55  
Wt./Cu.Ft. 105.16  
LA Wear Grading "C" 36.9  
Soundness 0.90

This material is a limestone gravel resulting from the natural disintegration of calcareous rocks.

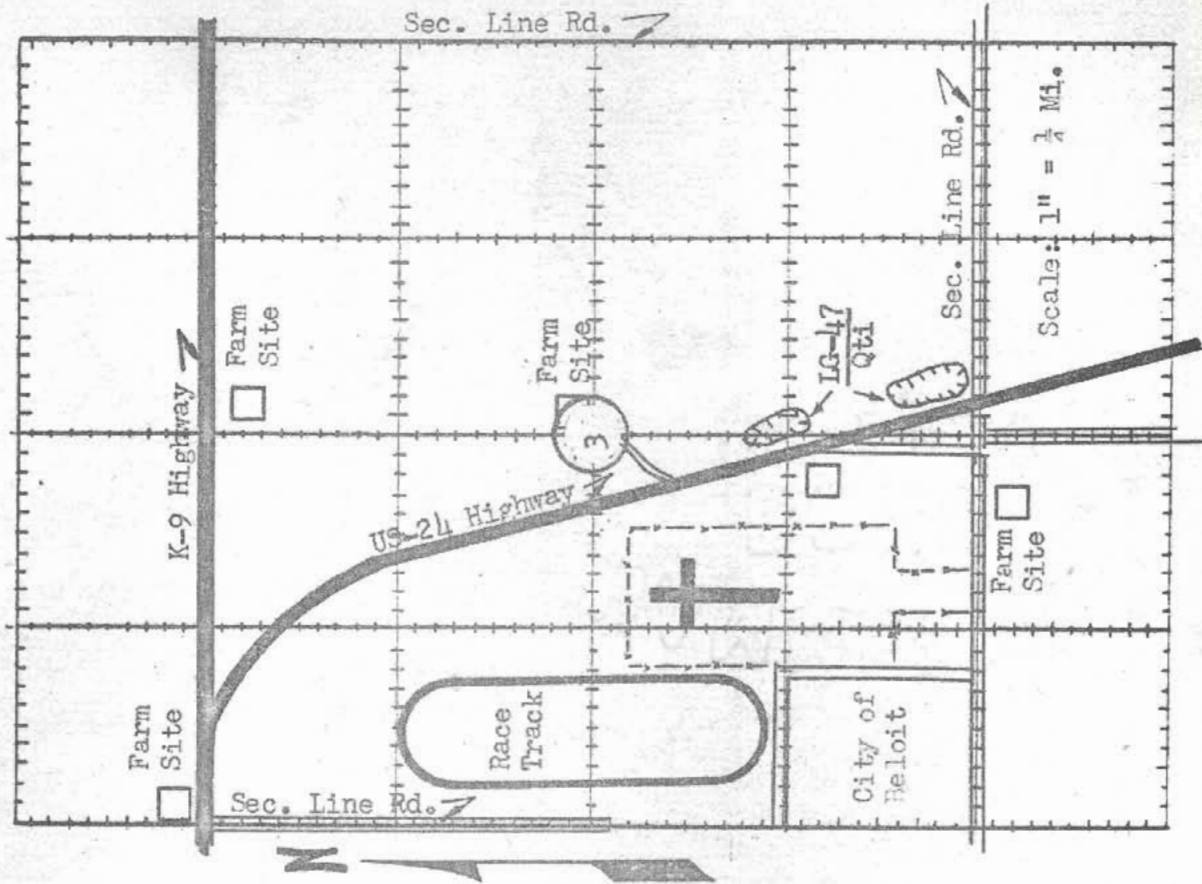





STATE HIGHWAY COMMISSION OF KANSAS  
MATERIAL SURVEY REPORT

SITE NO. S-49 / Qti DATE January, 1964  
 MATERIAL Sand COUNTY Mitchell  
 LOCATION SE $\frac{1}{2}$ , SE $\frac{1}{4}$  SEC. 31 TWP. 6S RANGE 9W  
 OWNER Carmen Harrison 302 Ash Ave. McAllen, Texas  
 name address  
 TENANT \_\_\_\_\_ name address \_\_\_\_\_  
 NATURE OF DEPOSIT Dry ACCESSIBILITY Good  
 STATUS OF SITE Open site; sampled

EXPLORATION DATA

Test Hole	Material at Bottom of Hole	Depth of Overburden	Depth of Materials Hole	Depth of Hole	Percent Retained										Wash 200	P.I.	
					1/2	3/4	7/8	4	8	10	16	30	40	50			100
AV.	CLAY	3.3	12.7	17.2					0	3	30	52	78	94	5	17	1

CORRELATION DATA

GEOLOGICAL AGE Pleistocene GEOLOGICAL SOURCE High stream terrace  
 MATERIAL SIMILAR TO material reported on SHC Form 619, No. 62-5

REMARKS: \_\_\_\_\_  
 \_\_\_\_\_  
 \_\_\_\_\_  
 \_\_\_\_\_





STATE HIGHWAY COMMISSION OF KANSAS  
MATERIAL SURVEY REPORT

SITE NO. SG+50 / Qal DATE January, 1964  
 MATERIAL Sand and Gravel COUNTY Mitchell  
 LOCATION SE 1/4 SEC. 34 TWP. 6S RANGE LOW  
 OWNER H. H. Shearer same address Cawker City, Kansas  
 TENANT \_\_\_\_\_ name \_\_\_\_\_ address \_\_\_\_\_  
 NATURE OF DEPOSIT Wet ACCESSIBILITY Fair  
 STATUS OF SITE Open site; sampled

Test Hole	Material at Bottom of Hole	Lab. No.	Depth of Overburden	Depth of Materials Hole	Depth of Hole	EXPLORATION DATA												
						1 1/2	3/4	3/8	4	8	10	16	30	40	50	100	200	Wash
						1 1/2	3/4	3/8	4	8	10	16	30	40	50	100	200	Wash
						0	4	19	49	92	99	100	100	100	100	0		

CORRELATION DATA

GEOLOGICAL AGE Recent GEOLOGICAL SOURCE River flood plain  
 MATERIAL SIMILAR TO material reported on SHC Form 619, No. 62-2

REMARKS: Specific Gravity 2.59  
LA Wear Grading "D" 33.4  
Soundness 0.91

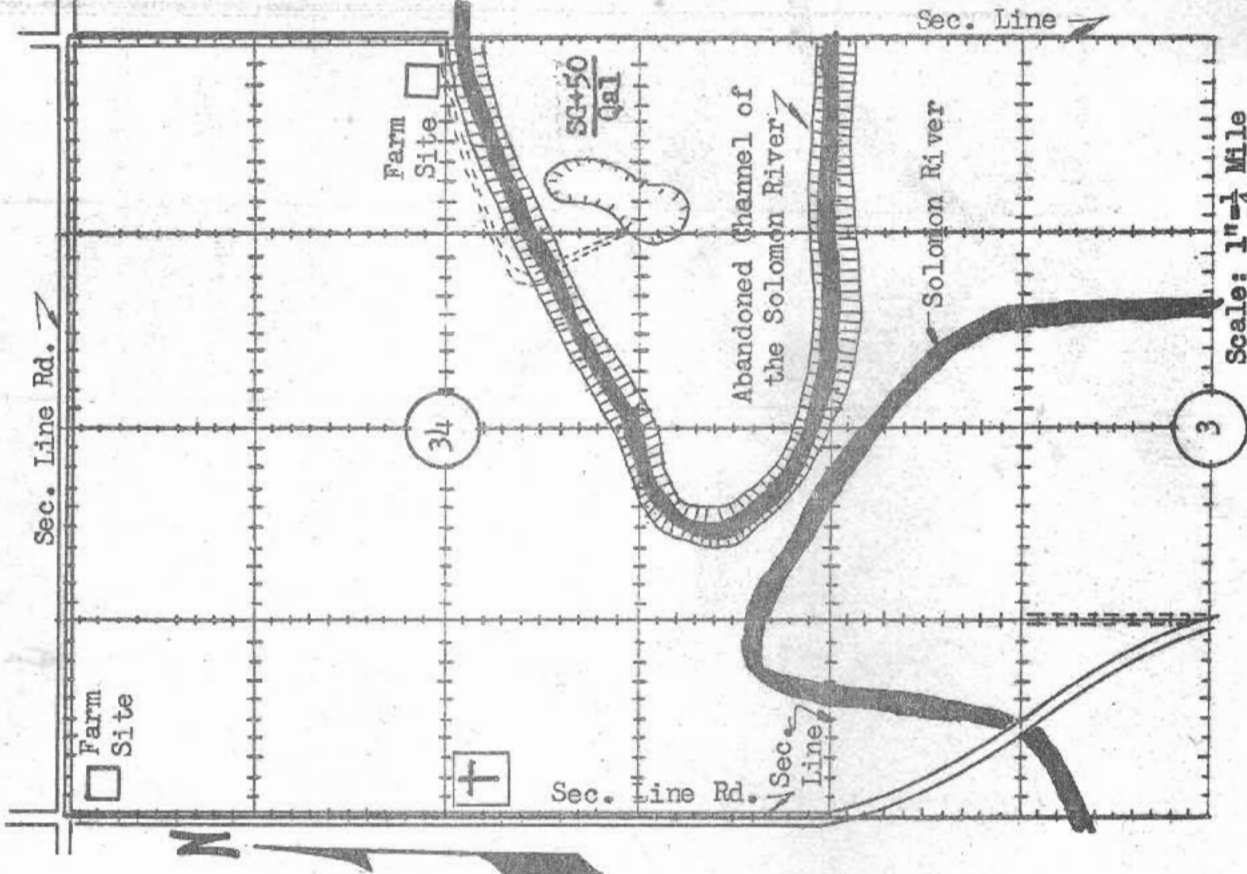





STATE HIGHWAY COMMISSION OF KANSAS  
MATERIAL SURVEY REPORT

SITE NO. IG-52  
Qtr  
MATERIAL Limestone Gravel  
LOCATION SE 1/4 SEC. 8 TWP. 7S RANGE LOW  
OWNER Joseph Stroh  
name  
TENANT \_\_\_\_\_  
name  
NATURE OF DEPOSIT Dry ACCESSIBILITY Good  
STATUS OF SITE Open site; sampled

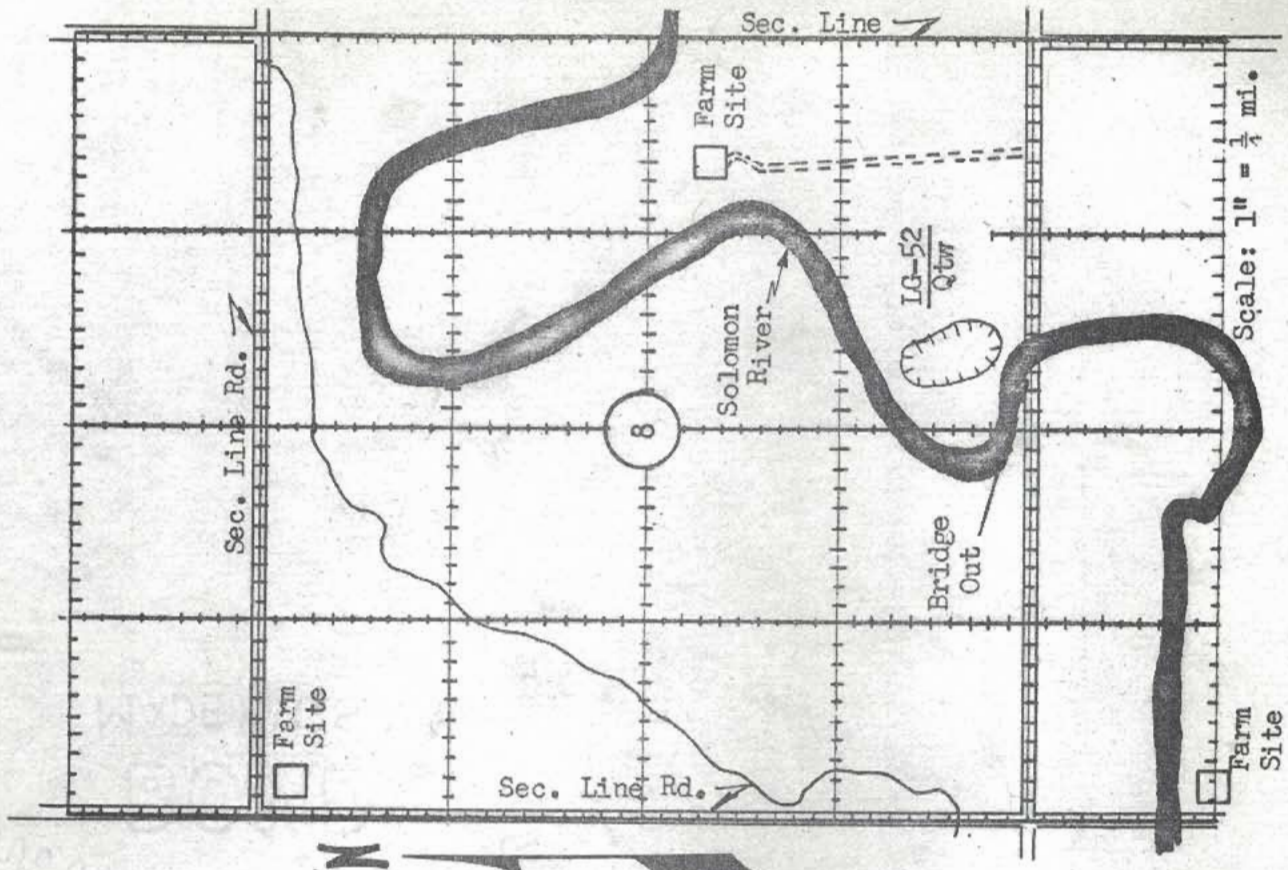

EXPLORATION DATA

Test Hole	Material at Bottom of Hole	Depth of Overburden	Depth of Materials Hole	Percent Retained											Wash	200	I.L.L	P.L.									
				1 1/2	3/4	3/8	4	8	10	15	30	40	50	100					200								
Lab No.	10712			0	0	3	5	8					38	76				87	87	11							

CORRELATION DATA  
GEOLOGICAL AGE Pleistocene GEOLOGICAL SOURCE River terrace  
MATERIAL SIMILAR TO material reported on SHG Lab Sheet No. 10712  
REMARKS: Material in this pit is depleted.  
Specific Gravity 2.59  
Wt/Cu.Ft. 100.31  
LA Wear Grading "D" 32.7  
Soundness 0.93

STATE HIGHWAY COMMISSION OF KANSAS  
MATERIAL SURVEY REPORT

IG-53  
Qt1

SITE NO. \_\_\_\_\_ DATE January, 1964  
 MATERIAL Limestone Gravel COUNTY Mitchell  
 LOCATION SW $\frac{1}{4}$ , SW $\frac{1}{4}$  SEC. 29 TWP. 8S RANGE LOW  
 OWNER Gerard F. Streit Tipton, Kansas  
 TENANT \_\_\_\_\_ address  
 NATURE OF DEPOSIT Dry ACCESSIBILITY Good  
 STATUS OF SITE Open site; sampled

EXPLORATION DATA

Test Hole	Material at Bottom of Hole	Depth of Over- burden	Depth of Material Hole	Depth of Hole	Percent Retained												
					1/2	3/4	1	5	10	16	30	40	50	100	200	Wash -1.18 P.S.	
Lab. No. 21265					0	1	5	41	64		75	81		84	87	11	

CORRELATION DATA

GEOLOGICAL AGE Pleistocene GEOLOGICAL SOURCE High stream terrace  
 MATERIAL SIMILAR TO material reported on SHC Lab Sheet No. 21265

REMARKS: Specific Gravity 2.50  
Wt/Cu.Ft. 100.13 Pounds  
LA Wear Grading "D" 23.7  
Soundness 0.95

This material is a mixture of clay, silt, and calcareous pebbles resulting from natural disintegration of calcareous rocks.

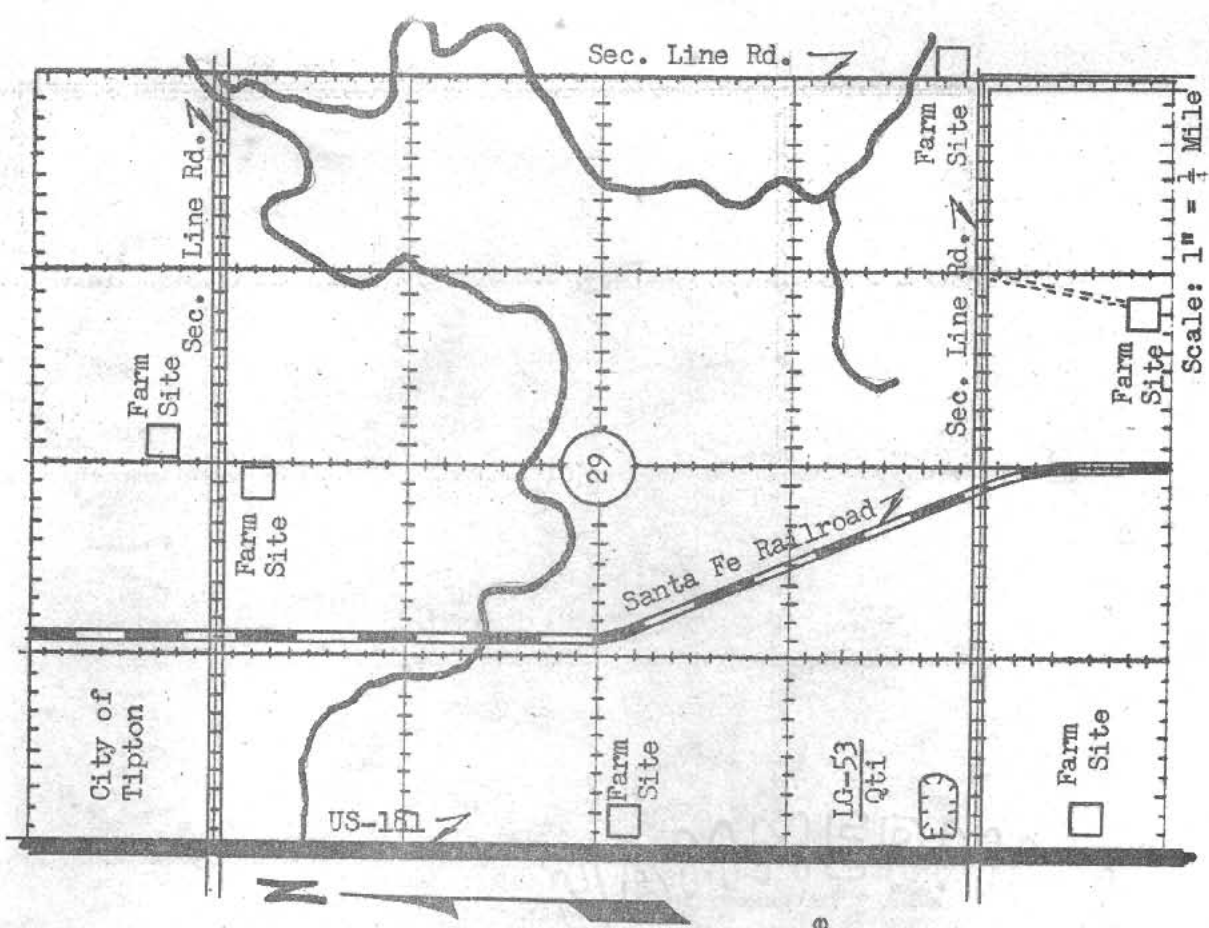



STATE HIGHWAY COMMISSION OF KANSAS  
MATERIAL SURVEY REPORT

SITE NO. LG-54 / Qtl DATE January, 1964  
 MATERIAL Limestone Gravel COUNTY Mitchell  
 LOCATION SW $\frac{1}{4}$ , SW $\frac{1}{4}$  SEC. 33 TWP. 8S RANGE 8W  
 OWNER Clarence A. Mehl Beloit, Kansas  
 TENANT \_\_\_\_\_ address \_\_\_\_\_  
 NATURE OF DEPOSIT Dry ACCESSIBILITY Good  
 STATUS OF SITE Open site; sampled

Test Hole	Material at Bottom of Hole	Depth of Over-burden	Depth of Materials Hole	EXPLORATION DATA										
				Percent Retained										
Lab No.	1 1/2	3/4	7/8	4	8	10	16	30	40	50	100	200	Wash	RI
64519				2	6	19	37	58	76	86	89	9		

CORRELATION DATA

GEOLOGICAL AGE Pleistocene GEOLOGICAL SOURCE Stream terrace  
 MATERIAL SIMILAR TO material reported on SHC Form 619, Mitchell  
 County No. 1  
 REMARKS: LA Wear Grading "D" 31.8  
Soundness 0.87  
This material consists of a mixture of gravel and binder resulting from the natural disintegration of calcareous rocks.

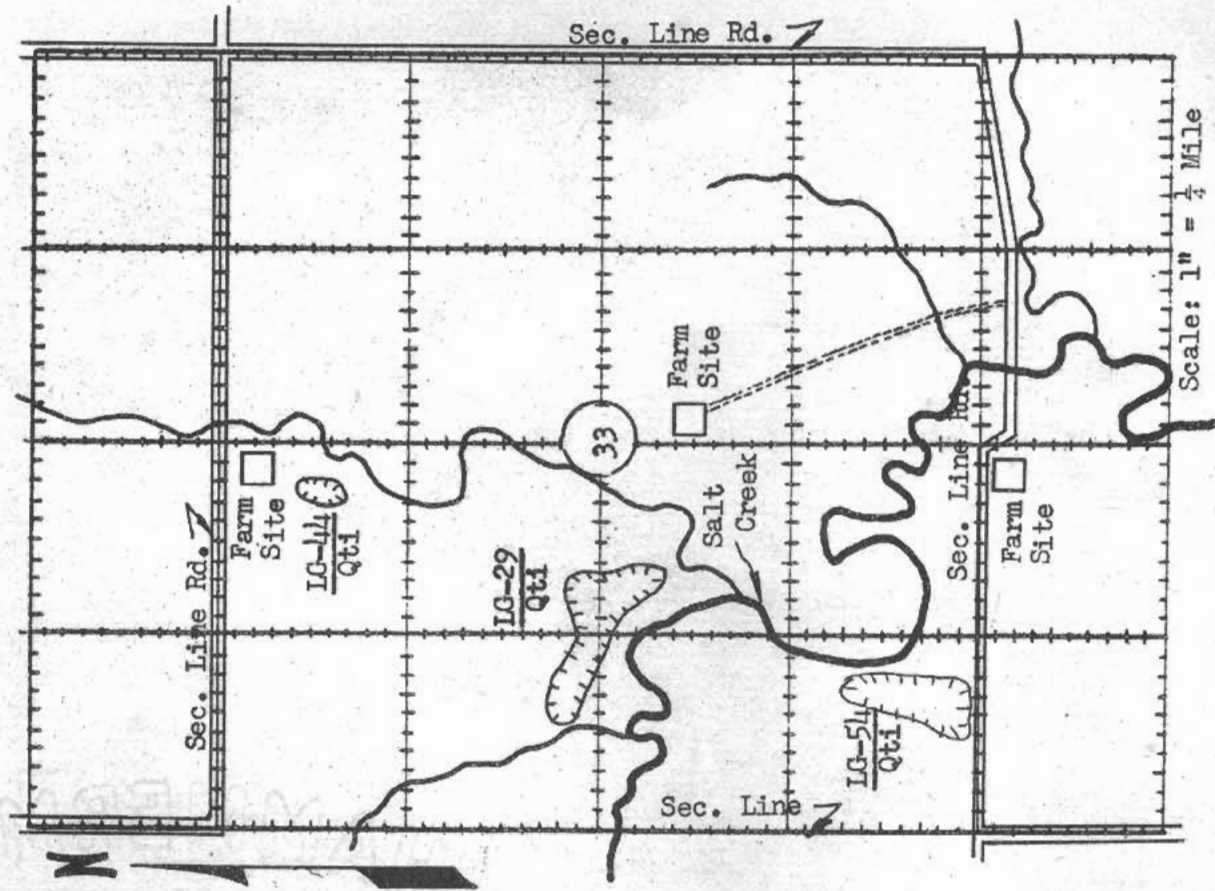



STATE HIGHWAY COMMISSION OF KANSAS  
MATERIAL SURVEY REPORT

SITE NO. IG+55  
Qti  
DATE January, 1964

MATERIAL Limestone Gravel COUNTY Mitchell

LOCATION NE 1/4, SE 1/4 SEC. 29 TWP. 6S RANGE 8W

OWNER Frank Kirgils Beloit, Kansas  
address

TENANT \_\_\_\_\_ address \_\_\_\_\_

NATURE OF DEPOSIT Dry ACCESSIBILITY Good

STATUS OF SITE Open site; sampled

Test Hole	Material at Bottom of Hole	Depth of Overburden	Depth of Materials	Depth of Hole	EXPLORATION DATA											
					Percent Retained											
Lab. No.	No.	1 1/2	3/4	3/8	4	8	10	16	30	40	50	100	200	Wash	Pt.	
23682		0	2	5	9	23	59	88	95	95	95	95	95	95	95	
18736		1	3	7	11	25	59	89	95	95	95	95	95	95	95	

CORRELATION DATA

GEOLOGICAL AGE Pleistocene GEOLOGICAL SOURCE High stream terrace

MATERIAL SIMILAR TO material reported on SHC Lab. Sheet No. 23682 and 18736.

REMARKS: \_\_\_\_\_ No. 23682 No. 18736

Specific Gravity 2.59 2.58

Wt./Cu. Ft. 105.8 109.0

LA Wear Grading "D" 36.6 34.5

Soundness 0.86 0.87

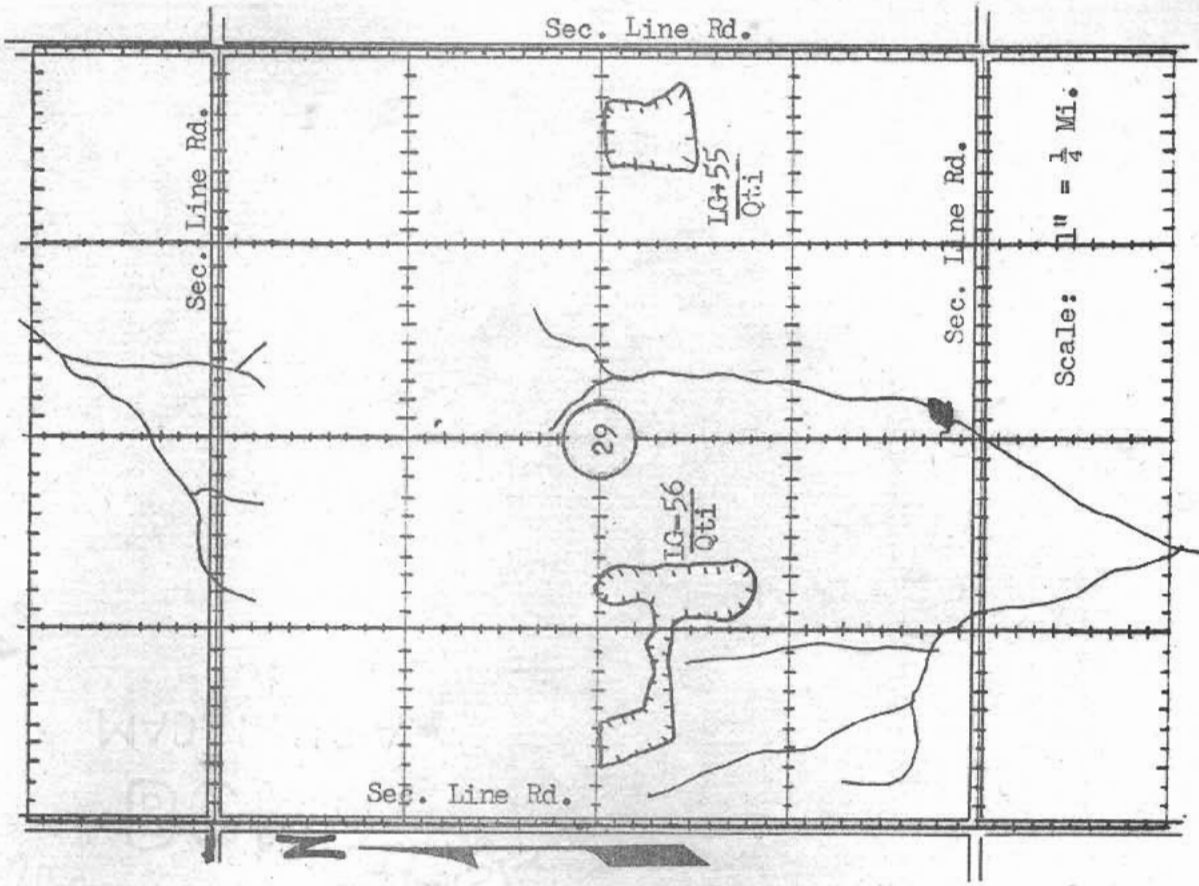



STATE HIGHWAY COMMISSION OF KANSAS  
MATERIAL SURVEY REPORT

SITE NO. IG-56  
Qti DATE January, 1964  
MATERIAL Limestone Gravel COUNTY Mitchell  
LOCATION SW $\frac{1}{4}$  SEC. 29 TWP. 6S RANGE 8W  
OWNER Mary & Josephine Stover Beloit, Kansas  
TENANT \_\_\_\_\_ address \_\_\_\_\_  
NATURE OF DEPOSIT Dry ACCESSIBILITY Good  
STATUS OF SITE Open site; sampled

Test Hole of Hole	Material of Bottom of Hole	Depth of Overburden	Depth of Materials	Depth of Hole	EXPLORATION DATA												
					1 1/2	3/4	3/8	4	8	10	16	30	40	50	100	200	Wash
AV					1	4	7	13			31	61	91	93	6		

CORRELATION DATA  
GEOLOGICAL AGE Pleistocene GEOLOGICAL SOURCE High stream terrace  
MATERIAL SIMILAR TO material reported on SHC Form 619, Mitchell  
County No. 2  
REMARKS: Very heavy overburden has been encountered in this site.

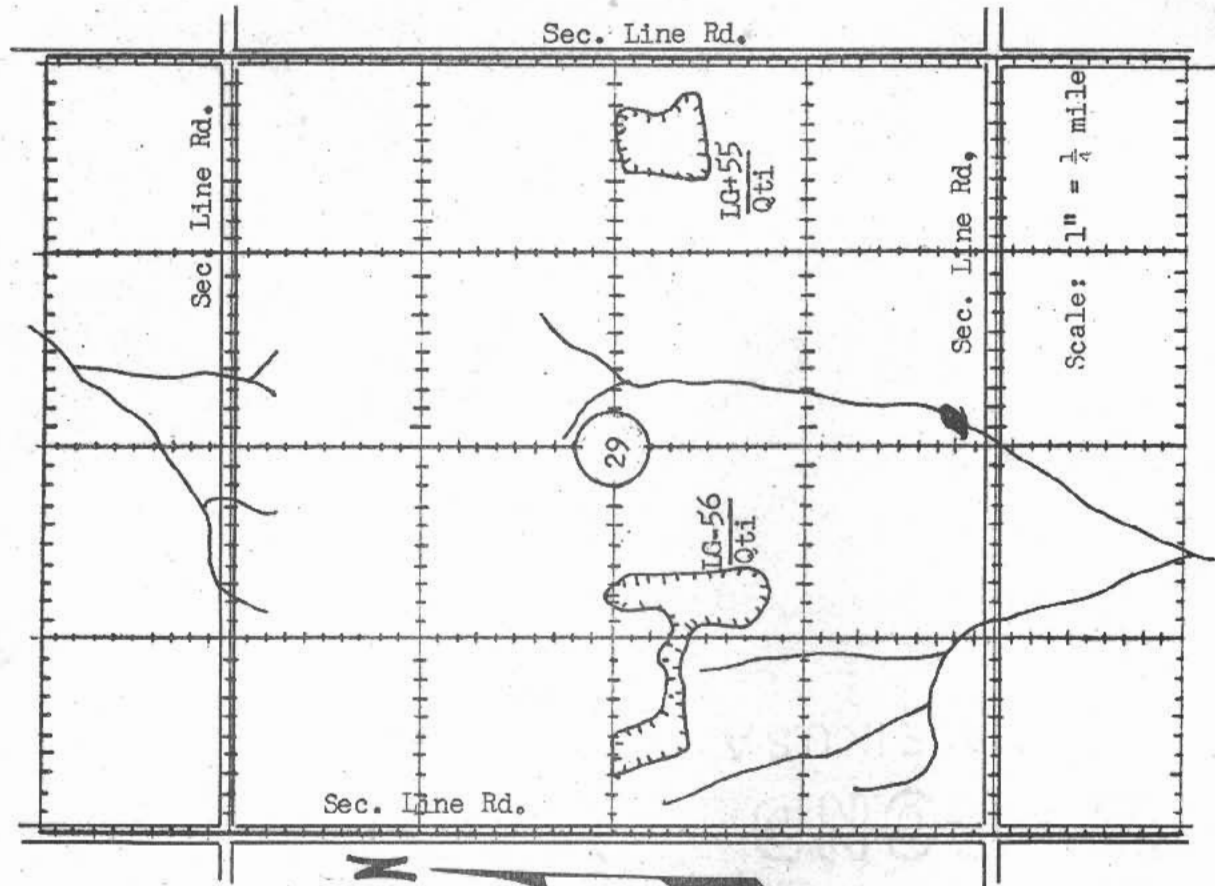

APPENDIX III

The following site data forms are designated as "prospective site; sampled." The sites described herein are depicted on the county materials map as a "▼".

LEGEND

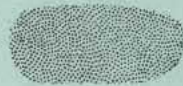

This symbol on the site data form represents a prospective site.



STATE HIGHWAY COMMISSION OF KANSAS  
MATERIAL SURVEY REPORT

S+57  
Q<sub>tw</sub>

SITE NO. \_\_\_\_\_ DATE January, 1964  
 MATERIAL Sand COUNTY Mitchell  
 LOCATION SE $\frac{1}{4}$ , SE $\frac{1}{4}$  SEC. 26 TWP. 6S RANGE 9W  
 OWNER Frank Nash Glen Elder, Kansas  
 name address  
 TENANT \_\_\_\_\_ address \_\_\_\_\_  
 NATURE OF DEPOSIT Dry ACCESSIBILITY Good  
 STATUS OF SITE Prospective site; sampled

Test Hole	Material at Bottom of Hole	Depth of Overburden	Depth of Material	Depth of Hole	EXPLORATION DATA											Wash	L.L.	P.I.	
					Percent Retained														
AV.					1 1/2	3/4	3/8	4	8	10	16	30	40	50	100	200			
					1	1	3	5	7	10	21	35	71	91	7				

CORRELATION DATA

GEOLOGICAL AGE Pleistocene GEOLOGICAL SOURCE River terrace  
 MATERIAL SIMILAR TO material reported on SHC Form 619, Location  
 No. 62-4.

REMARKS: This site was extensively explored in February, 1958 by the Kansas Highway Commission. Material was found to be extremely fine.

