

APPENDIX IV

The following site data forms are designated as "prospective site; not sampled." The sites described herein are depicted on the county materials map as a "●".

LEGEND

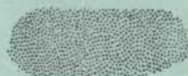

This symbol on the site data form represents a prospective site.

STATE HIGHWAY COMMISSION OF KANSAS  
MATERIAL SURVEY REPORT

SITE NO. IG-58  
Qtz1  
MATERIAL Limestone Gravel COUNTY Mitchell  
LOCATION NW $\frac{1}{4}$ , SE $\frac{1}{4}$  SEC. 11 TWP. 6S RANGE 7W  
OWNER Melvin Gengler Beloit, Kansas  
TENANT \_\_\_\_\_  
NATURE OF DEPOSIT Dry ACCESSIBILITY Good  
STATUS OF SITE Prospective site; not sampled

Test Hole	Material at Bottom of Hole	Depth of Overburden	Depth of Materials Hole	Depth of Hole	EXPLORATION DATA												
					Percent Retained												
					1 1/2	3/4	3/8	4	8	16	30	40	50	100	200	Wash	PI.

CORRELATION DATA

GEOLOGICAL AGE Pleistocene GEOLOGICAL SOURCE High stream terrace  
MATERIAL SIMILAR TO material in site IG-1 Qtz1. It may be visually inspected in the pit bank at this location.

REMARKS: \_\_\_\_\_  
\_\_\_\_\_  
\_\_\_\_\_

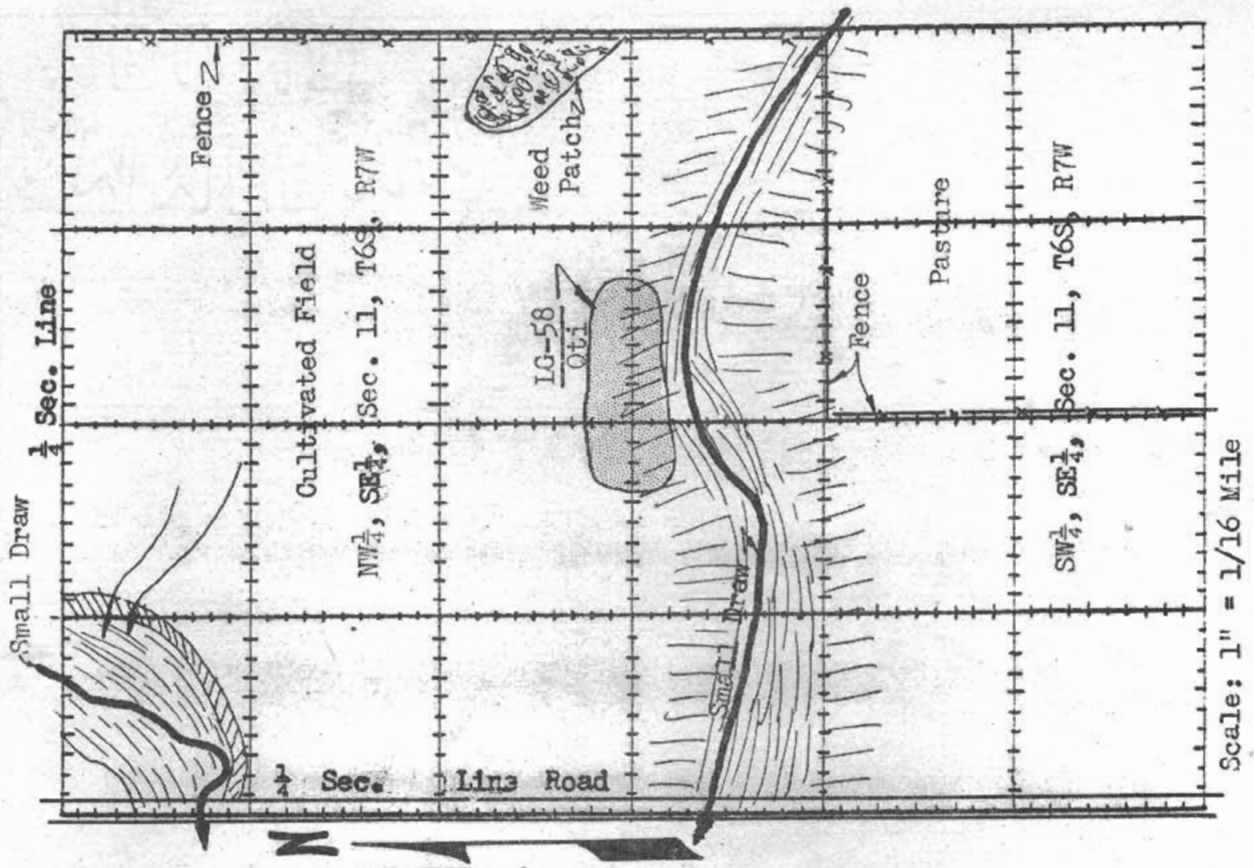















STATE HIGHWAY COMMISSION OF KANSAS  
MATERIAL SURVEY REPORT

SITE NO. IG-62  
Qtl

MATERIAL Limestone Gravel COUNTY Mitchell

LOCATION SW $\frac{1}{4}$ , SE $\frac{1}{4}$  SEC. 18 TWP. 9S RANGE 7W

OWNER Alvena Rhode McKinnie Beloit, Kansas

TENANT \_\_\_\_\_ address

NATURE OF DEPOSIT Dry ACCESSIBILITY Good

STATUS OF SITE Prospective site; not sampled

Test Hole	Material at Bottom of Hole	Depth of Overburden	Depth of Material Hole	EXPLORATION DATA																
				1/2	3/4	1	1 1/8	1 1/4	1 1/2	2	3									

CORRELATION DATA

GEOLOGICAL AGE Pleistocene GEOLOGICAL SOURCE High stream terrace  
IG-111

MATERIAL SIMILAR TO material in site IG-111. It may be visually inspected in the pit banks at this location.

REMARKS: \_\_\_\_\_  
\_\_\_\_\_  
\_\_\_\_\_

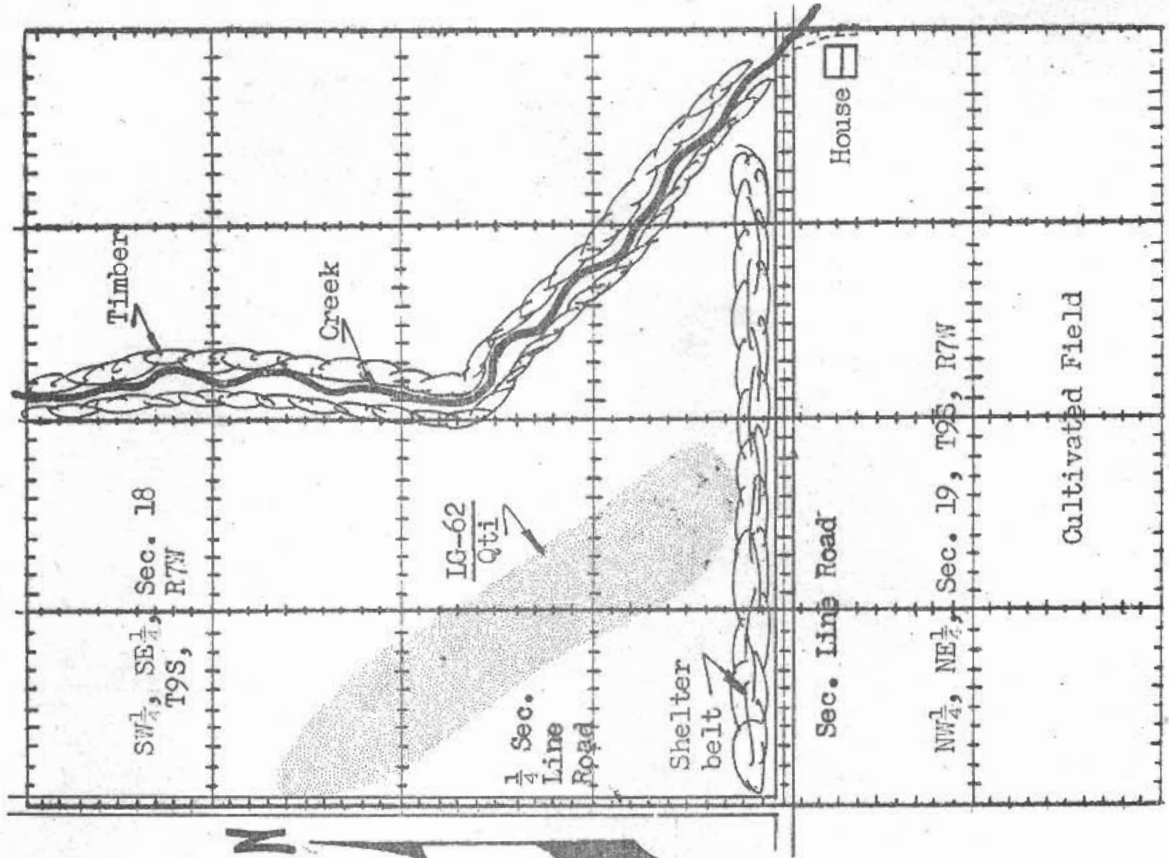

Scale: 1" = 1/16 Mile

















STATE HIGHWAY COMMISSION OF KANSAS  
MATERIAL SURVEY REPORT

SITE NO. LG-67  
Qti  
MATERIAL Limestone Gravel  
LOCATION SW $\frac{1}{4}$ , SW $\frac{1}{4}$  SEC. 10 TWP. 9S RANGE 7W  
OWNER Chester F. Simmons  
TENANT \_\_\_\_\_  
NATURE OF DEPOSIT Dry ACCESSIBILITY Good  
STATUS OF SITE Prospective site; not sampled

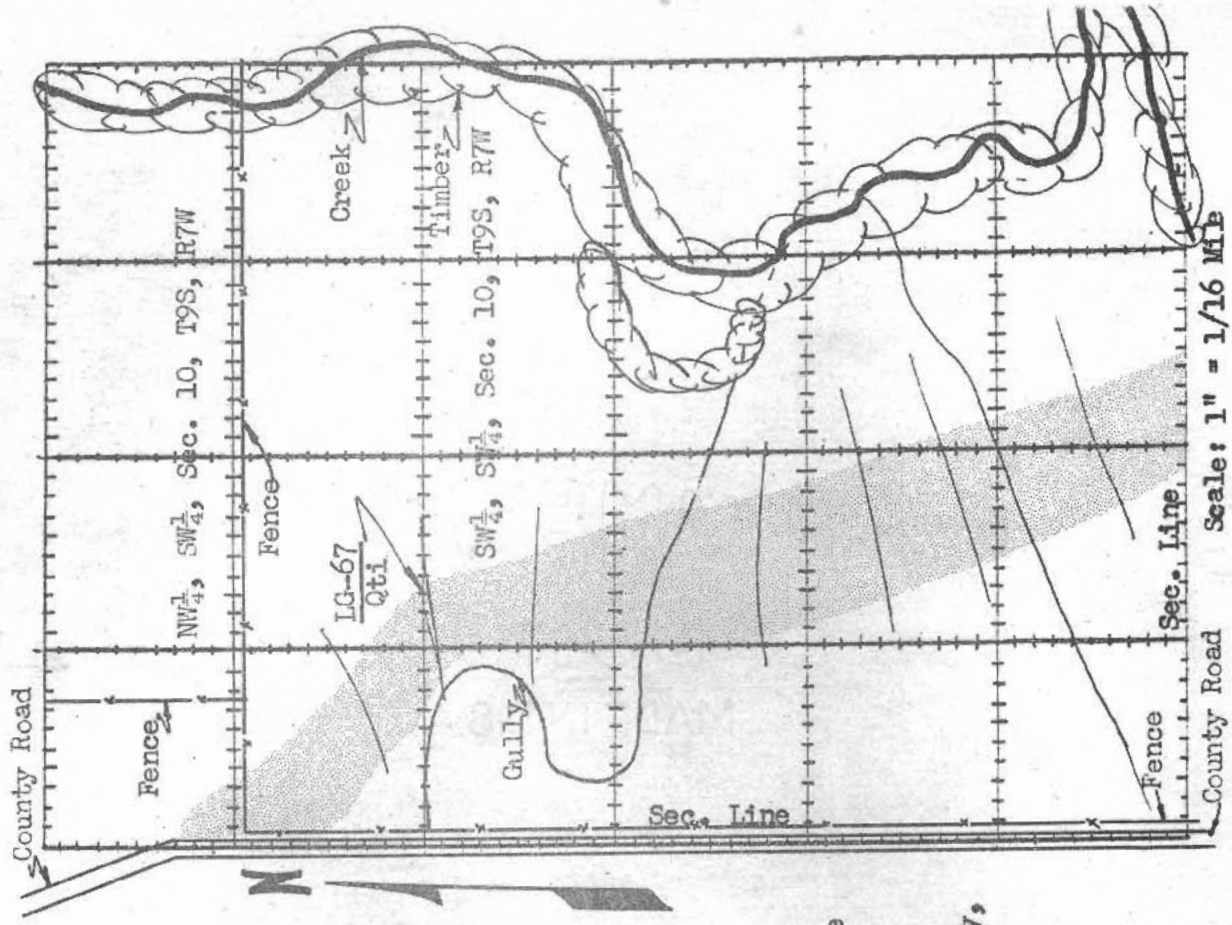

EXPLORATION DATA

Test Holes	Material at Bottom of Hole	Depth of Overburden	Depth of Material	Depth of hole	Percent Retained								Wash	P.I.				
					1 1/2	3/4	3/8	4	8	10	16	30			40	50	100	200

CORRELATION DATA  
GEOLOGICAL AGE Pleistocene GEOLOGICAL SOURCE High stream terrace  
MATERIAL SIMILAR TO \_\_\_\_\_  
REMARKS: It is expected that this material would be composed of clay, silt, and soft limestone pebbles.

















STATE HIGHWAY COMMISSION OF KANSAS  
MATERIAL SURVEY REPORT

SITE NO. 10-72  
Qtl

MATERIAL Limestone Gravel COUNTY Mitchell

LOCATION SE $\frac{1}{4}$ , SE $\frac{1}{4}$  SEC. 2 TWP. 9S RANGE 9W

OWNER Walter Way name Beloit, Kansas address

TENANT \_\_\_\_\_ name \_\_\_\_\_ address \_\_\_\_\_

NATURE OF DEPOSIT Dry ACCESSIBILITY Good

STATUS OF SITE Prospective sites; not sampled

EXPLORATION DATA

Test Holes	Material at Bottom of Hole	Depth of Overburden	Depth of Hole	Percent Retained								Wash 200	F.L.				
				1/2	3/4	1	2	4	8	16	30			40	50	100	

CORRELATION DATA

GEOLOGICAL AGE Pleistocene GEOLOGICAL SOURCE High stream terrace

MATERIAL SIMILAR TO \_\_\_\_\_

REMARKS: \_\_\_\_\_

\_\_\_\_\_

\_\_\_\_\_

\_\_\_\_\_

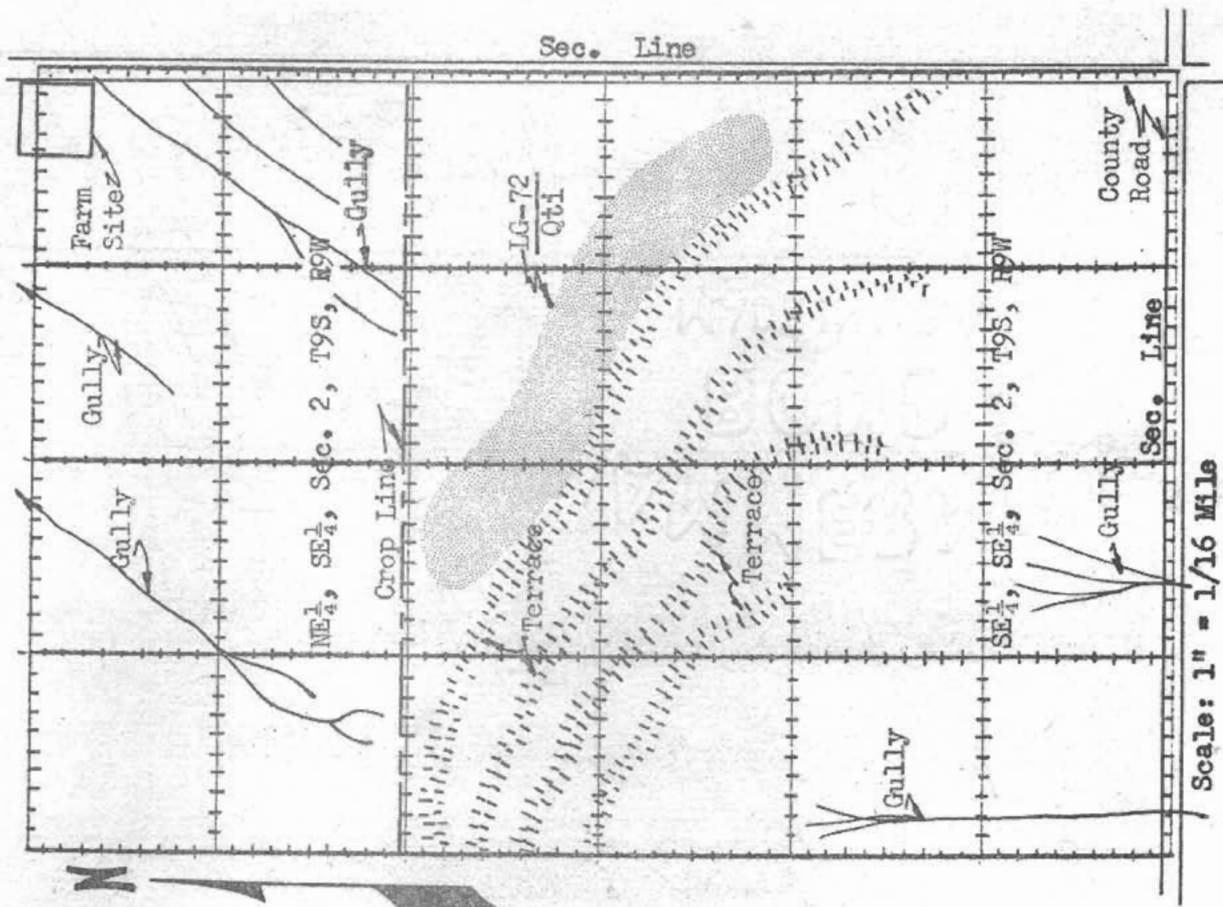

STATE HIGHWAY COMMISSION OF KANSAS  
MATERIAL SURVEY REPORT

SITE NO. LG-73  
Qtl  
MATERIAL Limestone Gravel  
LOCATION SW<sup>1</sup>/<sub>4</sub>, NW<sup>1</sup>/<sub>4</sub> SEC. 11 TWP. 9S RANGE 9W  
OWNER Bert W. Belden  
TENANT \_\_\_\_\_  
NATURE OF DEPOSIT Dry ACCESSIBILITY Good  
STATUS OF SITE Prospective site; not sampled

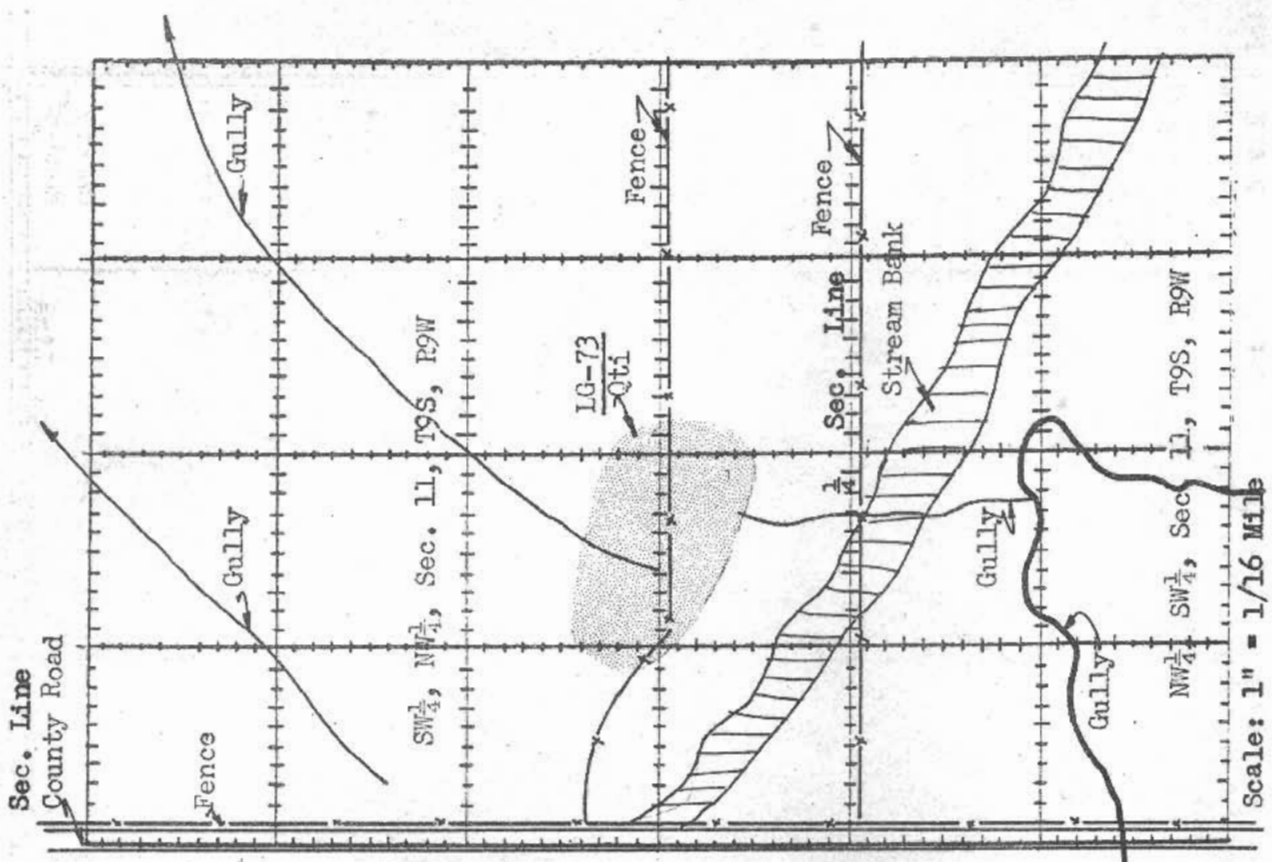

EXPLORATION DATA

Test Hole	Material at Bottom of Hole	Depth of Overburden	Depth of Materials Hole	Depth of Hole	Percent Retained										Wash	200	LL	PI	
					1/2	3/4	7/8	4	8	10	16	30	40	50					100

CORRELATION DATA

GEOLOGICAL AGE Pleistocene GEOLOGICAL SOURCE High stream terrace.

MATERIAL SIMILAR TO \_\_\_\_\_

REMARKS: \_\_\_\_\_



STATE HIGHWAY COMMISSION OF KANSAS  
MATERIAL SURVEY REPORT

SITE NO. IG-74  
Qti  
MATERIAL Limestone Gravel COUNTY Mitchell  
LOCATION SE 1/4, NE 1/4 SEC. 32 TWP. 8S RANGE 9W  
OWNER Grace Parks name Hunter, Kansas address  
TENANT \_\_\_\_\_ name \_\_\_\_\_ address \_\_\_\_\_  
NATURE OF DEPOSIT Dry ACCESSIBILITY Good  
STATUS OF SITE Prospective site; not sampled

EXPLORATION DATA

Test Hole	Material at Bottom of Hole	Depth of Overburden	Depth of Material	Percent Retained					Wash	L.L.	P.I.										
				1/2	3/4	7/8	4	8				10	16	30	40	50	100	200			

CORRELATION DATA

GEOLOGICAL AGE Pleistocene GEOLOGICAL SOURCE High stream terrace

MATERIAL SIMILAR TO \_\_\_\_\_  
REMARKS: \_\_\_\_\_  
\_\_\_\_\_  
\_\_\_\_\_

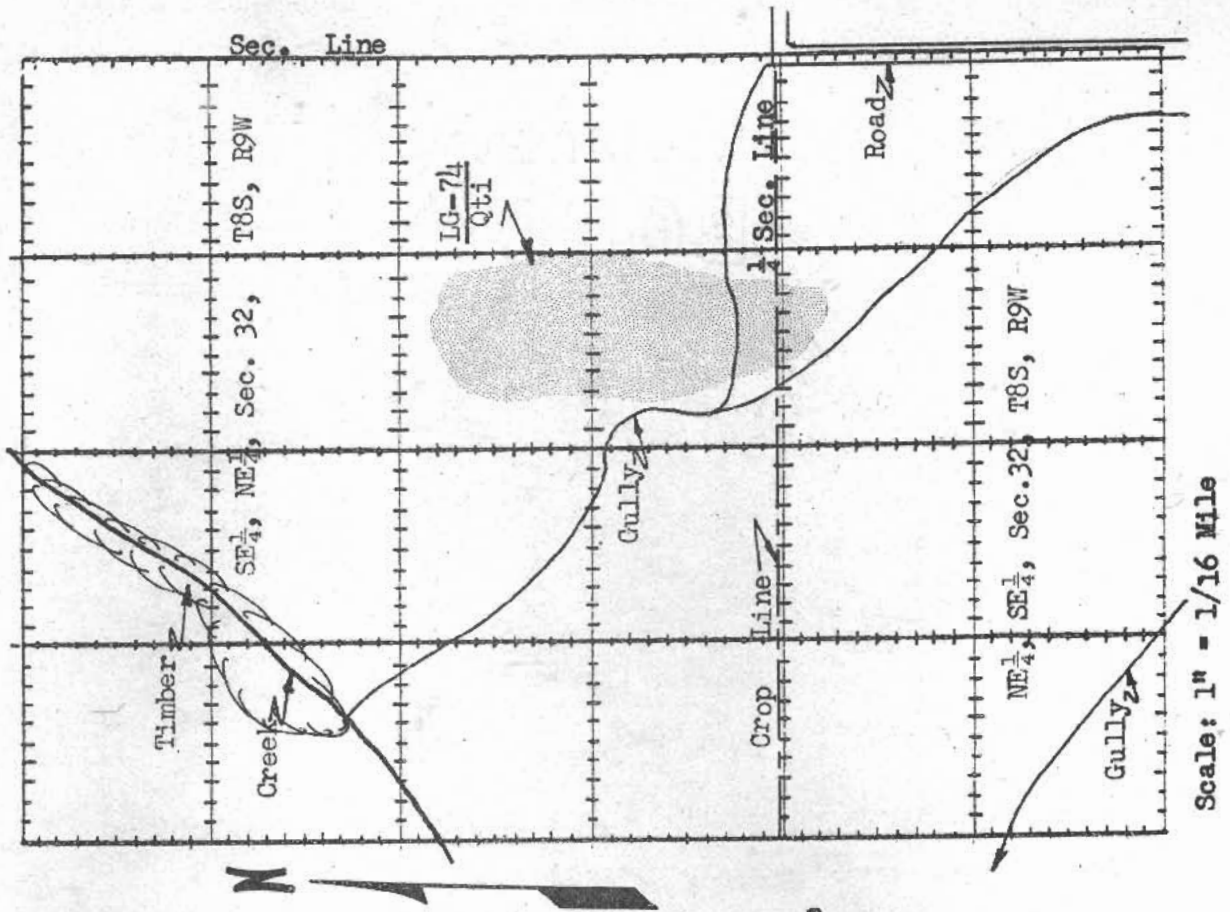

STATE HIGHWAY COMMISSION OF KANSAS  
MATERIAL SURVEY REPORT

LG-75  
Qtl

SITE NO. \_\_\_\_\_ DATE January, 1964  
 MATERIAL Limestone Gravel COUNTY Mitchell  
 LOCATION SE $\frac{1}{4}$ , SE $\frac{1}{4}$  SEC. 32 TWP. 8S RANGE 9W  
 OWNER Marie Eresch name 2131 High St. Topeka, Kansas  
 TENANT \_\_\_\_\_ name \_\_\_\_\_ address \_\_\_\_\_  
 NATURE OF DEPOSIT Dry ACCESSIBILITY Good  
 STATUS OF SITE Prospective site; not sampled

EXPLORATION DATA

Test Hole	Material at Bottom of Hole	Depth of Overburden	Depth of Materials Hole	Percent Retained																		
				1/2	3/4	7/8	4	8	10	16	30	40	50	100	200	Wash	P.I.					

CORRELATION DATA

GEOLOGICAL AGE Pleistocene GEOLOGICAL SOURCE High stream terrace  
 MATERIAL SIMILAR TO \_\_\_\_\_

REMARKS: \_\_\_\_\_  
 \_\_\_\_\_  
 \_\_\_\_\_  
 \_\_\_\_\_

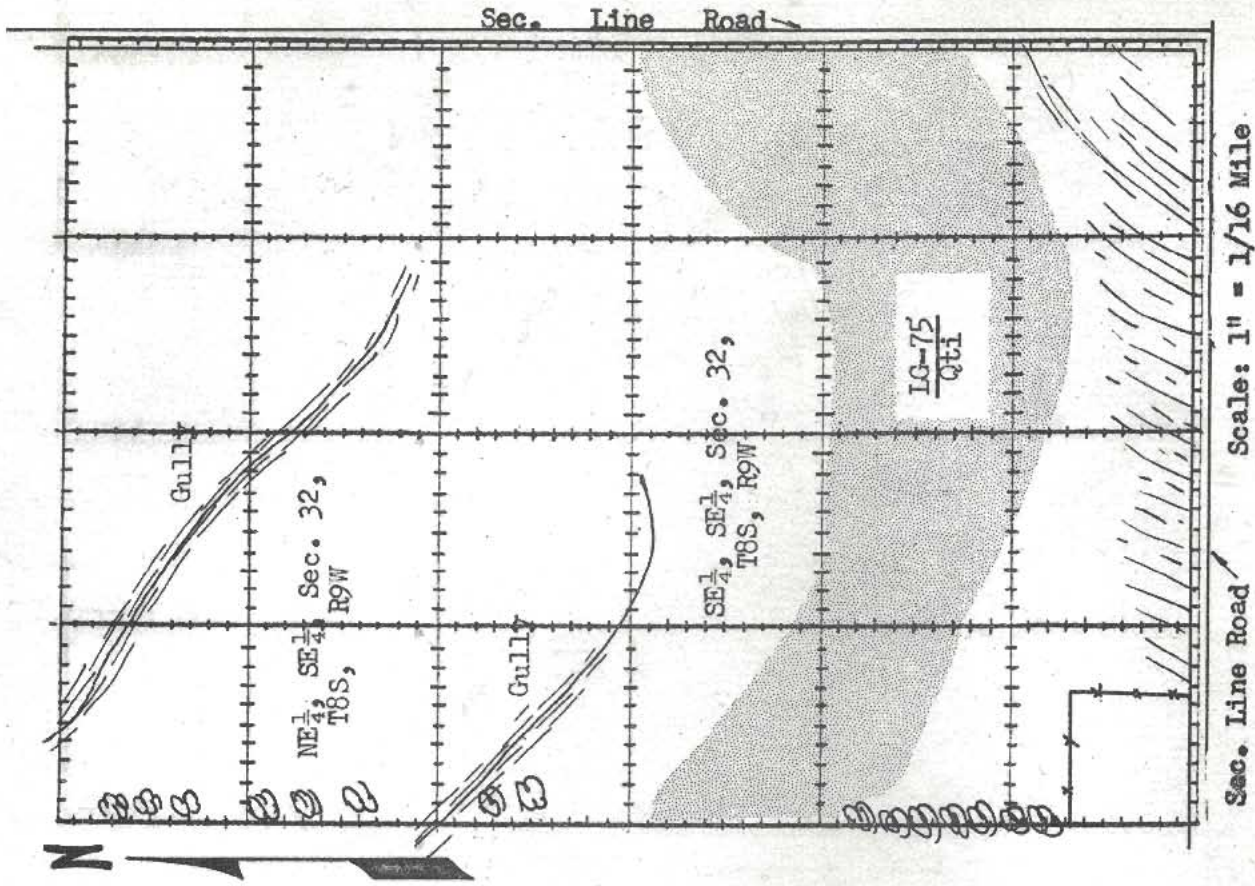











STATE HIGHWAY COMMISSION OF KANSAS  
MATERIAL SURVEY REPORT

SITE NO. 1G-78  
Qti  
MATERIAL Limestone Gravel DATE January, 1964  
LOCATION NE $\frac{1}{4}$ , NE $\frac{1}{4}$  COUNTY Mitchell  
SEC. 2 TWP. 9S RANGE 10W  
OWNER Maude E. Boyles 450 San Salvadore, Dunedin, Florida  
name address  
TENANT \_\_\_\_\_ name address  
NATURE OF DEPOSIT Dry ACCESSIBILITY Good  
STATUS OF SITE Prospective site; not sampled

Test Hole	Material at Bottom of Hole	Depth of Overburden	Depth of Material in Hole	EXPLORATION DATA														
				Percent Retained														
				1/2	3/4	7/8	4	8	10	16	30	40	50	100	200	Wash	PI	

CORRELATION DATA  
GEOLOGICAL AGE Pleistocene GEOLOGICAL SOURCE High stream terrace  
MATERIAL SIMILAR TO \_\_\_\_\_

REMARKS: \_\_\_\_\_  
\_\_\_\_\_  
\_\_\_\_\_  
\_\_\_\_\_

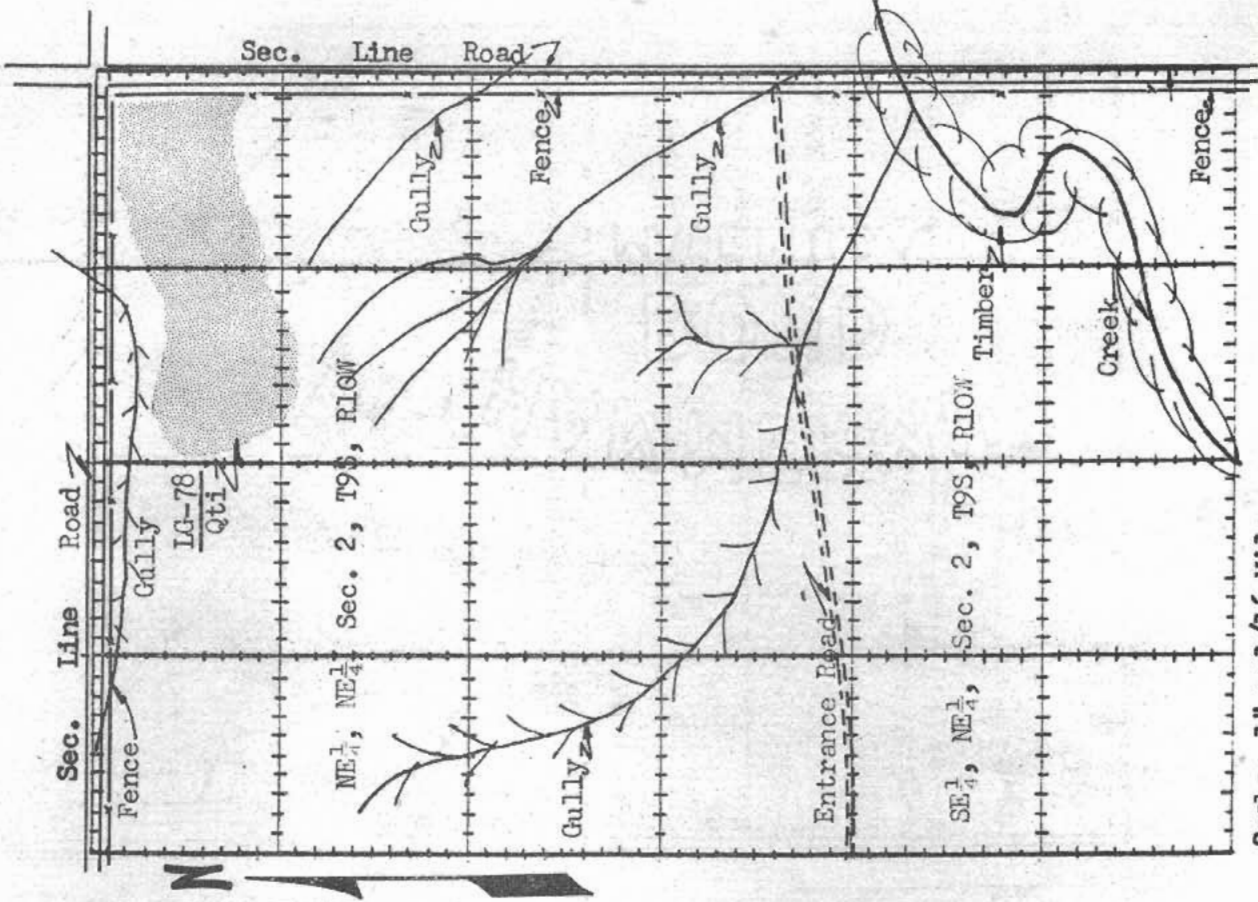













STATE HIGHWAY COMMISSION OF KANSAS  
MATERIAL SURVEY REPORT

SITE NO. IG-82  
Qtl

MATERIAL Limestone Gravel

LOCATION NW $\frac{1}{4}$ , NE $\frac{1}{4}$  SEC. 29 TWP. 9S RANGE 10W

OWNER Maggie M. Jordan c/o Harold Jordan Beloit, Kansas

TENANT \_\_\_\_\_ name \_\_\_\_\_ address \_\_\_\_\_

NATURE OF DEPOSIT Dry ACCESSIBILITY Good

STATUS OF SITE Prospective site; not sampled

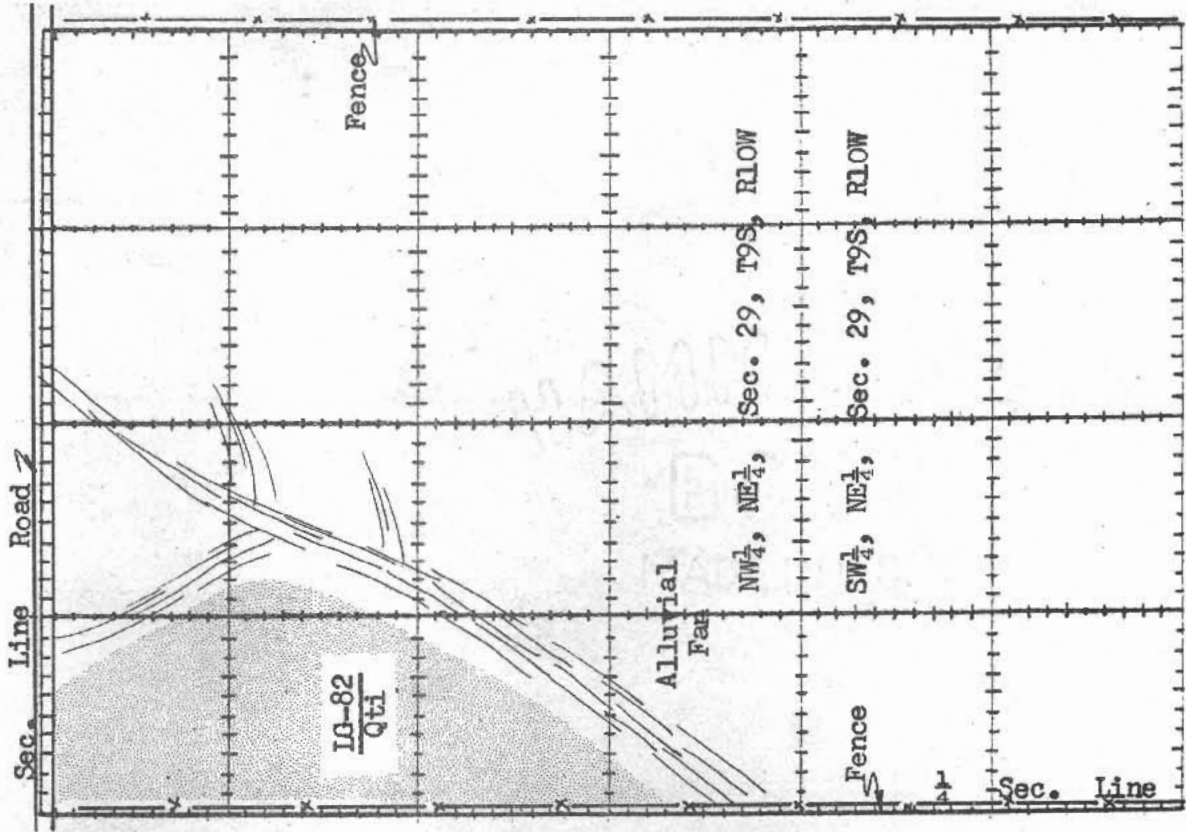

Scale: 1" = 1/16 Mile

Test Hole	Material at Bottom of Hole	Depth of Overburden	Depth of Mottled Hole	Depth of Hole	EXPLORATION DATA												
					Percent Retained												
					1/2	3/4	3/8	4	8	10	16	30	40	50	100	200	PI

CORRELATION DATA

GEOLOGICAL AGE Pleistocene GEOLOGICAL SOURCE High stream terrace

MATERIAL SIMILAR TO \_\_\_\_\_

REMARKS: \_\_\_\_\_

\_\_\_\_\_

\_\_\_\_\_

\_\_\_\_\_

\_\_\_\_\_

STATE HIGHWAY COMMISSION OF KANSAS  
MATERIAL SURVEY REPORT

LG-83  
Qtl

SITE NO. \_\_\_\_\_ DATE January, 1964  
 MATERIAL Limestone Gravel COUNTY Mitchell  
 LOCATION SW $\frac{1}{4}$ , SW $\frac{1}{4}$  sec. 29 TWP. 8S RANGE 9W  
 OWNER Henry Boberg Tipton, Kansas  
 name address  
 TENANT \_\_\_\_\_ name address  
 NATURE OF DEPOSIT Dry ACCESSIBILITY Good  
 STATUS OF SITE Prospective site; not sampled

EXPLORATION DATA

Test Hole	Material at Bottom of Hole	Depth of Overburden	Depth of Material Hole	Depth of Hole	Percent Retained							Wash 200	L.L. P.I.					
					1/2	3/4	7/8	4	8	10	16			30	40	50	100	

CORRELATION DATA

GEOLOGICAL AGE Pleistocene GEOLOGICAL SOURCE High stream terrace  
 MATERIAL SIMILAR TO \_\_\_\_\_  
 REMARKS: \_\_\_\_\_  
 \_\_\_\_\_  
 \_\_\_\_\_

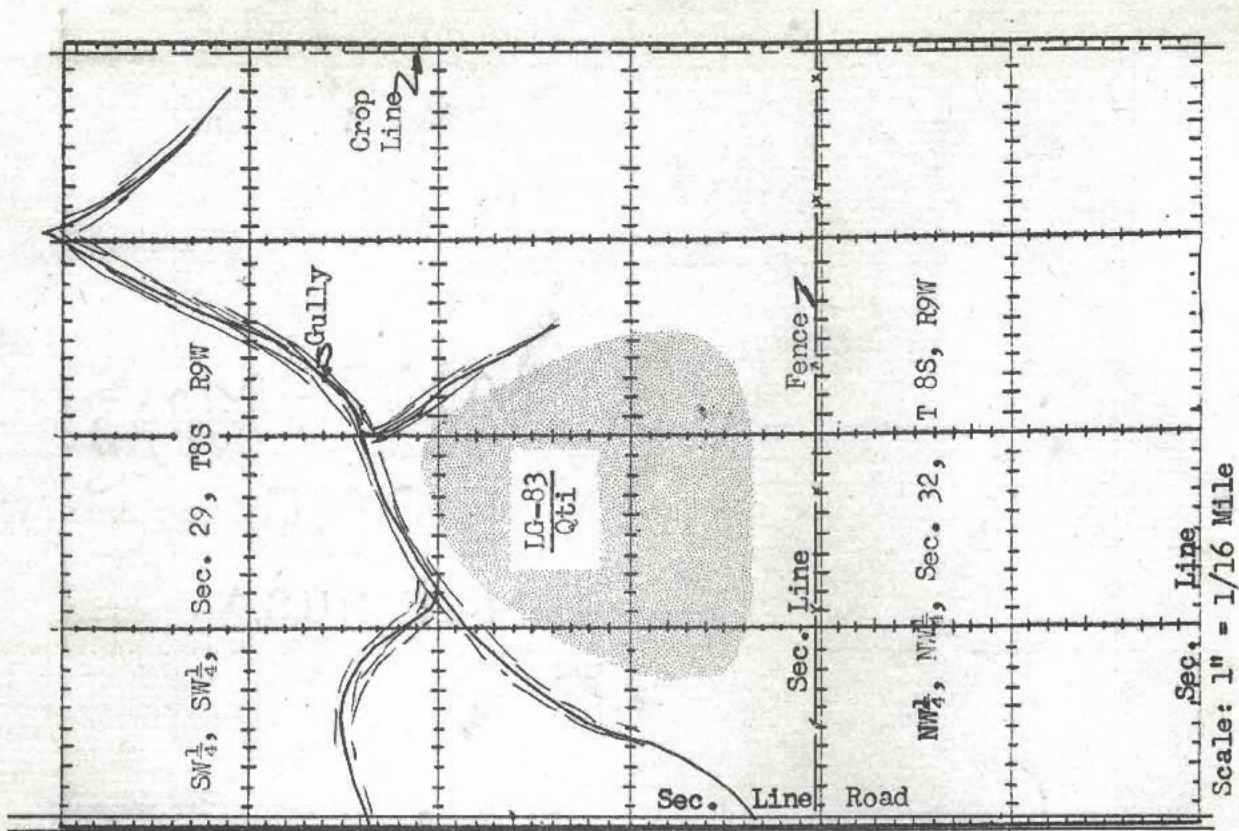





STATE HIGHWAY COMMISSION OF KANSAS  
MATERIAL SURVEY REPORT

SITE NO. 1G-85  
Qt1

DATE January, 1964  
MATERIAL Limestone Gravel COUNTY Mitchell  
LOCATION NW $\frac{1}{4}$ , NE $\frac{1}{4}$  SEC. 28 TWP. 8S RANGE LOW  
OWNER Leo Corpstein Tipton, Kansas  
TENANT \_\_\_\_\_ address \_\_\_\_\_  
NATURE OF DEPOSIT Dry ACCESSIBILITY Good  
STATUS OF SITE Prospective site; not sampled

EXPLORATION DATA

Test Hole	Material at Bottom of Hole	Depth of Overburden	Depth of Materials Hole	Depth of Hole	Percent Retained								Wash	L.L.	P.L.			
					1/2	3/4	3/8	4	8	10	16	30				40	50	100

CORRELATION DATA

GEOLOGICAL AGE Pleistocene GEOLOGICAL SOURCE High stream terrace  
MATERIAL SIMILAR TO \_\_\_\_\_

REMARKS: \_\_\_\_\_  
\_\_\_\_\_  
\_\_\_\_\_  
\_\_\_\_\_  
\_\_\_\_\_

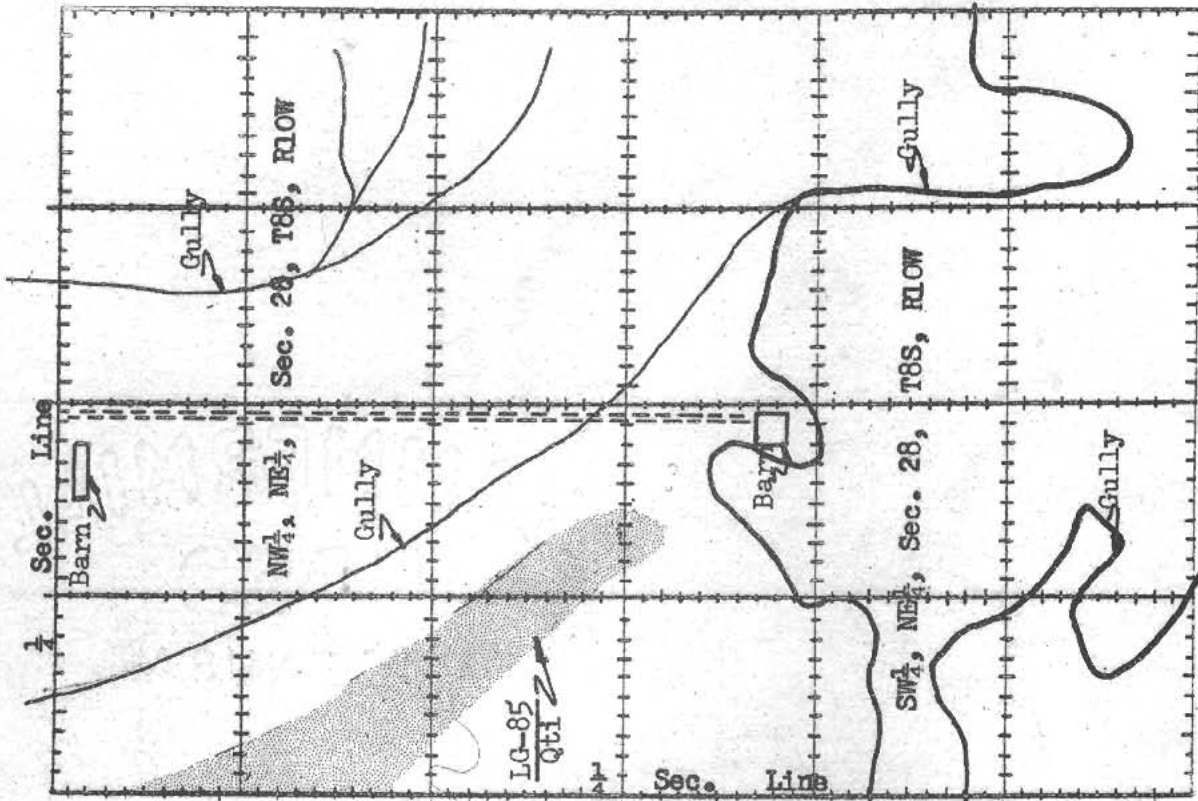

Scale: 1" = 1/16 Mile





















STATE HIGHWAY COMMISSION OF KANSAS  
MATERIAL SURVEY REPORT

SITE NO. SG+91 DATE January, 1964  
Gal  
 MATERIAL Sand and Gravel COUNTY Mitchell  
 LOCATION SE $\frac{1}{4}$ , SE $\frac{1}{4}$  SEC. 18 TWP. 7S RANGE LOW  
 OWNER Ella Lavery Cawker City, Kansas  
 name address  
 TENANT \_\_\_\_\_ address \_\_\_\_\_  
 NATURE OF DEPOSIT Wet ACCESSIBILITY Fair  
 STATUS OF SITE Projective site; not sampled

EXPLORATION DATA

Test Hole	Material of Bottom of Hole	Depth of Overburden	Depth of Material in Hole	Depth of Hole	Percent Retained						Wash 200	L.L.	P.I.							
					1/2	3/4	7/8	4	8	10				16	30	40	50	100		

CORRELATION DATA

GEOLOGICAL AGE Recent GEOLOGICAL SOURCE River Flood Plain  
 MATERIAL SIMILAR TO material in site SG+50  
Gal

REMARKS: \_\_\_\_\_  
 \_\_\_\_\_  
 \_\_\_\_\_  
 \_\_\_\_\_

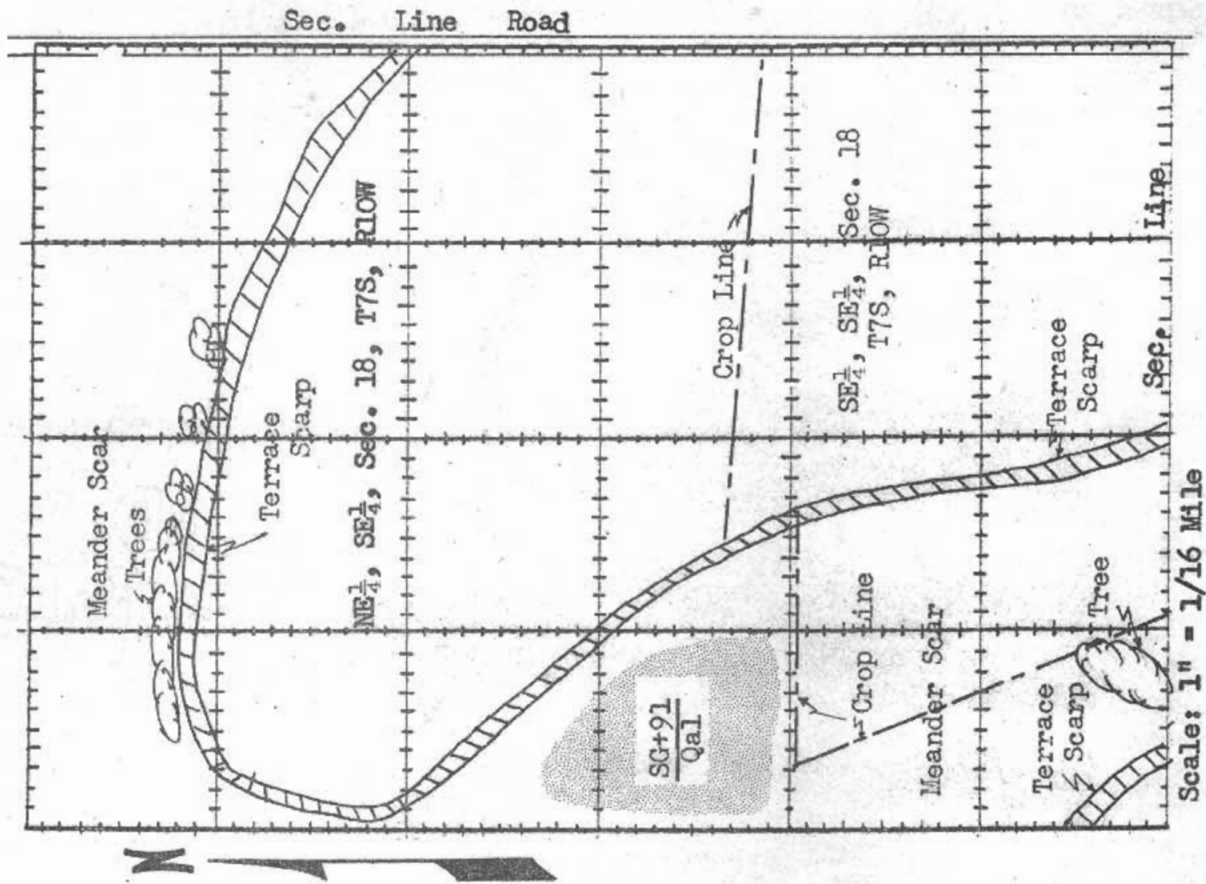



STATE HIGHWAY COMMISSION OF KANSAS  
MATERIAL SURVEY REPORT

SITE NO. IG-92  
Qti

MATERIAL Limestone Gravel DATE January, 1964

LOCATION E $\frac{1}{2}$ , SW $\frac{1}{4}$  COUNTY Mitchell

OWNER N $\frac{1}{2}$ , SW $\frac{1}{4}$  Noel Kadel SEC. 14 TWP. 6S RANGE 7W

S $\frac{1}{2}$ , SW $\frac{1}{4}$  John Patrick Haneberg Beloit, Kansas  
address Heloit, Kansas  
name address

NATURE OF DEPOSIT Dry ACCESSIBILITY Good

STATUS OF SITE Prospective site; not sampled

Test Hole	Material at Bottom of Hole	Depth of Overburden	Depth of Material Hole	EXPLORATION DATA													
				Percent Retained													
				1/2	3/4	7/8	4	8	10	16	30	40	50	100	200	Wash	P.I.

CORRELATION DATA

GEOLOGICAL AGE Pleistocene High stream terrace  
GEOLOGICAL SOURCE IG-1  
MATERIAL SIMILAR TO material in site Qti. It may be visually inspected at this site.

REMARKS:

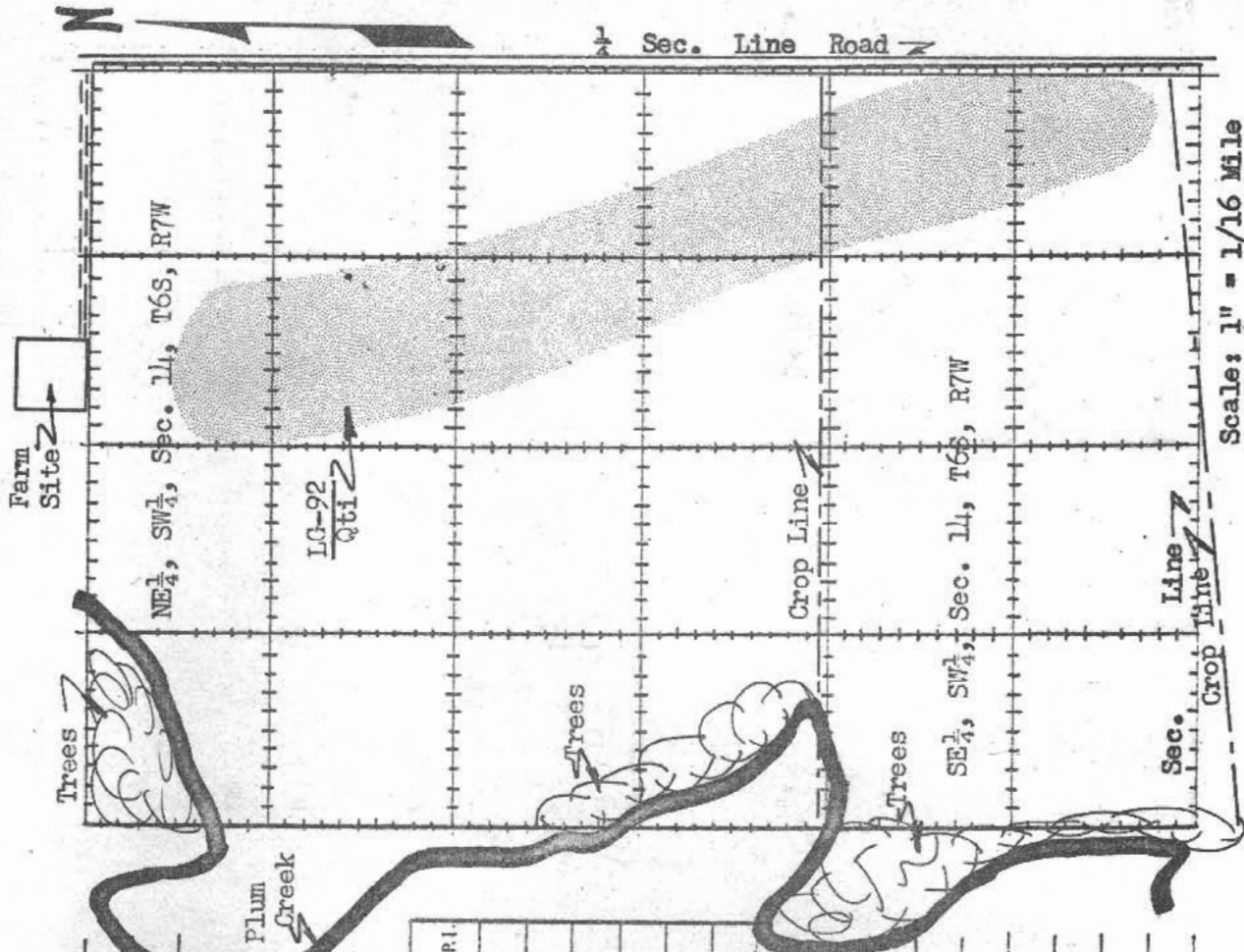

STATE HIGHWAY COMMISSION OF KANSAS

MATERIAL SURVEY REPORT

IG-93  
Qtl

SITE NO. \_\_\_\_\_ DATE January, 1964  
 MATERIAL Limestone Gravel COUNTY Mitchell  
 LOCATION NW $\frac{1}{4}$ , NE $\frac{1}{4}$  SEC. 9 TWP. 6S RANGE 9W  
 OWNER Dwight & Ethyl Timbers Glen Elder, Kansas  
 name address  
 TENANT \_\_\_\_\_ address \_\_\_\_\_  
 NATURE OF DEPOSIT Dry ACCESSIBILITY Good  
 STATUS OF SITE Prospective site; not sampled

EXPLORATION DATA

Test Hole	Material at Bottom of Hole	Depth of Overburden	Depth of Materials Hole	Percent Retained																	
				1/2	3/4	7/8	4	8	10	16	30	40	50	100	200	Wash	RI				

CORRELATION DATA

GEOLOGICAL AGE Pleistocene GEOLOGICAL SOURCE High stream terrace  
IG-3

MATERIAL SIMILAR TO material in site Qtl. It may be visually inspected in the pit banks at this location.

REMARKS: \_\_\_\_\_  
 \_\_\_\_\_  
 \_\_\_\_\_  
 \_\_\_\_\_

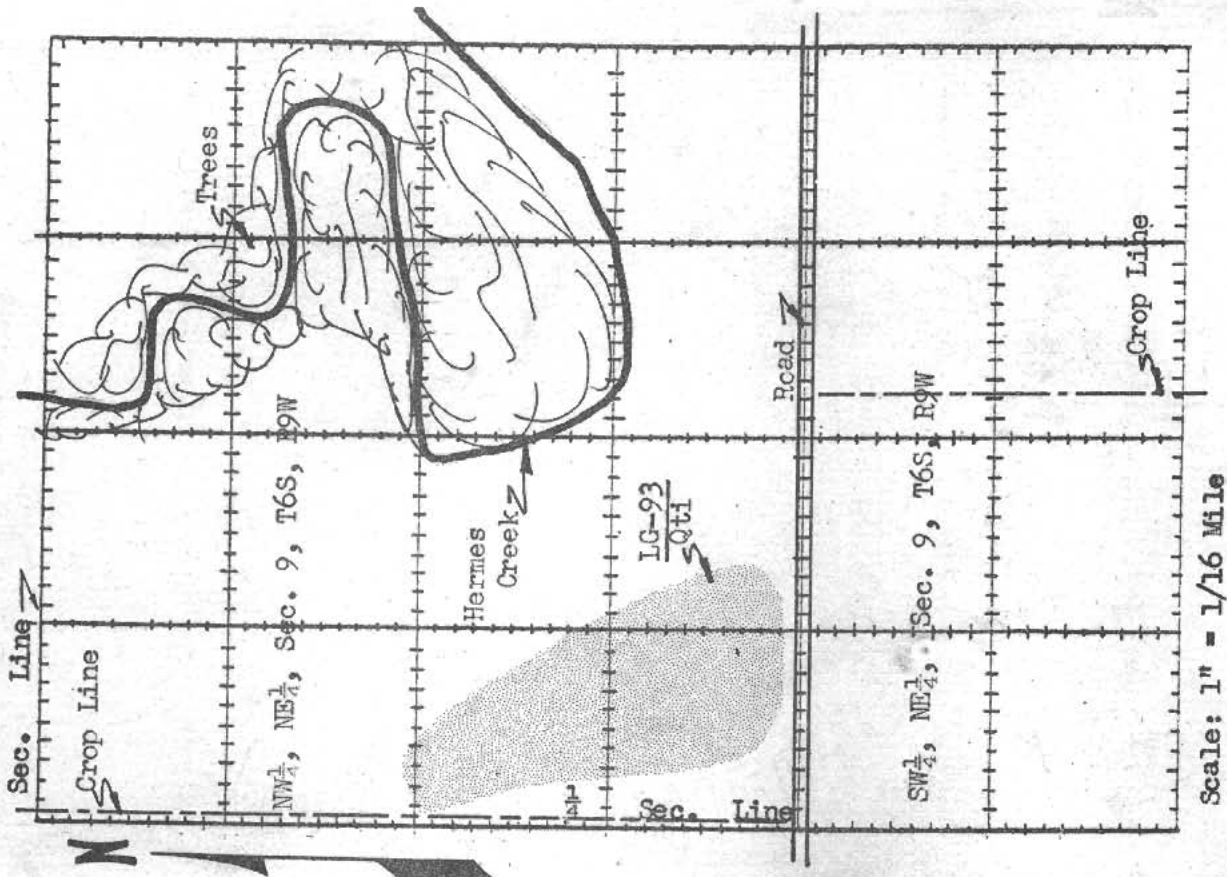



STATE HIGHWAY COMMISSION OF KANSAS  
MATERIAL SURVEY REPORT

SITE NO. IG-94  
Qti  
MATERIAL Limestone Gravel COUNTY Mitchell  
LOCATION NW $\frac{1}{4}$ , SW $\frac{1}{4}$  SEC. 25 TWP. 7S RANGE 6W  
OWNER Harold Grovewoller Beloit, Kansas  
TENANT \_\_\_\_\_ address \_\_\_\_\_  
NATURE OF DEPOSIT Dry ACCESSIBILITY Good  
STATUS OF SITE Prospective site; not sampled

Test Hole	Material at Bottom of Hole	Depth of Overburden	Depth of Materials Hole	Depth of Hole	EXPLORATION DATA															
					Percent Retained															
					1/2	3/4	7/8	4	8	10	16	30	40	50	100	200	Wash	L.L.	P.L.	

CORRELATION DATA  
GEOLOGICAL AGE Pleistocene GEOLOGICAL SOURCE High stream terrace  
MATERIAL SIMILAR TO material in site IG-46. It may be visually inspected in the pit banks at this location.

REMARKS: \_\_\_\_\_  
\_\_\_\_\_  
\_\_\_\_\_

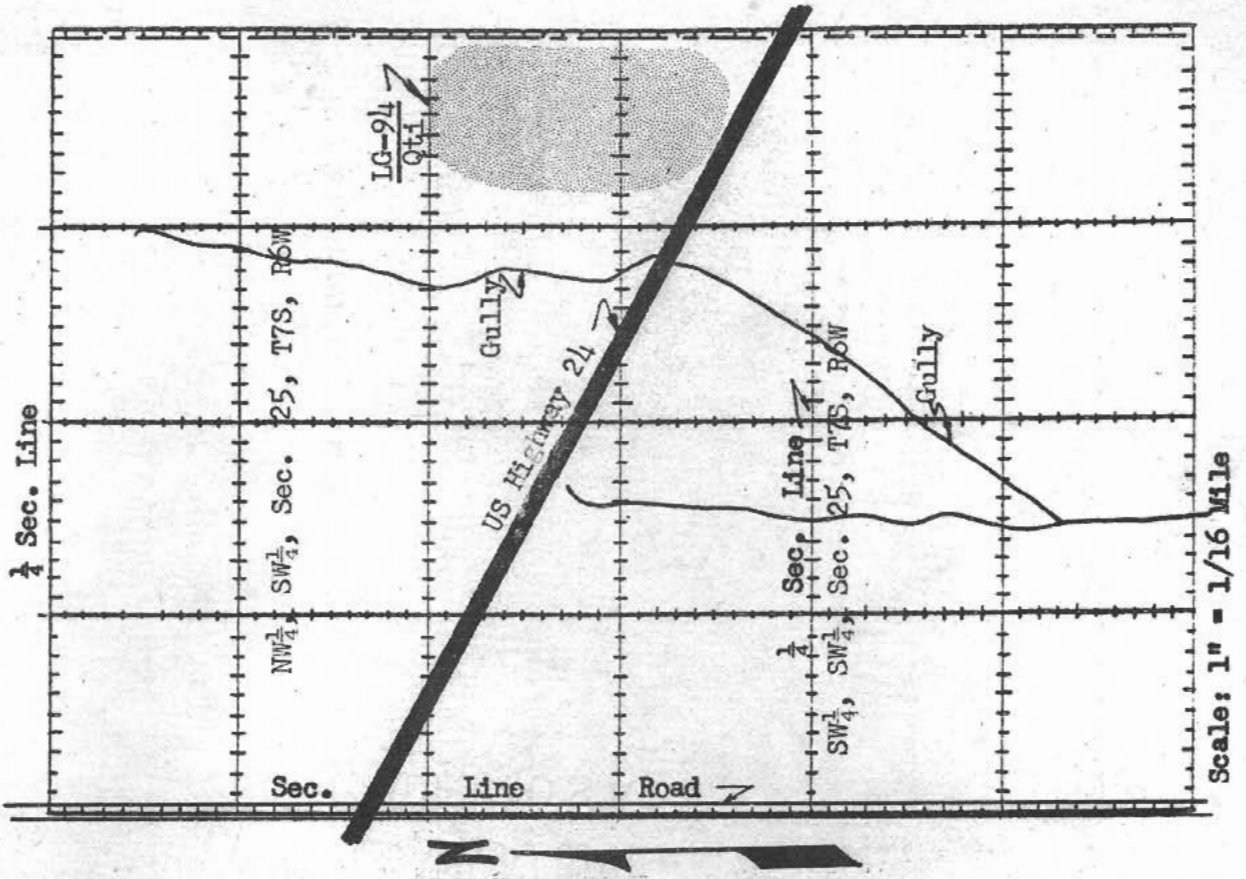

STATE HIGHWAY COMMISSION OF KANSAS  
MATERIAL SURVEY REPORT

SITE NO. IG-95  
Qtl      DATE January, 1964

MATERIAL Limestone Gravel      COUNTY Mitchell

LOCATION SW $\frac{1}{4}$ , NE $\frac{1}{4}$       SEC. 26      TWP. 7S      RANGE 6W

OWNER Harold P. Reiter      address Beloit, Kansas

TENANT \_\_\_\_\_      address \_\_\_\_\_

NATURE OF DEPOSIT Dry      ACCESSIBILITY Good

STATUS OF SITE Prospective site; not sampled

Test Hole	Material at Bottom of Hole	Depth of Overburden	Depth of Material	Depth of Hole	Percent Retained								Wash 200	L.L.	P.L.			
					1/2	3/4	1	2	4	8	16	30				40	50	100

CORRELATION DATA

GEOLOGICAL AGE Pleistocene      GEOLOGICAL SOURCE High stream terrace  
IG-46

MATERIAL SIMILAR TO material in site Qtl. It may be visually inspected in the pit bank at this location.

REMARKS: \_\_\_\_\_  
\_\_\_\_\_  
\_\_\_\_\_

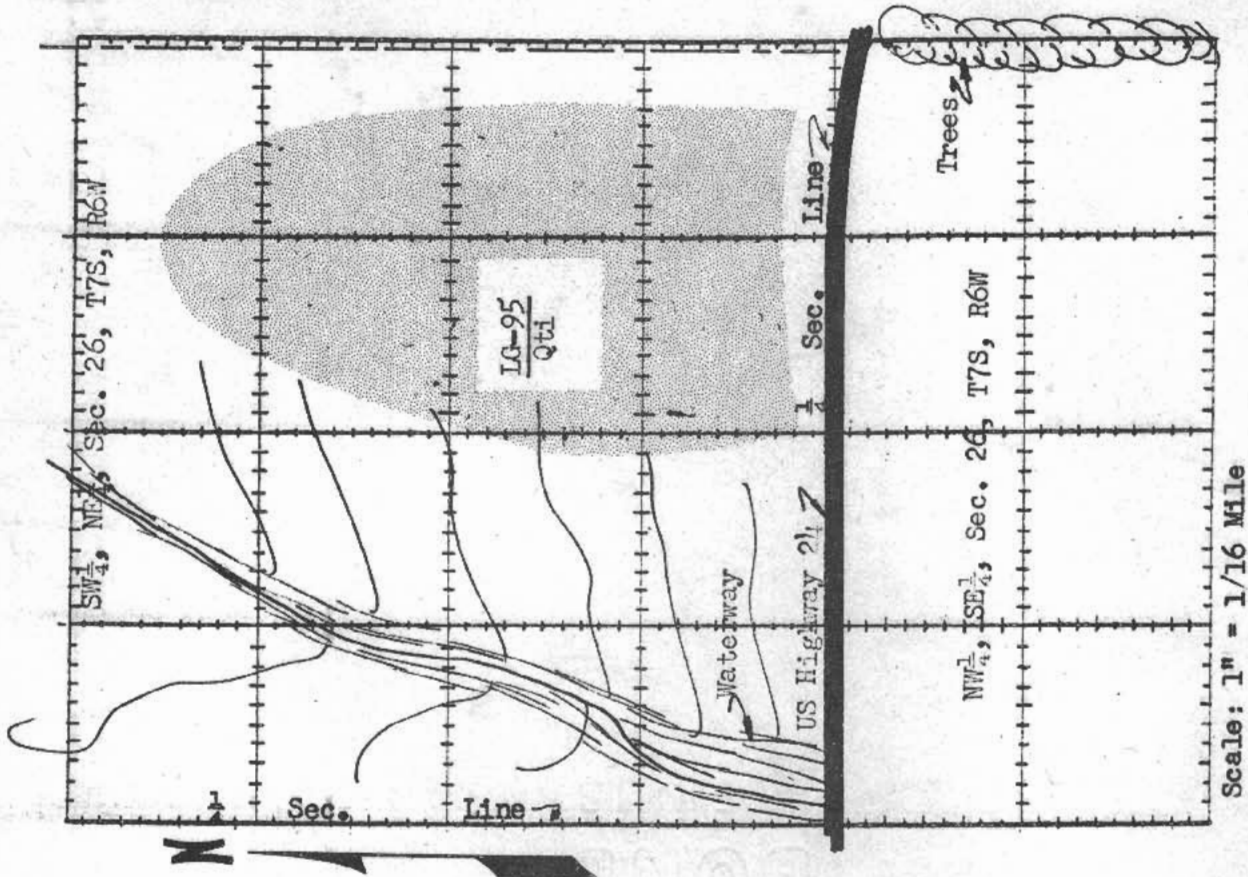



STATE HIGHWAY COMMISSION OF KANSAS  
MATERIAL SURVEY REPORT

SITE NO. MP+96  
Q<sub>5W</sub> DATE January, 1964  
MATERIAL Mineral Filler COUNTY Mitchell  
LOCATION SW $\frac{1}{4}$ , SW $\frac{1}{4}$  SEC. 5 TWP. 7S RANGE 8W  
OWNER Paul and Helen Mears name Beloit, Kansas  
TENANT \_\_\_\_\_ name \_\_\_\_\_ address \_\_\_\_\_  
NATURE OF DEPOSIT Dry ACCESSIBILITY Good  
STATUS OF SITE Prospective site; not sampled

Test Hole	Material at Bottom of Hole	Depth of Overburden	Depth of Materials	Depth of Hole	EXPLORATION DATA															
					Percent Retained															
					1/2	3/4	7/8	4	8	10	16	30	40	50	100	200	Wash	LL	PI	

CORRELATION DATA  
GEOLOGICAL AGE Pleistocene GEOLOGICAL SOURCE River terrace  
MATERIAL SIMILAR TO \_\_\_\_\_  
REMARKS: \_\_\_\_\_  
\_\_\_\_\_

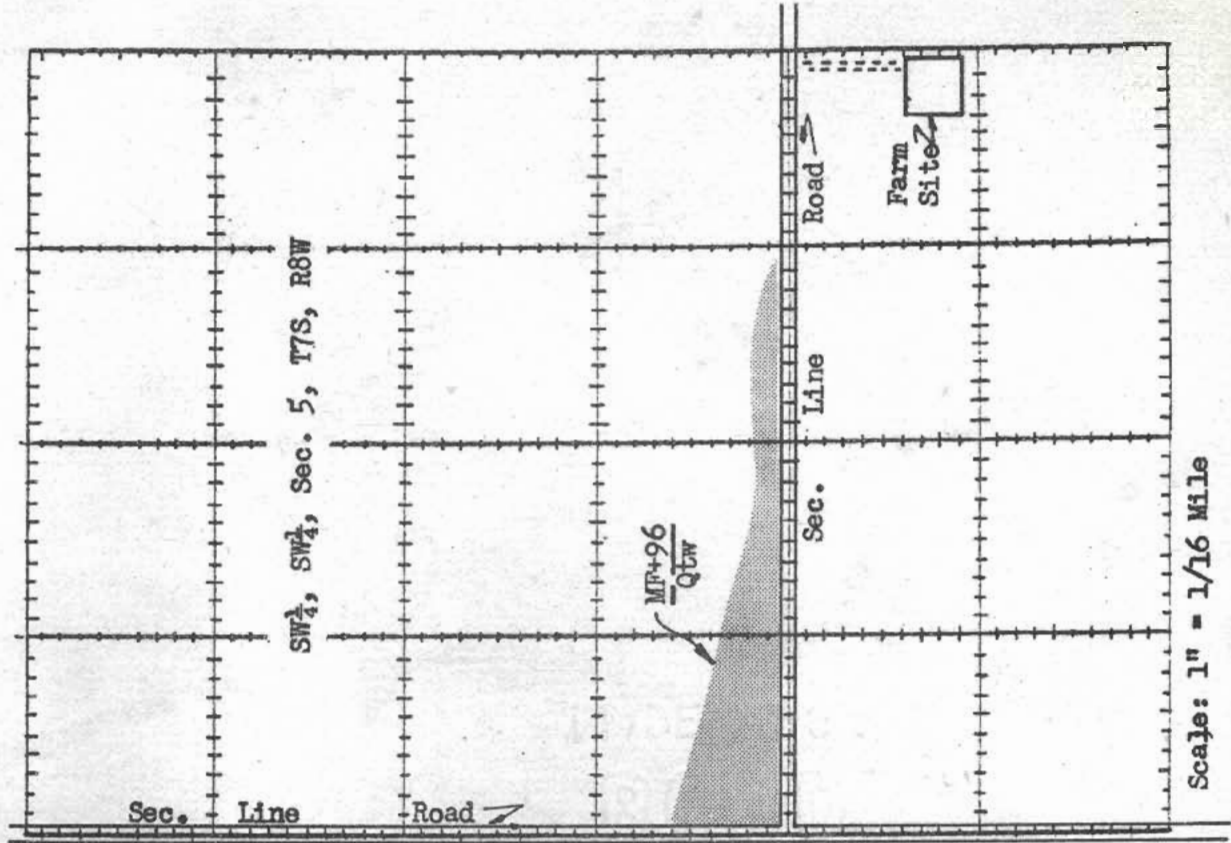





# MITCHELL COUNTY MATERIALS MAP LEGEND

## EXPLANATION OF MATERIALS SITE DESIGNATIONS

- Open site; not sampled (See Appendix I)
- Open site; sampled (See Appendix II)
- ▲ Prospective site; sampled (See Appendix III)
- ◆ Prospective site; not sampled (See Appendix IV)

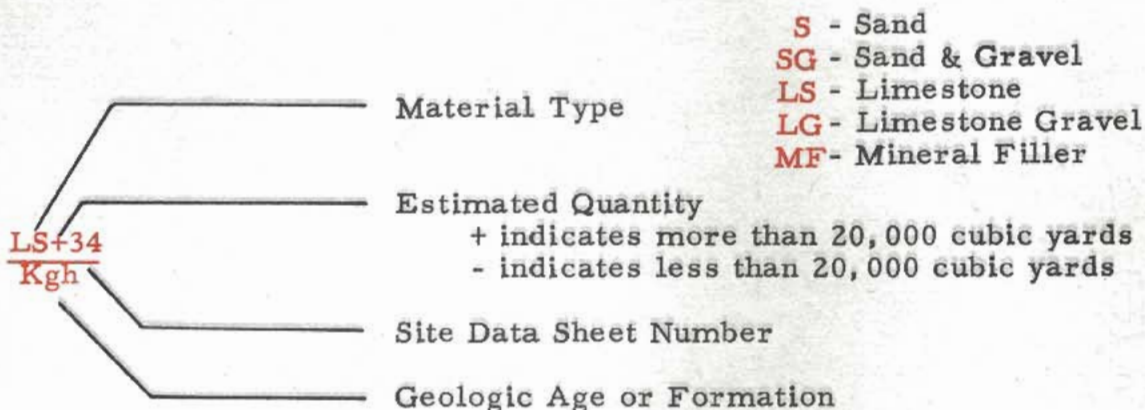

## EXPLANATION OF MAP SYMBOLS

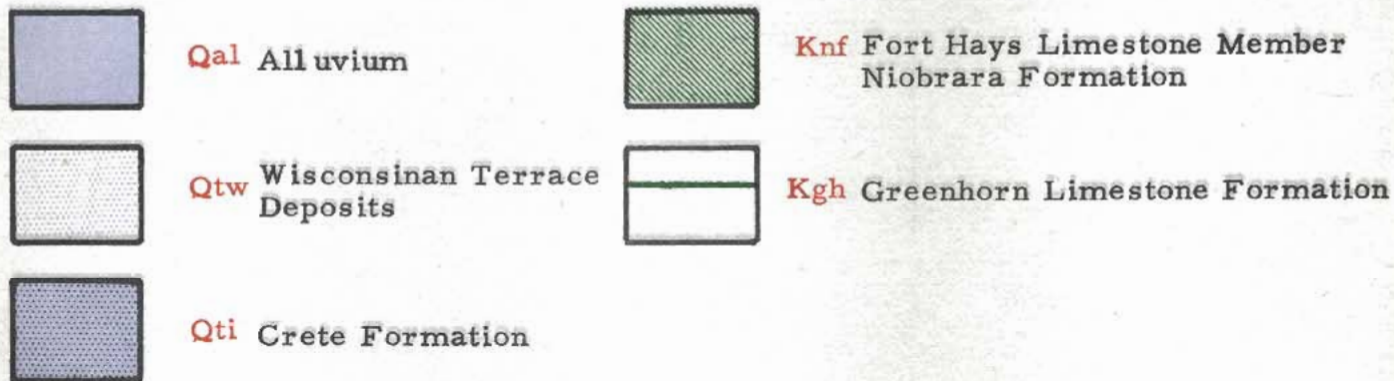

prepared by the  
 STATE HIGHWAY COMMISSION OF KANSAS  
 in cooperation with the  
 U.S. DEPARTMENT OF COMMERCE  
 BUREAU OF PUBLIC ROADS



COUNTY

OSBORNE

R 10 W

JEWELL

R 10 W

R 9 W

COUNTY

R 9 W

R 8 W

T O U S . 3 6

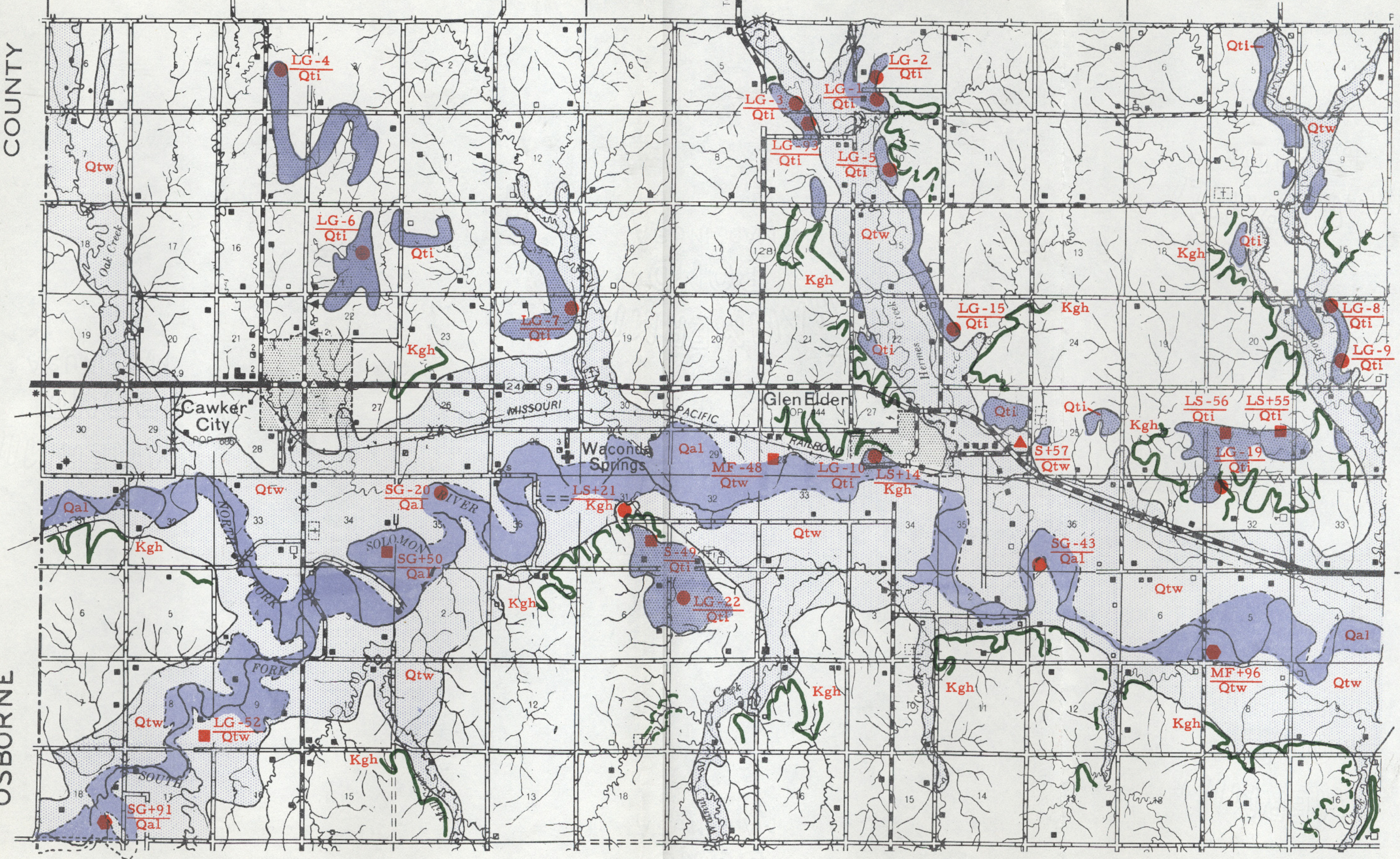



# MITCHELL COUNTY MATERIALS MAP LEGEND

## EXPLANATION OF MATERIALS SITE DESIGNATIONS

- Open site; not sampled (See Appendix I)
- Open site; sampled (See Appendix II)
- ▲ Prospective site; sampled (See Appendix III)
- ◆ Prospective site; not sampled (See Appendix IV)

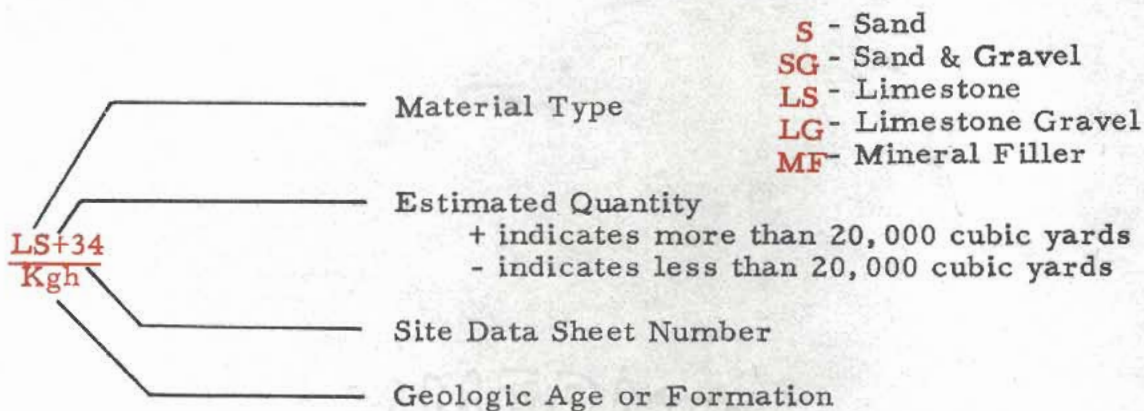

## EXPLANATION OF MAP SYMBOLS

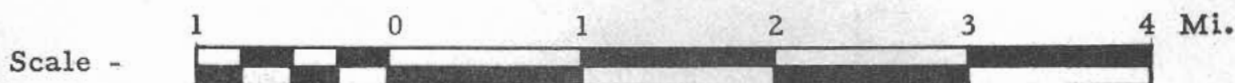
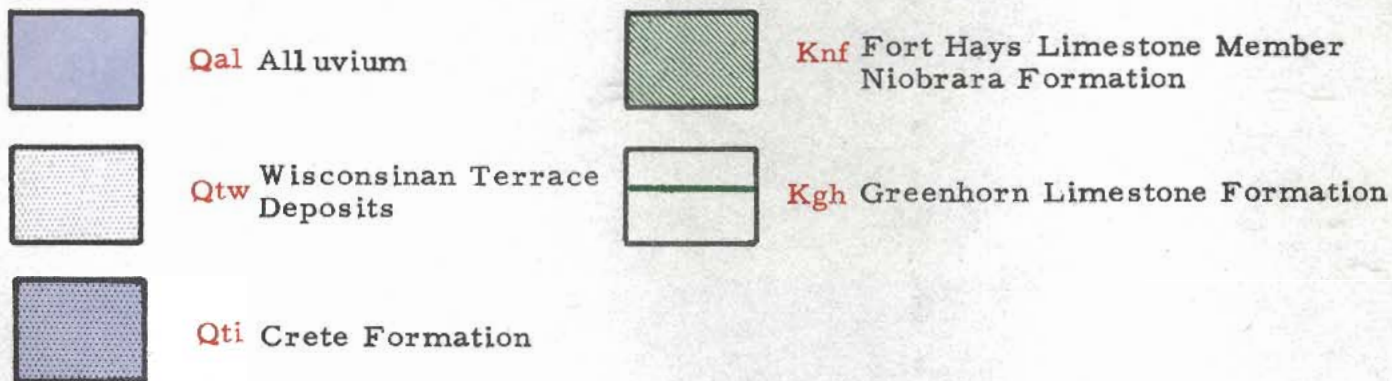

prepared by the  
 STATE HIGHWAY COMMISSION OF KANSAS  
 in cooperation with the  
 U.S. DEPARTMENT OF COMMERCE  
 BUREAU OF PUBLIC ROADS



JEWELL

COUNTY

R 8 W  
TO JEWELL

R 7 W

R 7 W

R 6 W

R 6 W

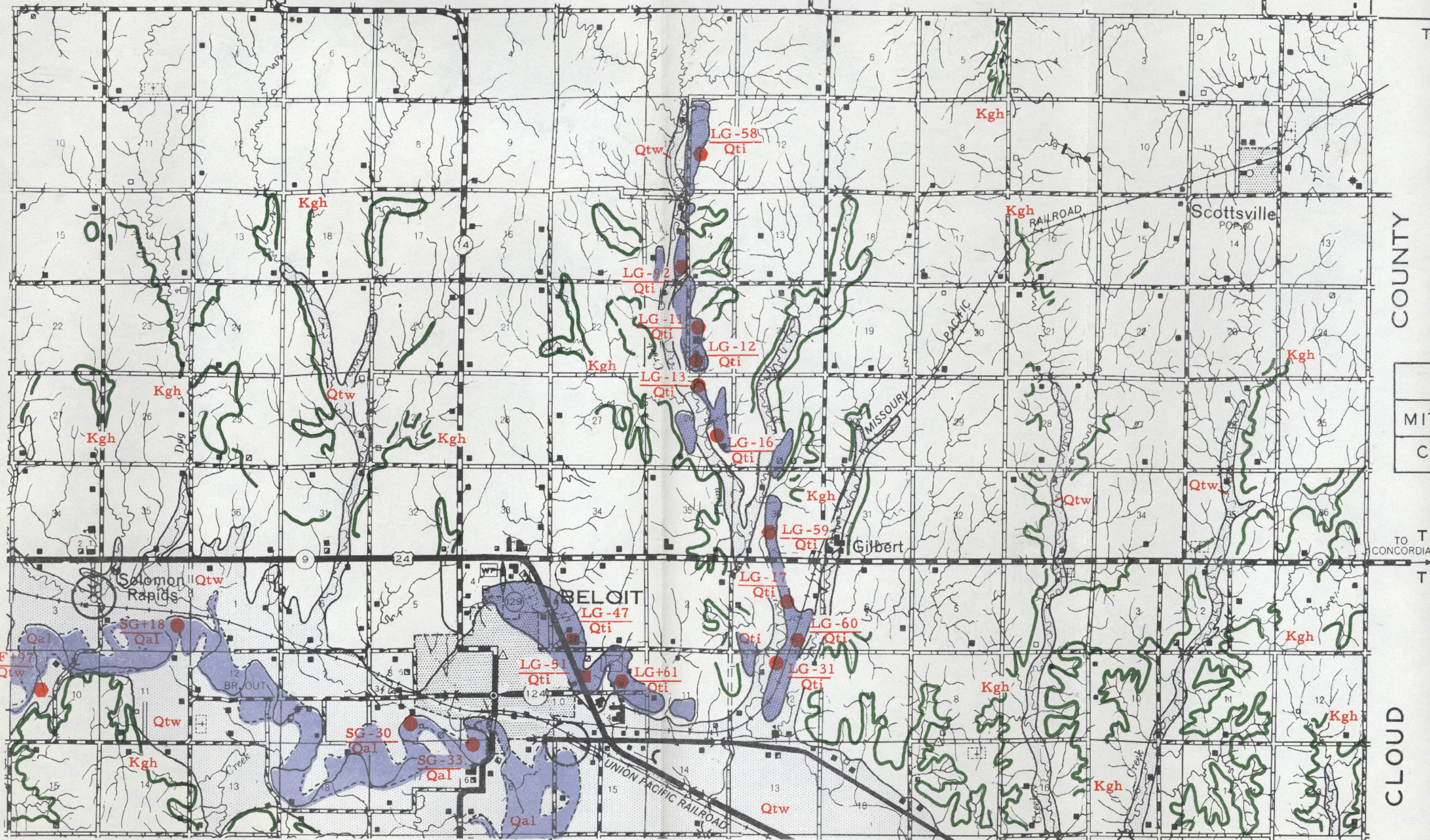

COUNTY

MIT  
CO

TO T 6  
CONCORDIA

T 7

CLOUD



# MITCHELL COUNTY MATERIALS MAP LEGEND

## EXPLANATION OF MATERIALS SITE DESIGNATIONS

- Open site; not sampled (See Appendix I)
- Open site; sampled (See Appendix II)
- ▲ Prospective site; sampled (See Appendix III)
- ◆ Prospective site; not sampled (See Appendix IV)

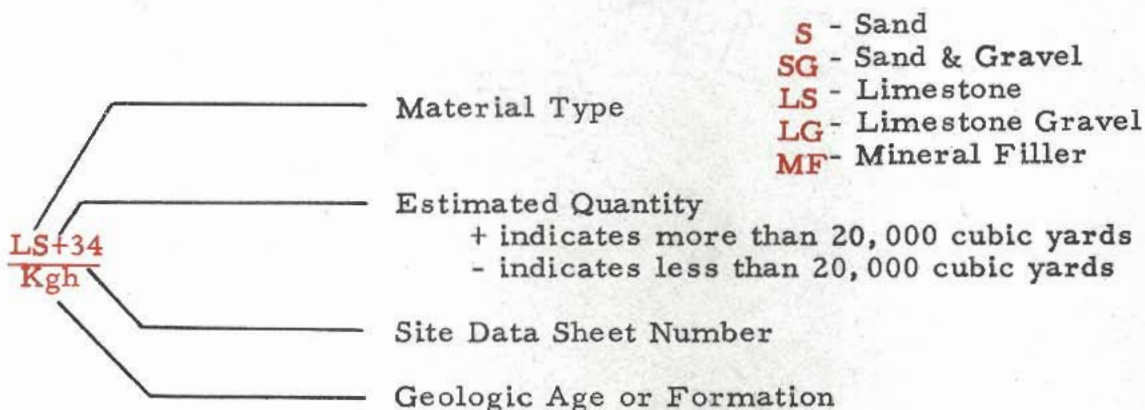

## EXPLANATION OF MAP SYMBOLS

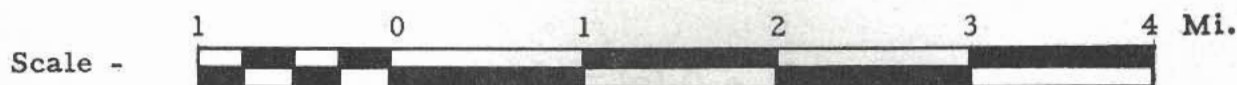
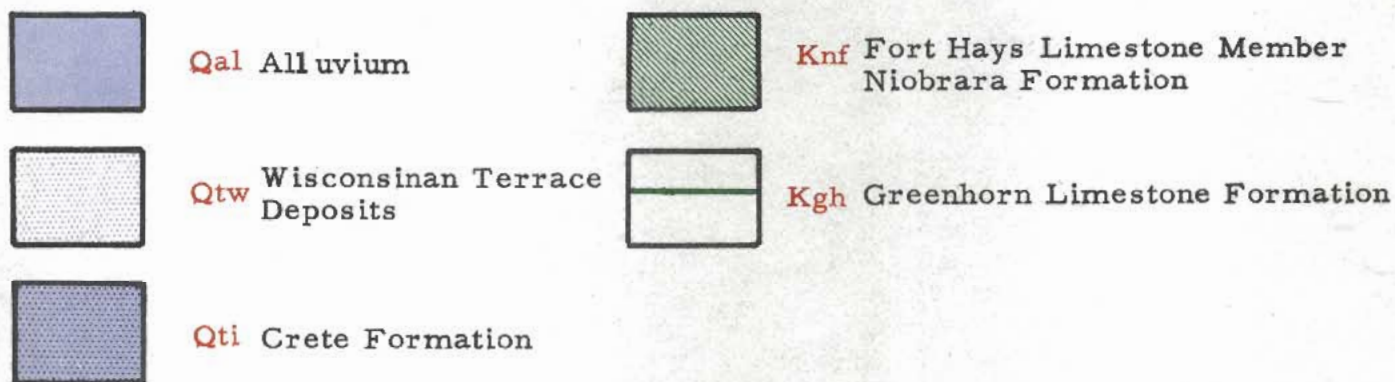

prepared by the  
 STATE HIGHWAY COMMISSION OF KANSAS  
 in cooperation with the  
 U.S. DEPARTMENT OF COMMERCE  
 BUREAU OF PUBLIC ROADS







# MITCHELL COUNTY MATERIALS MAP LEGEND

## EXPLANATION OF MATERIALS SITE DESIGNATIONS

- Open site; not sampled (See Appendix I)
- Open site; sampled (See Appendix II)
- ▲ Prospective site; sampled (See Appendix III)
- ◆ Prospective site; not sampled (See Appendix IV)

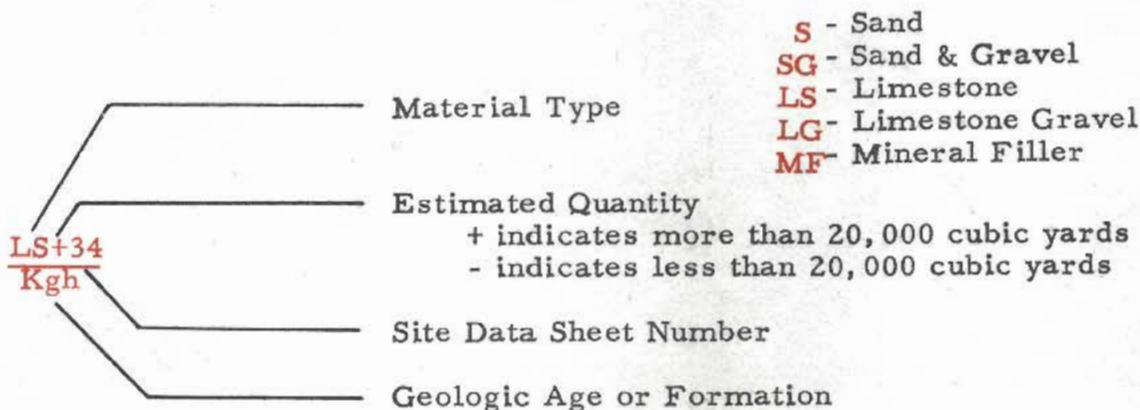

## EXPLANATION OF MAP SYMBOLS

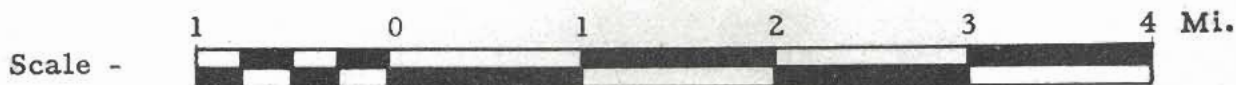
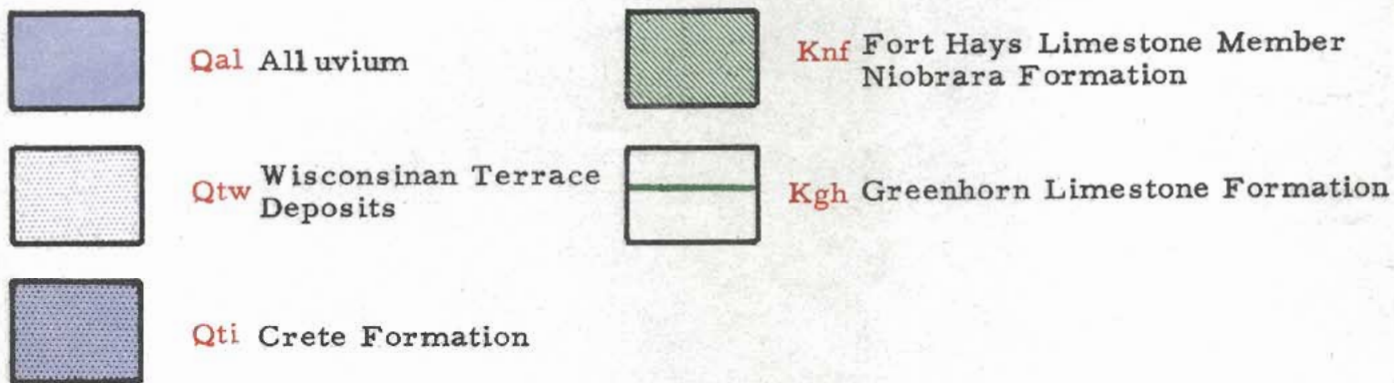

prepared by the  
 STATE HIGHWAY COMMISSION OF KANSAS  
 in cooperation with the  
 U.S. DEPARTMENT OF COMMERCE  
 BUREAU OF PUBLIC ROADS



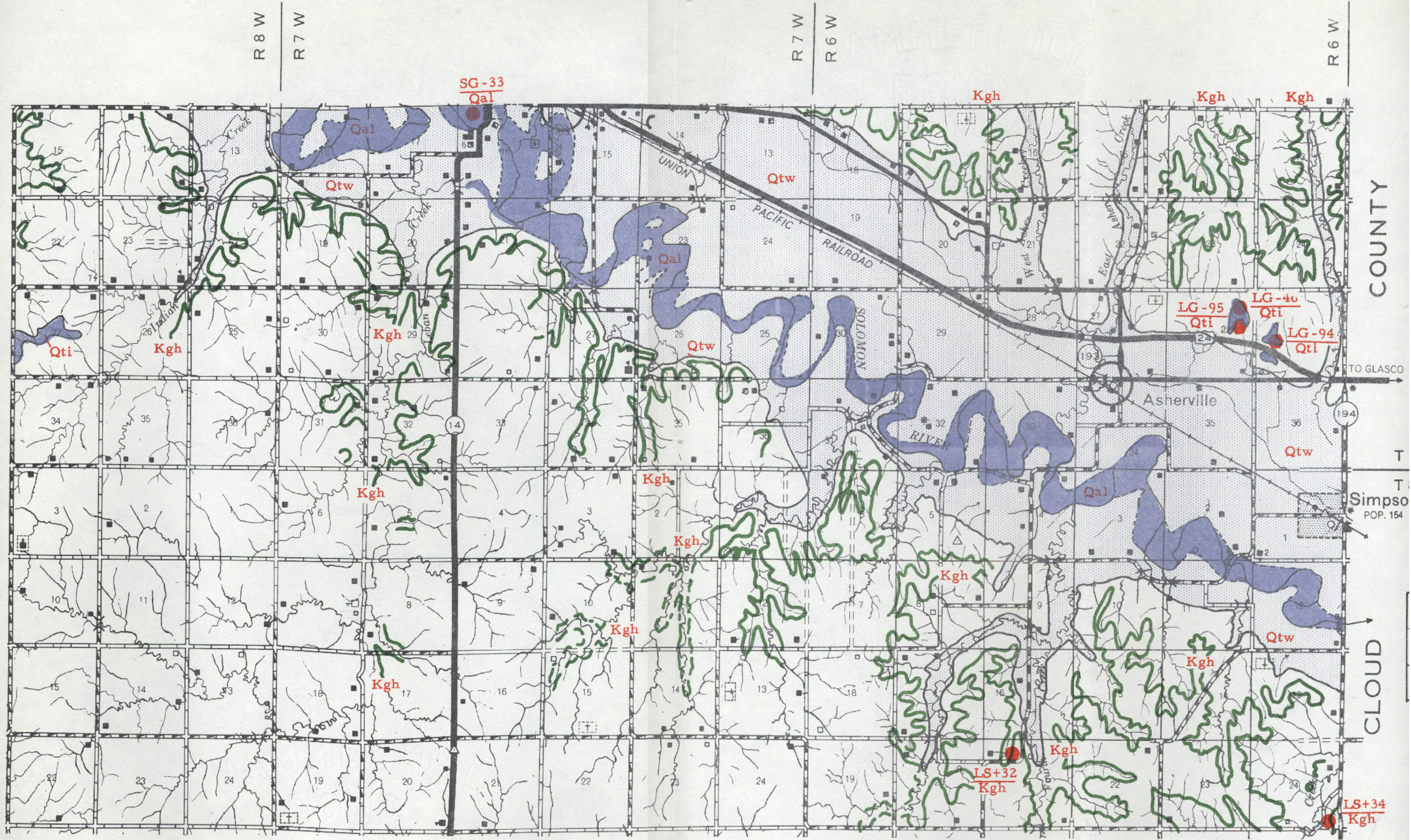

COUNTY

CLOUD

PLATE IV



# MITCHELL COUNTY MATERIALS MAP LEGEND

## EXPLANATION OF MATERIALS SITE DESIGNATIONS

- Open site; not sampled (See Appendix I)
- Open site; sampled (See Appendix II)
- ▲ Prospective site; sampled (See Appendix III)
- ◆ Prospective site; not sampled (See Appendix IV)

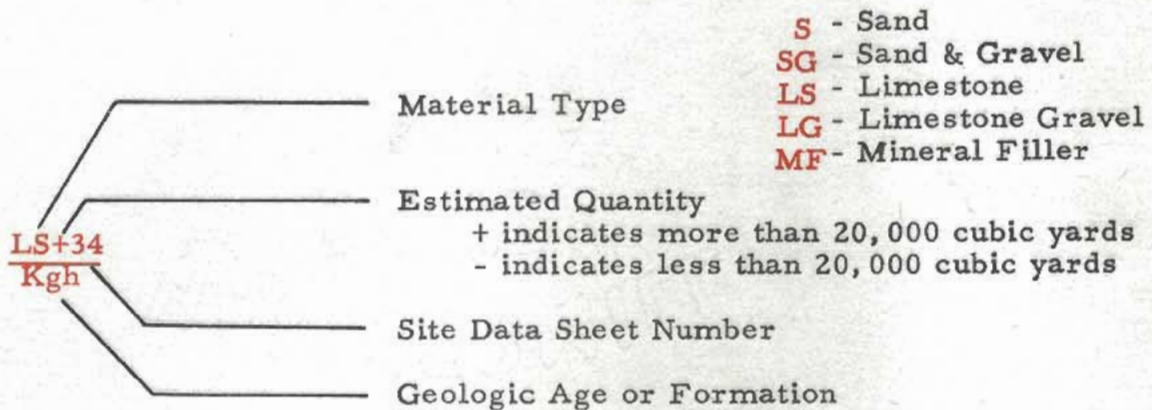

## EXPLANATION OF MAP SYMBOLS

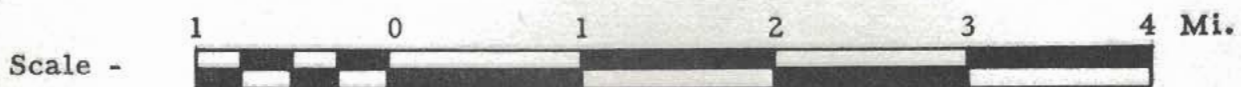
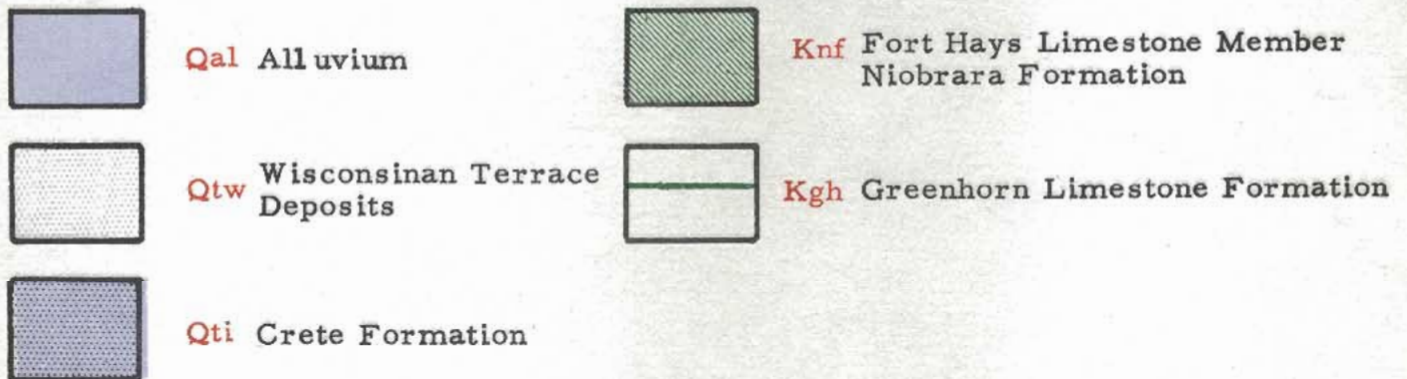

prepared by the  
 STATE HIGHWAY COMMISSION OF KANSAS  
 in cooperation with the  
 U. S. DEPARTMENT OF COMMERCE  
 BUREAU OF PUBLIC ROADS



R 10 W

R 10 W

R 9 W

R 9 W

R 8 W

COUNTY

OSBORNE

LINCOLN

COUNTY

PLATE V

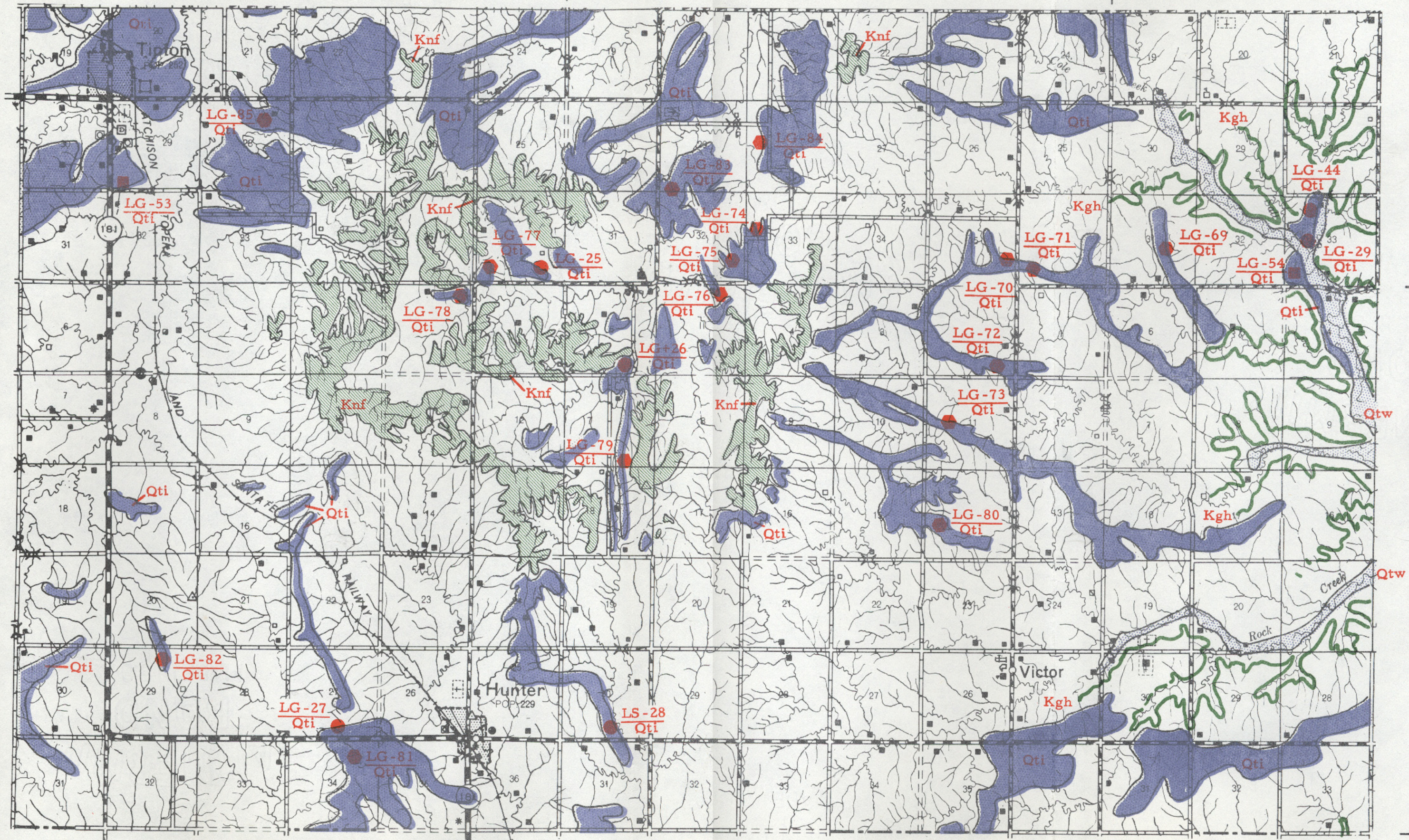

T  
T  
M  
C  
T S



# MITCHELL COUNTY MATERIALS MAP LEGEND

## EXPLANATION OF MATERIALS SITE DESIGNATIONS

- Open site; not sampled (See Appendix I)
- Open site; sampled (See Appendix II)
- ▲ Prospective site; sampled (See Appendix III)
- ◆ Prospective site; not sampled (See Appendix IV)

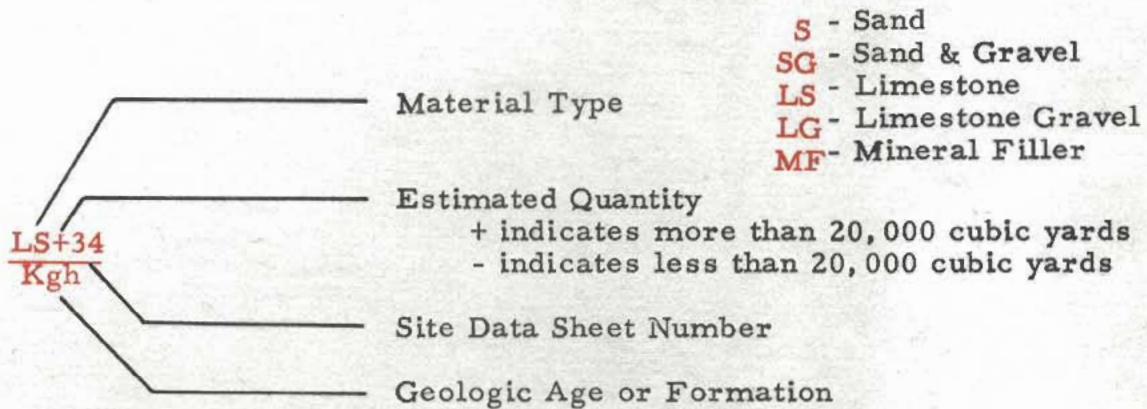

## EXPLANATION OF MAP SYMBOLS

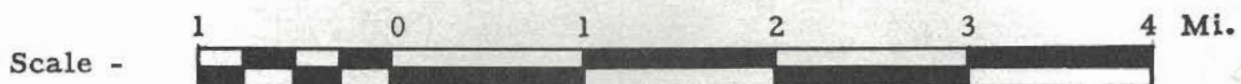
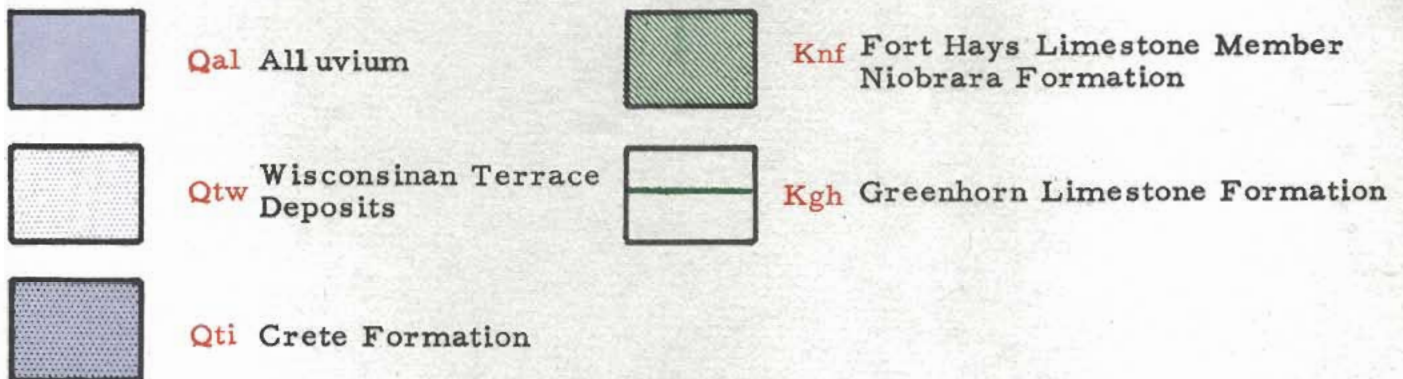

prepared by the  
 STATE HIGHWAY COMMISSION OF KANSAS  
 in cooperation with the  
 U.S. DEPARTMENT OF COMMERCE  
 BUREAU OF PUBLIC ROADS



R 8 W  
R 7 W

R 7 W  
R 6 W

R 6 W

CLOUD CO.  
COUNTY

MIT  
C

OTTAWA  
T 9 S

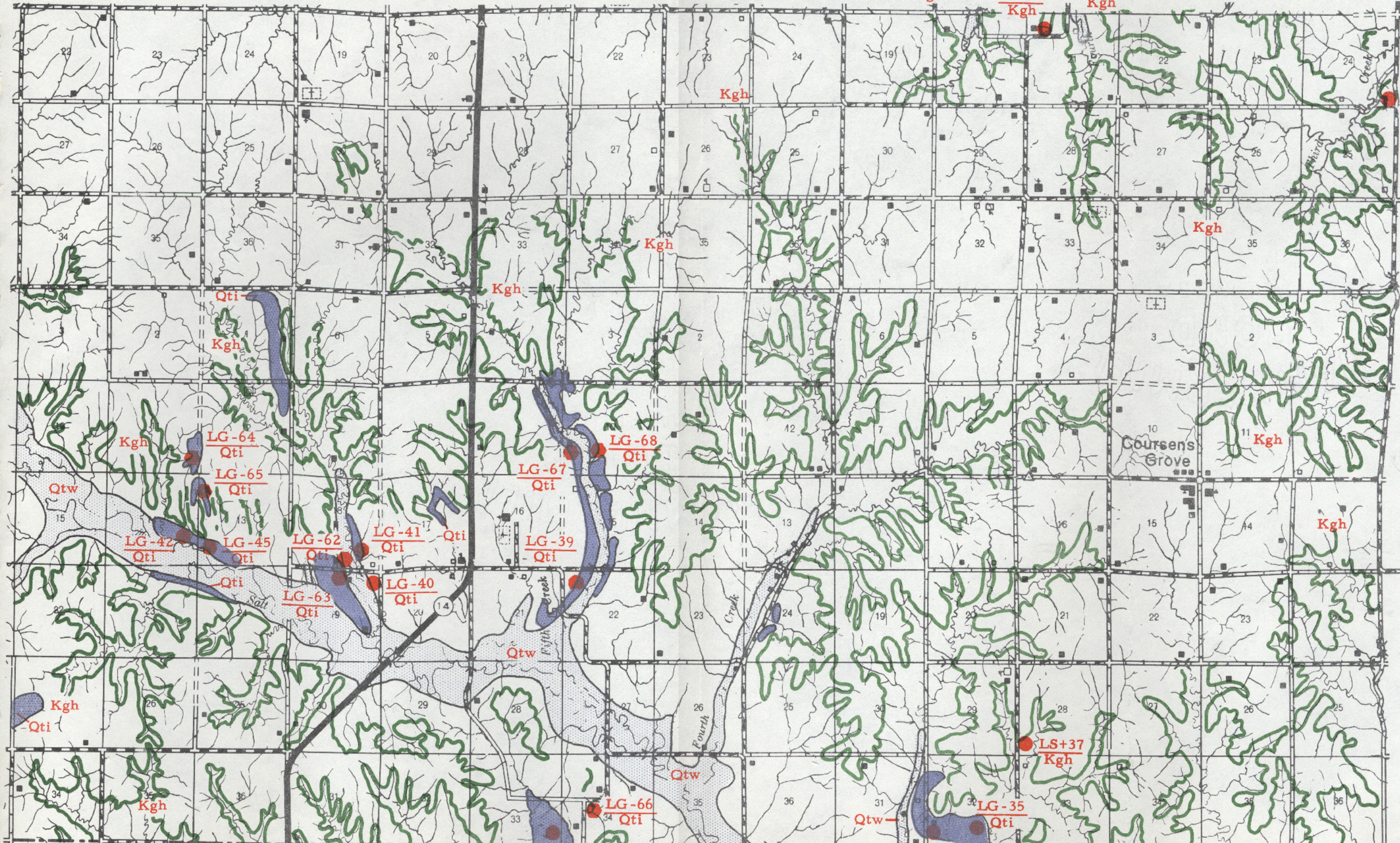

LINCOLN

COUNTY

PLATE VI